

Warbler

Summer Camp insert included!



Black-throated Gray Warbler

Spring and Summer Camp Registration begins January 10th at 8:00am

In this issue... **Natural History Trips & Tours, 2012-2013**
See insert

© Arran Edmonstone

American Kestrel © Jim Cruce

Cooper's Hawk (immature) © Scott Carpenter

RAPTOR ROAD TRIP

WINTER 2012

Immature Peregrine Falcon © Steve Halpern

Viewers at Coon Point got good looks at a Bald Eagle and some hawks. © Arran Edmonstone

Saturday, February 4th • 9 a.m. to 2 p.m.

Wildlife Care Center Open House

Sunday, February 12, Noon-4pm

What really happens behind the doors of the Wildlife Care Center? *Come to the Wildlife Care Center Open House and see for yourself!*

Wildlife veterinarians, naturalists, Education Bird handlers, and volunteers will be on hand to answer your questions and introduce you to the Wildlife Care Center when it opens its doors to you and your family.

Behind-the-scenes tours of the Wildlife Care Center. Guided tours will give you a peek at what really goes on in one of the busiest wildlife rehabilitation centers in the U.S. You'll see the hospital, food preparation area, laboratory — and maybe you'll get a glimpse of a patient!

Question-and-answer time with a wildlife veterinarian. Meet Audubon's wildlife veterinarians and try to stump them with your questions. They in turn will stump you with case studies of actual cases seen in the Care Center.

Raptor education station. At the education station in Heron Hall, experience hands-on activities to help you learn more about raptors. Compare wings and feet and other special adaptations of a variety of raptors.

continued on page 5



Rescued Barn Owl nestlings © Jenny Goetz



This Osprey doesn't seem too pleased to be getting an eye exam. © Wendy Shoemaker

Annual event celebrates birds of prey!

Explore Sauvie Island in search of the magnificent Bald Eagles, hawks, and falcons that spend the winter on the island. On this special day devoted to raptors, experienced naturalists and hawk experts will host activities and answer your questions at four locations around the island. Enjoy guided bird viewing, meet live raptors up close, and sharpen your hawk identification skills. Hot drinks and donuts are available in the morning to keep you warm while you breakfast with the birds.

How does the road trip work?

Begin at **Kruger's Farm Market** and pick up your event map and raptor identification guide. The event fee is **\$10 per vehicle, cash only**, and includes a Sauvie Island Wildlife Area parking permit.

To reach Kruger's, turn right off Highway 30 northbound at the Sauvie Island Bridge and continue straight 1.5 miles (past Howell Territorial Park) to the farm entrance on your right. Carpooling is encouraged. Spotting scopes and a crash course in raptor identification will be provided at three island viewing locations, along with naturalists to help spot the birds. Bring binoculars and field guides if you have them, and dress for the weather. This event takes place rain or shine! **The road trip is suitable for birders of all skill levels, and families are welcome**, and three

of the sites — Howell Territorial Park, Coon Point, and the Wildlife Viewing Platform — are wheelchair accessible.

While you don't have to be an 'early bird' and get up at the crack of dawn to see these birds of prey, you should allow approximately three hours to visit all four locations.

What will you see?

It all depends on what nature has in store. Frequently sighted raptor species at the three viewing stations include **Bald Eagle, American Kestrel, Red-tailed Hawk, and Northern Harrier**. With a little luck you might spot a **Peregrine Falcon, Merlin, Rough-legged Hawk, or Cooper's Hawk**. Spectacular **Sandhill Cranes, Snow Geese**, and **Great Blue Herons** are also commonly seen at this time of year. At Howell Territorial Park you are guaranteed sightings of Audubon's Education Birds as well as fun activities for all.

No registration is required. For more information, visit our website at www.audubonportland.org or call 503-292-6855 ext.119. **See Raptor Road Trip Rev Up! on page 7.**

Sponsored by Metro, Audubon Society of Portland, Oregon Department of Fish and Wildlife, and HawkWatch International.

Oregon's IBA Program Picks up 3 Global Designations

See page 11

Raptor Road Trip Rev Up! class on Feb. 1 See page 7

 Audubon Society of Portland
5151 NW Cornell Road
Portland, Oregon 97210

Inside this issue

Page 2 From the Director
Page 3 Audubon Outings
 Nature Nights
Page 4 & 5 Conservation
 Wildlife Care Center
Page 6 & 7 Trips & Tours & Classes
Page 8 Sanctuaries
Page 9 Volunteers & Field Notes
Page 10 New Members
Page 11 Important Bird Areas
Page 12 Calendar at a Glance
 Map/Hours/Sponsors

View this Warbler and past issues at www.audubonportland.org/about/newsletter.

From the Executive Director



Reflections on Dave Marshall

I am glad that I had the opportunity to know Dave Marshall. It was not too long after my start with Portland Audubon that Dave and Georgia welcomed me to their home in Lake Oswego. Even then, over a simple lunch with stunning views of Mt. Hood and the chatter of backyard birds, I sensed in a small way what made Dave so respected among his professional colleagues and loved by the larger community.

Meryl Redisch

Among the many gifts Dave contributed to Portland Audubon was his expansive library, comprised of hundreds of natural history, bird, and wildlife books and journals dating back decades. This prized possession served him well both during his auspicious career and during his time at home. Now this unmatched collection is housed at the StreamNet Library for others to use and enjoy. As much as Portland Audubon remembers Dave Marshall as its wild bird and habitat champion, countless others feel the same way. Following are reflections from a few people who knew Dave very well.



Meryl Redisch (left) with Dave Marshall (right) and wife Georgia at the Audubon Pond © Portland Audubon

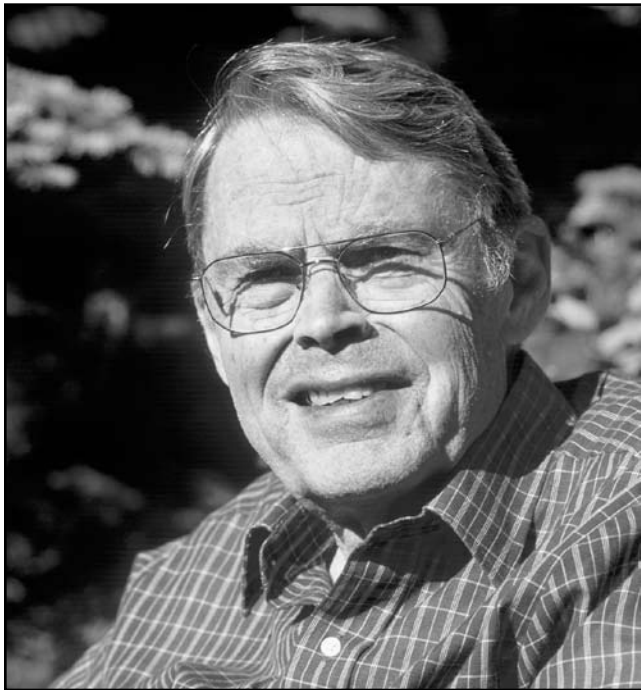

David Marshall in 2002 © John Marshall

From Lynn Herring:

I first met Dave Marshall on Sauvie Island upon his return from service as Endangered Species Act (ESA) coordinator with the Washington, DC office of U.S. Fish and Wildlife Service. That day, we talked about the many subspecies of Canada geese and the formation of the Willamette Valley National Wildlife Refuges to protect the Dusky Canada Goose. There were the many fun Birdathon trips on which Dave participated with his namesake team, the Marshall's Murrelets. One year, Jonathan Nicholas, the former *Oregonian* columnist, accompanied us and admirably referred to Dave in his column as "Ears Marshall."

One of the most special memories was a day in April 2005, when I awoke to a national news broadcast that the Ivory-billed Woodpecker had been identified in Arkansas. Dave, Georgia, and I were going to an Oregon Audubon Council meeting in Bend a few days later. Dave called. I interrupted him with uncontrolled excitement and said, "You must be calling about the Ivory-billed Woodpecker!" Dave said, "The Ivory-billed Woodpecker?" I said, "Oh, Dave, you haven't heard..." and I told him the news. He was simply silent — and then with measured words told me how much this bird had captured his imagination as a boy and then as a young biologist with the U.S. Fish and Wildlife Service. In his role as ESA coordinator, he had to make the decision not to list the species for lack of population information. He was so very, very hopeful that the bird was indeed alive within the wilds of Arkansas.

To learn more about Dave, go to audubonportland.org/news/dmo and the links following the obituary.

From Harry Nehls:

I first met David Marshall in 1960 when he became interested in some birds I reported from Northwest Portland. We spent several enjoyable hours that day in the field discussing birds and their habitats.

Over the years we often met to work on various projects. I always found his easy friendly manner and his willingness to take the time to share his knowledge and experience refreshing. When the Oregon State University Press wanted to publish a book on the "Birds of Oregon," I submitted an outline which they passed on to Dave for review. We met soon after at Audubon to discuss the book. He mentioned that they were looking for a much more detailed book and described what he and they were looking for. He was very much interested in the publication, but appeared to be reluctant to get involved. After some discussion I noted that there was only one person capable and had the contacts to edit this book and he was the one that should do it.

He did not commit himself at the meeting, but soon after he organized the co-editors and contacted others to help write the text. Over the next couple of years Dave and I worked more closely than ever to complete this work, the 700-page *Birds of Oregon: A General Reference*.

It was a pleasure to work with Dave and an honor to call him a friend. He will be missed.

From Claire Puchy:

Although I knew of Dave Marshall before 1985, it was when I became Executive Director of Portland Audubon in January of that year that I met him. From then on, Dave was both a friend and a colleague. I recall birding with Dave at Hagg Lake on a Birdathon morning in May. Dave identified 20 species before daylight... his ability to bird by ear was legendary!



Dave always enjoyed a good laugh. © Claire Puchy

Dave often told me about his family's connection with Portland Audubon. His parents were instrumental in its founding; his uncle built the pond behind Audubon House and it was dedicated to his great-grandmother, Samantha Jane Seaman; his aunt and uncle started the *Warbler* newsletter. He told me about meeting William Finley and other colorful Audubon "characters," and how birds and their habitats had changed since he was a boy. I remember Dave telling me about Yellow Warblers being a common backyard bird when he was a boy, and how he heard (and later saw) the first House Finch in Portland around 1940. He also told me that he'd had to go to Sauvie Island to see a Scrub Jay! Dave was a great man who connected us with our organization's past, and left a great legacy for the future.



Birders on bikes, from left: Dave's brother Albert, Tom McAllister, and Dave. According to Tom, this photo recalls all their birding around Portland on their bikes. Photo: Tom McAllister

From Tom McAllister:

One of our last true field naturalists left us a legacy that will last generations to come. David Marshall, through personal field experiences from boyhood onward, knew what the choices should be for wildlife and habitat diversity when he served as U.S. Fish and Wildlife Service refuge biologist for Region 1 (eight Western states) based in Portland. He surveyed, recommended, negotiated, and then defended establishment of the initial Willamette Valley refuges: William Finley, Basket Slough, and Ankeny National Wildlife Refuges. Tenasillahe Island, the largest addition to Lewis and Clark Refuge on the lower Columbia, and Ledbetter Point, added to Willapa Bay Refuge, also came about with David quietly but firmly defending through political, interagency, and federal Office of Budget and Management objections.

David's birding imprint came naturally through a pioneer family of birders and botanists and Portland Auduboners. We met in 1938 as 12-year-olds at the then-Portland Audubon Society lecture meeting held monthly in Multnomah County Central Library. That lifelong friendship began the next day on our bikes as we birded on Mt. Tabor.

In the "Hometown" chapter of the new 2011 edition of *Wild in the City*, Dave and I write about our then-unplugged freedom, with all that a youthful birder could see and hear in our hometown, plus reflections on what's passed and what's new.



Dave Marshall, boy member of Audubon, in 1938. Note the field glass case over his shoulder and Bullet camera box projecting from his pocket, and he is holding a Red-necked Phalarope. Photo: Tom McAllister

Interested in Bluebird Monitoring? The Bluebirds are Interested in You!

Prescott Bluebird Recovery Project is holding a Monitor Workshop for new volunteers on **Sat, February 25, 9:00am–Noon**, at **Champoeg State Heritage Area** in the Visitors' Center. Please make your **reservations** at email@prescottbluebird.com (send your **phone number too**, please). Check www.prescottbluebird.com for more details.



10th Annual Urban Ecology and Conservation Symposium

Presented by the Urban Ecosystem Research Consortium (UERC), the symposium focuses on urban environmental issues and the practical application of related ecological and social sciences in the Portland-Vancouver region. Events include a series of oral presentations, a poster session, raffles, and a post-symposium social.

The UERC is a consortium of people from educational institutions, nonprofit organizations, businesses, and local, state, and federal agencies who support urban ecosystem research and creating an information-sharing network to collect and use ecological data in the Portland-Vancouver region.

Friday, February 24, 2012
8:00am – 6:00pm
Portland State University, Smith Center Ballroom

Details and registration at www.uercportland.org.

Keynote Speakers:

Steve Whitney of the Bullitt Foundation with "Urban Research and the Future of Cascadia: Perspectives from a Funder's Perch" and

Jim LaBonte of the Oregon Department of Agriculture: "The Undiscovered Country of Urban Invertebrates"

Audubon Outings — Wild in the City and Beyond

Bring binoculars and dress for the weather — beginners welcome!



= Birding trips starting later, going slower, with restrooms in sight



= Sign-up needed



= Fee involved

January 7 (Sat), 7:30am–5pm Netarts Bay & Cape Meares

Join **Marsh Sly** for a trip to Netarts Bay, Oceanside, and Cape Meares. Meet at the McDonalds in North Plains (Exit 57) at 7:30am, or at the Tillamook Safeway (NW corner of parking lot) at 9:30am. Bring a lunch and water. For information contact Marsh at 503-201-8119 or marshandsharon@aol.com.

January 11 (Wed), 9am–11am Summer Lake Park

Join us as leader **Sue Carr** takes us for a look at the wintering waterfowl in this wonderful suburban park! Take SW Scholls Ferry Rd to 130th Ave. Follow the road around to the left (to Winterlake Dr) to the parking area on the left. For information call Sue at 503-649-3360.

January 14 (Sat), 7am–5pm A Day on the Lincoln County Coast

Join **Tim Shelmerdine** for a day exploring coastal Lincoln County. We'll look for alcids, loons, and other seabirds at Boiler Bay, check for turnstones and "rockpipers" at Depoe Bay, then spend most of the day around Newport and Yaquina Bay. We go rain or shine, so bring rain gear and warm clothes, binoculars (and scope if you have one), and a sack lunch. Please plan to carpool. Meet at 7am at Lamb's Thriftway parking lot in Wilsonville. From Portland southbound: I-5 to Exit 283 (2nd Wilsonville exit). Left at the stop light onto Wilsonville Rd, then left just after the Taco Bell into the shopping center. Call Tim (971-221-2534) with questions.

January 19 (Thu), 8am–10am Tualatin River NWR

This mostly level walk along wetlands and through oak savanna and riparian forest begins near the refuge's Wildlife Center off Hwy 99W, between King City and Sherwood (look for brown signs). There is no limit of participants, so join us at this 'urban' National Wildlife Refuge.

January 24 (Tue), 9am–4pm Newport Area

Join **Dick Demarest** and **Don Stein** for a full day of birding around Newport. We'll visit Yaquina Bay, the South Jetty, Seal Rocks, and the new Beaver Creek Natural area looking for wintering waterfowl, gulls, and rockpipers. Meet at the Hatfield Marine Science Center parking lot at 9am. Limited to 16 people, and **registration is required** — please contact Dick at 503-407-7912 or rdd@demarests.com.

January 28 (Sat), 8am–11am Oaks to Wetland Trail, Ridgefield NWR

Join us for a walk on the Oaks to Wetland Trail looking for winter sparrows and waterfowl. The trail can be muddy so bring appropriate hiking shoes. Meet at the trailhead parking lot on the Carty Unit located one mile north of the intersection of Pioneer and Main Sts in downtown Ridgefield, WA. Questions? Call **Ron Escano** (503-771-3454).

February 11 (Sat), 7am–5pm Tillamook County

Join **Tim Shelmerdine** and **David Smith** on their late-winter trip to Tillamook County. While we never know just what might show up, we expect lots of waterfowl, gulls, and raptors, and may work on identifying some of those "LBJs" (Little Brown Jobs, also known as sparrows). We'll choose our exact destination based on condition and reports. Meet at 7am at North Plains Chevron (10025 NW Glencoe Rd). West of Portland on Hwy 26 about 16 miles, take North Plains Exit 57 and turn right on Glencoe Rd. The Chevron is on the left just past McDonalds. Please plan to carpool. Pack a lunch and snacks. If questions, call Tim (971-221-2534) or David (503-296-6067).

February 12 (Sun), 8am–11am Crystal Springs

Join leader **Ron Escano** to view the local wintering waterfowl at Crystal Springs Rhododendron Garden. Here's a chance to learn your waterfowl, with close views of most Portland-area ducks. We'll learn how to ID waterfowl using black & white field marks. Meet at the Crystal Springs parking lot across SE 28th from Reed College. The lot can be reached from Holgate (turn south on 28th) or Woodstock (turn north on 28th). Call Ron (503-771-3454) if questions.

February 18 (Sat), 9am–Noon Oaks Bottom

Join leaders **Patty Newland** and **Candace Larson** for a bird walk around Oaks Bottom Wildlife Refuge in SE Portland. We'll explore wetlands and woodlands, talk about the history of this amazing urban wild space, and look for resident songbirds and wintering waterfowl. Meet at the Sellwood Park parking lot on SE 7th Ave at Malden St at 9am sharp. Expect to walk 2–3 miles on both paved and uneven dirt trails.

February 23 (Thu), 8am–4:30pm Baskett Slough & Ankeny NWRs

This is a good time of year to see migrating waterfowl and raptors in the Willamette Valley. Join **Denny Graham** at the NW corner of the WalMart parking lot in Woodburn at 8am for a trip to these two National Wildlife Refuges. Bring lunch and a scope if you have one. We'll arrange carpools at WalMart, and plan to return there at 4:30pm. From Portland southbound: I-5 to Woodburn Exit 271; turn left across I-5 and look for WalMart SE of the exit. **Registration is required** — contact Denny at 503-659-1245.

February 25 (Sat), 8am–11am Vancouver Lake Park

Join leader **Ron Escano** at Vancouver Lake Park. We'll scope the lake for water birds, then explore the riparian woodland for wintering songbirds, including the White-throated Sparrow. From Portland northbound: I-5 to Exit 1-D (4th Plain Blvd), west on 4th Plain through Vancouver onto SR-501 (Lower River Rd). After 3.5 miles on SR-501, continue straight for 0.6 miles to Vancouver Lake Park; possible \$2 fee. Call Ron (503-771-3454) if questions.

February 25 (Sat), 9am–11am Birding along the Gresham-Fairview Trail

Join Audubon Society of Portland's **Steve Engel**, **Bob Sallinger**, and **Bich Trinh**, and City of Gresham's **Laura Guderyahn** for a morning bird walk along segments of the Gresham-Fairview Trail in West Gresham. **Please RSVP to btrinh@audubonportland.org or leave a message at 971-222-6139.**

NATURE NIGHTS

Second Tuesday of the month from September to May. If you have a suggestion for a Nature Night presentation, contact Pam Meyers at pmeyers@audubonportland.org or 503-292-6855 ext. 130.

FREE and open to the public!

Caspian Terns of East Sand Island Managing Seabirds in an Important Bird Area with Dan Roby

Tuesday, January 10
7pm, Heron Hall

Located near the mouth of the Columbia River, East Sand Island is the site of the world's largest Caspian Tern colony, as well as the largest known Double-crested Cormorant colony in western North America. In addition to these dominant seabirds, important roosting, nesting, or migrating numbers of Brown Pelicans, Brandt's Cormorants, several gull species, loons, grebes, raptors, waterfowl, and songbirds help make this an Important Bird Area (IBA).

Hear biologist **Dan Roby** discuss the challenges of managing this IBA to protect the birds while working to reduce the seabirds' impact on the survival of salmon and steelhead from throughout the Columbia Basin.



Dan with Ancient Murrelet and Cassin's Auklet. © Ian Jones

From the effects of oil spills and climate change to seabird/fisheries interactions, Dr. Roby has conducted research on the ecology of seabirds for over 25 years. He has worked in Alaska, Hawaii, Greenland, Newfoundland, South Georgia, and Antarctica, as well as throughout the Pacific Northwest. He received a BA in Biology from Antioch College, an MS from the University of Alaska Fairbanks, and his PhD from the University of Pennsylvania.

Dan is currently the Unit Leader–Wildlife at the U.S. Geological Survey's Oregon Cooperative Fish and Wildlife Research Unit, and Professor of Wildlife Ecology in the Department of Fisheries and Wildlife at Oregon State University. He served as Chair of the Pacific Seabird Group during 2004–2006, and was elected a Fellow of the American Ornithologists' Union in 2008.

Please join us for this entertaining, informative, and thought-provoking presentation!

Oil and Water Behind the Scenes of the PDX 2 Gulf Coast Project with Steve Duin, Shannon Wheeler & Mike Rosen

Tuesday, February 14
7pm, Heron Hall

Join us for an evening behind the scenes of the "PDX 2 Gulf Coast" project. Through photos, music and video, **Steve Duin** and **Shannon Wheeler**, author and artist of *Oil and Water*, and **Mike Rosen**, PDX 2 Gulf Coast organizer, will tell the story behind the creation of the graphic novel, share personal stories of what they witnessed in the aftermath of the BP oil spill, describe other products that came out of the project, and answer questions.

Steve Duin is the Metro columnist for *The Oregonian* and the author/co-author of six books, including *Comics: Between the Panels*, a history of comics, and *Father Time*, a collection of his columns on family and fatherhood. He has twice been named the nation's best local columnist by the Society of Professional Journalists, and lives with his wife, Nancy, in Lake Oswego.

Shannon Wheeler is the Eisner Award-winning creator of *Too Much Coffee Man* and has appeared internationally in newspapers, magazines, comic books, and opera houses. He has contributed to a variety of publications that include *The Onion* newspaper and *The New Yorker* magazine. Wheeler lives in Portland, OR with his cats, chickens, bees, girlfriend, and children. He publishes a comic every day at tmcm.com.

Mike Rosen holds a PhD in Environmental Science and Engineering from OHSU and a BA in Chemistry from Harpur College at the State University of New York. He has worked to promote a clean environment and healthy watershed for over 20 years, from managing solid waste and contaminated sediment for the Oregon DEQ (culminating in developing Portland Harbor's Superfund Cleanup Program) to his current role managing the Watershed Division for Portland's BES. During August 2010, Mike led a group of 22 Oregonians — community organizers, environmentalists, teachers, students, artists, writers, news reporters, and business owners — to the Gulf Coast to "bear witness" to the BP oil spill.

This will be a rewarding evening as Mike, Steve, and Shannon present their stories with compassion and humor. After the presentation, they'll be available to sign books purchased in the Nature Store.



Conservation

West Hayden Island Update

by Bob Sallinger, Conservation Director

It has been nearly 14 years since the Port of Portland ('the Port') initiated efforts to annex and rezone West Hayden Island to allow its forests, wetlands, grasslands, and shallow water salmon habitat to be converted for marine industrial development. Some have suggested that the Port's failure to date to overcome public challenges to its development aspirations somehow represents a failure of public process. In fact just the opposite is true. Despite two multi-year annexation processes costing millions of public dollars and a small army of public relations staff and development consultants, the Port has never provided the community with real answers to legitimate social, economic, and environmental concerns. Instead the Port has twice used the public process as an exercise in issue avoidance — steamrolling opposition and manipulating data to support its desired outcomes. Given the Port's failure to date to address real concerns about the environmental, social, and economic impacts of this proposed development, a decision not to annex and rezone West Hayden Island is the only reasonable outcome of these processes: the Port simply has not made the case.

Audubon was not alone in its concerns regarding the prior public processes. At the conclusion of the 1999–2000 annexation process the *Portland Business Journal* wrote:

"We are not convinced that the plan to develop the island acreage shouldn't be permanently scrapped, but at least by putting it on the shelf for a while, it can be given further study from cost-benefit and environmental standpoints."

— *Portland Business Journal*, December 17, 2000

At the conclusion of the 2009–2010 annexation process, the *Portland Tribune*, which reviewed hundreds of internal city emails obtained through a public records request, called out the City and Port for a "curiously close relationship between a developer and the city bureau which must review its development proposal," and for "squelching" unfavorable findings. The *Tribune* wrote that a "messy process clouds West Hayden Island process" and that a "review of records shows questionable activities behind the scenes." (*Portland Tribune*, March 3, 2011)

In 2011 the City and Port convened a third advisory group to consider annexation and rezoning of West Hayden Island. Twelve months into an 18-month-long process we are cautiously pleased to report that things appear to have changed for the better: for the first time in nearly a decade and a half the City appears to be serious about investigating concerns raised by the community. Mayor Adams has directed the committee to explore a division of the island that would allow for 300 acres of development and 500 acres of natural area. While Audubon opposes development on any of West Hayden Island, we give the Mayor credit for putting a clear proposal on the table for consideration — something the Port has never been willing to do. The City also appears to have finally resolved the blatant conflict of interest that was created by having the Port manage its own annexation and zoning process. The City alone appears to be managing the current process. Finally and most importantly, the City appears to be allowing independent and credible consultants to evaluate many of the issues that have been avoided over the past 14 years.

The changes are already apparent in the information that is emerging. Many of the concerns that the Audubon Society of Portland has been raising since the mid-1990s have now been validated. For example:

- The consultants have confirmed and the Port has conceded that a viable Port facility including a loop track, three terminals, and all supporting infrastructure will fit into 300 acres. In 1999 the Port argued that it needed at least 600 acres and as recently as 2010 the Port insisted that 450–550 acres was the bare minimum that would allow for a viable facility.
- The City has verified that the cottonwood forest on Hayden Island (one of the largest tracts of intact cottonwood bottomland forest on the Lower Columbia), which the Port has long argued is dying out, is in fact regenerating and much healthier than previously acknowledged.



West Hayden Island cottonwood forest. The current process has verified that the forest is regenerating and far healthier than determined in prior processes. © Bob Sallinger

- The City has verified that the hundreds of acres of grasslands on West Hayden Island which the Port has long argued have no ecological value in fact are currently providing habitat for several at-risk species and has designated this area as a "special habitat area."

There is still a long way to go. Difficult issues such as the cost/benefit analysis, community impacts, and mitigation strategies lie ahead. At a recent joint hearing between the Port Commission and City Council on West Hayden Island, a couple of Port Commissioners were openly disparaging of the public process. Also, several candidates for City Council have already indicated support for development on West Hayden Island — without any regard for the fact that significant questions remain unanswered. Finally, we have seen the Port successfully pressure Oregon Department of Fish and Wildlife into abandoning a recommendation that no development occur on West Hayden Island.

If unfavorable information continues to emerge, the pressure to short circuit the public process will undoubtedly increase. It is critical that the public continue to remind both the current City Council and potential new council members that the issues that have been raised by conservation groups and the local community are real and deserve a fair, transparent, and credible review. This project will have tremendous environmental and community impacts and public costs — and the people of Portland deserve better than the fake public process that has dogged this effort for more than a decade.

For ongoing information about West Hayden Island, go to our Save West Hayden Island Facebook page.

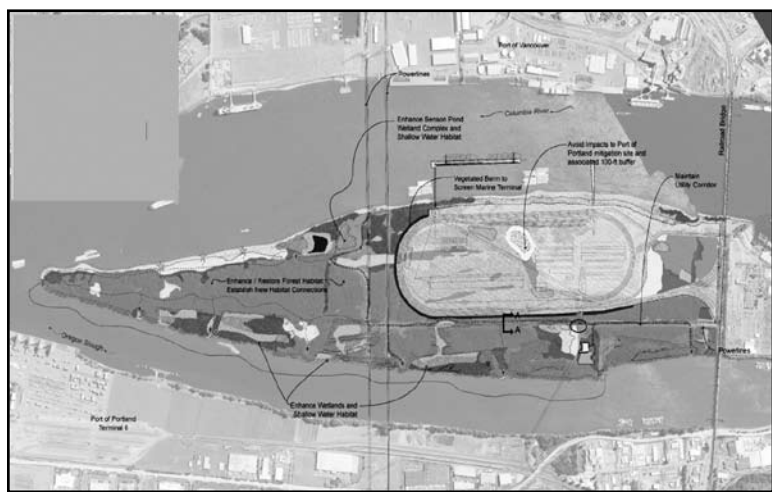

Potential West Hayden Island development concept. Large light oval area at top of island represents potential development footprint. Image: City of Portland

West Hayden Island Development Impacts

The currently proposed preferred development option would have the following direct impacts:

- Loss of 141.3 acres of cottonwood forest, the largest intact stand on the island
- Loss of 137.7 acres of grassland
- Loss of 1.1 acres of shallow water salmon habitat
- Loss of 13 acres of wetlands
- Loss of 5 acres of shrub land
- Loss of 278 acres of floodplain
- Loss of habitat for the following at-risk species found within the development area: Bald Eagle, Western Meadowlark, White-breasted Nuthatch, Willow Flycatcher, Purple Martin,

Bufflehead, Pileated Woodpecker, Red-legged Frog, Chinook Salmon, Coho Salmon, Chum Salmon, Steelhead Trout, Cutthroat Trout, California Myotis, Hoary Bat, Long-legged Myotis, Silver-haired Bat, Yuma Myotis

- Nearly 250 wildlife species have been identified on or in the waters surrounding West Hayden Island, including nearly 150 bird species, making it one of the most species-rich habitat areas in the Portland area. The loss of habitat size and complexity and the addition of significant disturbance factors will impact many of these species in addition to the at-risk species listed above.



Mayor Sam Adams Creating an Oasis of Urban Habitat

by Nikkie West, Conservation Program Assistant

On November 12th, the Backyard Habitat Certification Program (BHCP) presented Portland Mayor Sam Adams with a site design to transform his yard into certified habitat for birds, insects, and other wildlife. The design was prepared by Backyard Habitat experts Marina Wynton of Olivine & Associates and Elizabeth Cardinal of Superwonderful Garden Design. Both local businesses have values that are strongly aligned with the BHCP and have provided ongoing support to the program.

Adams enthusiastically accepted the design plan, which features a diverse selection of lower Willamette Valley natives including Red Elderberry, Mock Orange, Red-flowering Current, Spiraea, Evergreen Huckleberry, and several herbaceous groundcovers. Landscape contractors



set to work almost immediately, removing invasive species like the massive Pokeweed plant in Adams' front yard! With the weeds under control, contractors amended the soil with compost and installed small trees, shrubs, and ferns. Stay tuned for Adam's certification after herbaceous plants are installed in spring 2012.



After installation — and more work planned. © Gaylen Beatty, Columbia Land Trust

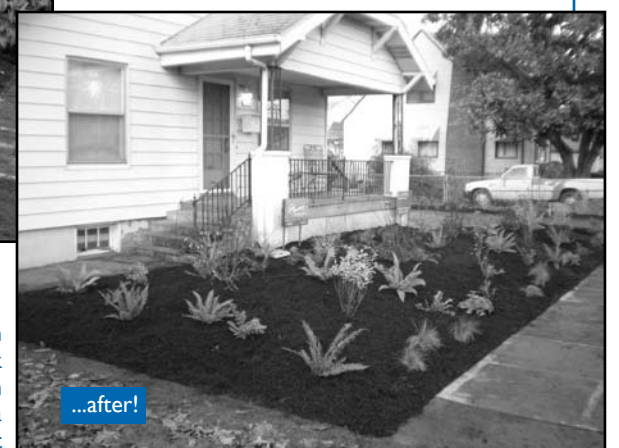

To see more photos of the mayor's certification in progress, become a fan of the Backyard Habitat Certification Program's Facebook page. For information about the program, contact us at 503-292-6855 ext.126 or audubonportland.org/backyardwildlife/backyardhabitat.

**Wednesday, February 22
at Leach Manor House**

6704 SE 122nd Ave, Portland 97236
(Please RSVP to btrinh@audubonportland.org or leave a message at 971-222-6139)

**6:30pm–7:10pm: Backyard Birds
with Cathy Schar**

Photos and sounds of about 25 common backyard birds in the Portland area will be featured, including resident and migratory species from Anna's Hummingbirds to Scrub Jays.

**7:15pm–8pm: Backyard Habitat
Certification Program**

Audubon Society of Portland and Johnson Creek Watershed Council will give a presentation on why and how you could participate in this program.



Deb Sheaffer, Wildlife Care Center Staff Veterinarian, thoroughly examines the injured bobcat. ©WCC

Injured Bobcat from Cedar Mill Released Back to the Wilds of Forest Park

by Debbie Daniels and Bob Sallinger, Audubon Staff

Most people are surprised to learn that bobcats still roam the wilds of Portland. These solitary and elusive cats are shy and are active primarily at night. Their presence is most often announced by the discovery of their tracks or scat, or sadly when the occasional carcass shows up on one of our forested roadways. Over the past 15 years at least a half dozen bobcats that were hit along the roads that run through Forest Park have been brought to our Wildlife Care Center.

In early December we received a rarity — a live, hissing, snarling bobcat — one that we could actually help. It had been hit by a car near Cedar Mill and was initially treated at the Bethany Family Pet Clinic, where Dr. Norman gave the still-stunned animal an examination and medication to reduce pain. By the time the bobcat arrived at our Care Center, she was fully awake and far less accommodating of her human benefactors. After years of seeing only the remains of bobcats, it was a thrill for staff and volunteers to have the opportunity to work on this reluctant guest! She was sedated and given a full exam and x-rays. Happily, her injuries were relatively minor: a chipped tooth and a few bruises.

Bobcats are only about twice the size of housecats (females average less than 15 pounds and males average 21 pounds). They have tan fur with dark spotting, a short (“bobbed”) tail, and tufted ears. Rabbits and rodents make up over 70% of their diet, with the remainder including ground-nesting birds and bird eggs, insects, snakes, frogs, crustaceans, and occasionally carrion. Because they primarily eat rabbits, mice, and rats, they help control the populations of these animals. Bobcats are found throughout North America, primarily in forests, although they can also be found everywhere from swamps to deserts. They are territorial and mark their territory by scratching on trees and stumps. Human conflicts with bobcats are very rare. However, along with coyotes and foxes, they will take the occasional free-roaming cat — another reason to keep cats indoors, especially at night.

We were able to release the injured bobcat just two days after she arrived at our center. She bolted from the cage and disappeared into the night. Keep your eyes peeled the next time you are driving through Forest Park at night; you might just catch a glimpse of one of these amazing creatures... and hopefully give them time to see you as well.

**2006 Bond Measure Progress Report:
Nature in Neighborhoods
Capital Grant**

by Jim Labbe and Bich Trinh, Audubon Staff

In the last issue of the *Warbler* we updated readers on the 2006 Regional Natural Areas Bond Measure's regional share fund, which raised \$168.4 million to protect the most ecologically important natural resources in the region. In this issue we focus on the \$15 million “Nature in Neighborhoods” (NIN) capital grant program, a new bond feature envisioned as a way to capture unforeseen opportunities and improve access to nature where it is needed most.

A growing body of scientific literature suggests that access to nature has positive affects on the body, mind, and spirit, particularly for young children. Having nature nearby is also a core value of the region's residents and a foundation for our unique culture of environmental stewardship. However, in 2005 the Regional Equity Atlas (www.equityatlas.org) documented that many people in the region lack a minimum level of access to nature. Only about half the region's residents live within a quarter-mile walking distance of a public park and about a third live beyond a quarter-mile linear distance of a natural area. Moreover, the atlas found that populations with worse access tend to be higher poverty and have higher percent people of color. In response to these findings and the urgings of Audubon Society of Portland and environmental justice advocates, the Metro Council prioritized a portion of the \$15 million capital grant program specifically to projects in nature-deficient, low-income neighborhoods. The NIN capital grant program also gives priority to capital projects that propose innovative designs for integrating ecological functions into the urban landscape.

As of September 2011, the Nature in Neighborhoods capital grant program funded 18 projects totaling \$4.7 million or about 30% of available funds. Below are some examples of NIN capital grant projects that are helping expand access to nature in neighborhoods that are deficient in parks and natural areas.

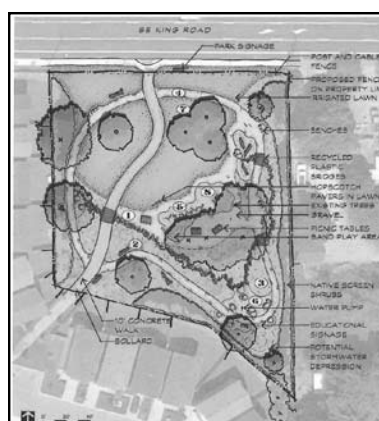

Hawthorne Grove Park will be constructed in 2012 with adjacent affordable housing in park-deficient Southgate Neighborhood, North Clackamas County. Image: Harper Houf Peterson Righellis Inc.

Hawthorne Grove Park project in Northern Clackamas County received \$140,000 NIN capital grant funding to construct a new, small neighborhood park in the park-deficient, low-income Southgate neighborhood.

The new park is due to be constructed in 2012 with adjacent affordable housing, thereby ensuring the low-income residents will benefit in perpetuity. Active participation from diverse partners — including developers, residents, and an affordable housing provider — will keep the community directly involved in caring for their park in the future.

The NIN capital grant program also provided \$158,000 to purchase four parcels totaling one acre within the Baltimore Woods corridor in North Portland. This acquisition will protect rare native oak trees and enhance the nature experience for bicyclists, walkers, and joggers who will someday use this section of the Willamette River Greenway Trail envisioned along the adjacent street. These parcels are part of a larger natural-area corridor connecting Cathedral and Pier Parks. Active participation from city agencies, land trusts, nonprofit organizations, and the Friends of Baltimore Woods will involve the community in restoration and long-term stewardship.

In 2009 \$220,000 in NIN capital grant funds matched \$443,000 in landowner donation and funding from East Multnomah Soil and Water Conservation District in order to acquire 2 acres of public parkland along NE Glisan in West Gresham. The acquisition eventually expanded access to Nadaka Nature Park in February of 2011, allowing residents from Rockwood to better access the park. The new access increased the number of children served within a quarter-mile walking distance by 146% and the number of people of color served within a quarter mile by a whopping 214%! Now the nature park serves an estimated 4,600 people living within one-half mile walking distance. More recently Audubon Society of Portland has joined forces with local churches and community groups to develop the 2 acres into a nature-based neighborhood park with a community garden, natural meadow, rain garden, ecolawn, and walking pathways (see July/August 2011 *Warbler*, online at audubonportland.org/about/newsletter).

These are only a few examples of NIN capital grant projects that are helping improve access to nature in our region where it is needed most. Audubon Society of Portland will remain active in helping develop viable projects that advance this goal while creatively integrating nature into the urban landscape.



Land acquisition funded by the NIN capital grant program put Nadaka Nature Park within a quarter-mile walking distance for 650 Rockwood Neighborhood residents. The nature park now provides one-quarter-mile access for over 3,400 people — about a third of them children and over half people of color — in West Gresham. © Lee Dayfield

Wildlife Care Center



Seven of the eight Education Birds pose with handlers (not pictured: Lillie the American Kestrel female). ©Tom Schmid

Wildlife Care Center Open House

continued from cover

Kid's Reveling in Raptors Art Show. Art supplies will be provided for kids to draw their favorite raptors. The pictures will all be displayed in the Wildlife Care Center!

Meet our resident raptors. All of Audubon's resident Education Birds will be out on our sanctuary grounds. Experienced bird handlers will be available to tell you each bird's story and answer questions about them.

Portland Audubon's Wildlife Care Center is the oldest and largest wildlife rehabilitation center in Oregon. Over 3,000 injured or orphaned native wild animals come through the doors and over 15,000 wildlife calls are fielded each year. Come see where it all happens — join us for the Wildlife Care Center Open House on February 12.

Educational Trips

A portion of your fee is a tax-deductible donation to the Audubon Society of Portland. View more International and Domestic trips at www.audubonportland.org/trips-classes-camps/adult.

Portland Audubon's International Tours now include a Carbon Offset contribution that will go directly for the stewardship of our 150-acre Forest Park Wildlife Sanctuary. A flat fee of \$50 per person is included in the cost of these tours and will be used to maintain our trails, plant trees to help grow our native canopy, and sustain this special place for future generations. Thank you.

These trips are popular. We recommend that you book early. Trip deposit required to secure your place on the trip.

SOUTH FLORIDA

4 spaces remain!

April 6–13, 2012

Travel the beautiful Gulf Coast of Southern Florida with Portland Audubon and discover why this region is a known as a Mecca for Birders. We'll visit such sites as **Ding Darling NWR** where we have a good chance of seeing the **Mangrove Cuckoo**; the **Archbold Biological Station** where we hope to spot the elusive **Florida Scrub Jay**; and the **Three Lakes Wildlife Management Area** where **Snail Kite**, **Crested Caracara**, and **Whooping Cranes** are all possibilities. We'll also have rare access to one of the most exclusive birding spots in the region, **Stormwater Treatment Area 5**, whose shallow-water marshes attract many species of nesting wading birds such as **Wood Storks**, **Little Blue Herons**, and **Roseate Spoonbills**. Other highlights include **Corkscrew Swamp**, which is famous for its miles of boardwalk that wind through quintessential Everglades and is home to myriad species of birds large and small.



Roseate Spoonbill. Photo: NASA

We will be based out of **one hotel** in Ft. Meyers for the entire week, eliminating the need to pack up in the mornings. And we'll go at a nice, easy pace to ensure everyone gets good looks at the birds we encounter, so whether you're a beginner or an advanced birder, this trip is sure to satisfy your appetite. You'll also have a little free time to enjoy a warm afternoon or evening stroll on a Florida beach, and to dine in some of the area's best-known restaurants that are famous, of course, for their delicious seafood.

Fee: \$1595 members / \$1795 non-members; **Deposit:** \$500 required to secure your place
Group size: 14 participants plus 2 leaders
Leaders: Steve Robertson, Education Director, and local guides

Fee includes all lodging based on double occupancy, ground transportation, all meals *except dinners*, and all guide fees, park fees, and planned group activities. **Not included:** Airfare to & from Florida, dinners, and tips for guides.

BIRDING THE DRY TORTUGAS

April 13–17, 2012

For most birders, the **Dry Tortugas** is one of those enigmatic destinations that they only dream of visiting. Well, that dream can come true for you if you hop on board this first-ever trip with Portland Audubon to these unique islands.



Fort Jefferson in the Dry Tortugas. Photo: National Park Service

The Dry Tortugas N.P. is perhaps the most remote National Park in the U.S., and can only be accessed by boat or sea plane. We'll use the former as we get on board the 105-foot **Florida Fish Finder**, a converted "Swiftship Crewboat" with the cozy capacity to sleep 36. The boat will become our home and base of operations on this 3-day birding excursion, and it will dock at **Garden Key** where we'll head to shore to bird the fascinating **Fort Jefferson**. This massive structure was built in the early 1800s to protect America's shipping lanes. The islands are home to thousands of nesting seabirds such as **Masked Boobies** and **Magnificent Frigatebirds**. But these are just the beginning. The islands are famous for their phenomenon of "Spring Fallout" that typically occurs throughout April. This is when migrating neotropical birds flying north from their wintering grounds "fall" out of the sky to rest on the first bit of land they've seen since leaving Mexico or Central America. A host of eastern warblers such as the **Tennessee**, **Blue-winged**, and **Cape May Warblers** are all possibilities, to name just a few, as well as **Indigo and Painted Buntings**.

We'll spend our last night of the trip in **Key West**, an experience in and of itself. We'll return in time for you to explore this unique town and dine at one of its famous seafood restaurants before flying out the next morning.

Note: This trip can be taken either **BY ITSELF** or as an extension to the South Florida Trip.

Fee: \$1355 members / \$1555 non-members; **Deposit:** \$500 required to secure your place
Group size: 14 participants plus leaders
Leaders: Steve Robertson, Education Director, and local guides

Fee includes lodging on both the boat and land hotel based on double occupancy, all ground and sea transportation, all meals *except dinners on land*, and all guide fees, park fees, and planned group activities. **Not included:** Airfare to & from Florida and tips for guides.

Florida & Dry Tortugas: Contact **Steve Robertson** at 503-292-6855 ext.118 or srobertson@audubonportland.org.

New Zealand

Join Audubon on our first land-based excursion to **New Zealand!** Tentative dates are November 16–30, 2012. Contact Steve Engel for more information.

BIRDING MAINE

June 3–14, 2012

5 spaces remain!

Maine is well known for its abundant natural beauty — from the rugged Atlantic coastline to ancient forested mountains. It also holds a wealth of wildlife that we'll search for as we travel from the **White Mountains** of New Hampshire to the border of Maritime Canada.

We begin in Portland, Maine, where we visit the still-wild wetlands of **Scarborough Marsh** and Casco Bay, home to **Glossy Ibis**, **Little Blue Heron**, and the shy and retiring **Saltmarsh and Nelson's Sparrows**. Then we go in search of **Boreal Chickadee** and **Bicknell's Thrush** in the White Mountains with two days of birding Mt. Washington. Next it's on to the rock-bound coast and soaring granite cliffs of the Bar Harbor area, from where we explore the woodlands of **Acadia National Park** in search of **Acadian Flycatcher**, **Chestnut-sided Warbler**, and **Scarlet Tanager**, to name a few of the songbirds we are sure to encounter.



Razorbill. Photo: Steve Garvie

A highlight of our trip will be a short boat ride to visit **Machias Seal Island** where nesting colonies of **Atlantic Puffin** and **Razorbill** offer up-close viewing. En route to the island we may encounter **Greater Shearwater** and **Wilson's Storm-Petrel**, pelagic species from the southern hemisphere that "winter" in the area, as well as northern breeders such as **Black Guillemot**, **Northern Gannet**, and **Common Eider**.

Fee: \$2195 members / \$2495 non-members; **Deposit:** \$1100 required to secure your place
Group size: 14 participants; **Leaders:** Dan van den Broek and Don Cogswell

Fee includes all ground transportation, 10 nights lodging based on double occupancy, all meals *except dinners*, entrance fees, excursions, and the services of your experienced leaders. **Not included:** Airfare to & from Maine and dinners.

ARGENTINA!

November 2–16, 2012

(in-country dates: Nov. 3–15)



Speckled Tyrant © Dan van den Broek

Come with Portland Audubon on an incredible adventure to Argentina and the remote and wild regions of Patagonia, the Pampas, and Tierra del Fuego. The trip begins in Buenos Aires where we board an internal flight to the southernmost city in the world, **Ushuaia**. There we'll bird the historic **Beagle Channel** for seabirds including the **Black-browed Albatross**, **Northern Giant Petrel**, **Magellanic Penguin** and, with luck, the sub-Antarctic **Gentoo Penguin**. In the nearby Southern Beech Forest of **Tierra del Fuego National Park** we'll search for the spectacular **Magellanic Woodpecker**.

From our base in Patagonia we'll travel high into the Andes to **Los Glaciares National Park**, where the famous **Perito Moreno Glacier** calves off huge icebergs into **Lake Argentino** with a roar of white thunder. We may see the giant **Andean Condor** soaring overhead and find **Magellanic Plover** along the lake shore. Other highlights of the area include **Lesser Rhea**, **Chilean Flamingoes**, and the endangered **Hooded Grebe**.

On the wild **Valdez Peninsula** we'll visit a breeding colony of **Magellanic Penguins** at home in their odd subterranean burrows. Out to sea, we'll have the opportunity to see the endangered **Southern Right Whale**, look for **Southern Elephant Seals**, and may even encounter a pod of **Orcas** hunting in the shallow coastal waters. We end our trip in **Buenos Aires** where we will have two days to bird and explore some of the coastal wetlands and nearby pampas, as well as a day to explore this fascinating global city.

Fee: \$4845 members / \$5145 non-members
Group size: 14 participants; **Leaders:** Dan van den Broek, Meryl Redisch, local guides

Fee includes all ground transportation, all lodging based on double occupancy, all meals *except dinners*, entrance fees, excursions, and the services of your experienced leaders. **Not included:** Airfare to & from Portland, flights within Argentina, dinners, and tips for guides.

IGUAZU FALLS EXTENSION

November 16–19, 2012

Then come with us to world-famous **Iguazu Falls**, over 200 feet in height. The surrounding jungle is home to tropical birds such as the **Toco Toucan**, **Saffron Toucanet**, and so many **mannikins** that your head will spin!

Tentative Fee: \$1195
Fee includes all ground transportation, 3 nights lodging based on double occupancy, all meals *except dinners*, entrance fees, excursions, and the services of your experienced leaders. **Not included:** Round-trip airfare Buenos Aires–Iguazu and dinners.

Maine & Argentina/Iguazu Falls: Contact **Dan van den Broek** at 971-222-6105 or dvandenbroek@audubonportland.org.

HOW TO REGISTER Choose one of 3 ways to register for Adult Classes:

1. Register and pay online: Visit class description at www.audubonportland.org/trips-classes-camps/adult and follow registration link.

OR: Contact Steve Engel via phone or email to be put on the roster. If class has limited enrollment, wait for confirmation and then...

2. Mail in your check: make payable to Audubon Society of Portland. Include with payment: class name, your name(s) and, if this is your first class with us, your full contact information.

3. Credit card payment: Call Steve Engel (971-222-6119) or our Nature Store (503-292-WILD) to pay over phone. We accept VISA, MasterCard, and Discover (3% fee charged).

Contact Steve Engel, Adult Education Manager, at sengel@audubonportland.org or 971-222-6119.

Raptor Road Trip Rev Up!

February 1 (Wed), 7pm-9pm in Heron Hall

Join Portland Audubon's Adult Education Programs Manager, Steve Engel, for an introduction to identifying birds of prey. We'll learn the key field marks for all the local wintering raptors, and make side-by-side comparisons of similar species.

A great way to prepare yourself for the Raptor Road Trip extravaganza sponsored by Portland Audubon, Metro, and Oregon Dept. of Fish and Wildlife on the following Saturday (Feb. 4) at Sauvie Island.

Fee: \$10 members / \$15 non-members

Pre-registration required — free to active volunteers!



Rough-legged Hawk
© Jim Cruce

Skagit Flats Falcons (& Owls?)!

February 10-12 (Fri-Sun)

North of Seattle the broad floodplains of the Skagit and Samish Rivers host an abundance of wintering raptors, shorebirds, ducks, geese, and swans. The wide-open air space favors falcons in particular, and all five North American falcons have been found there at one time. This year promises sightings of Snowy Owls as well!

Two nights of comfortable lodging in Mt. Vernon allow us to get to prime birding spots easily on Saturday and Sunday. We also visit the Nisqually National Wildlife Refuge on Sunday afternoon. *See website description for more details on this popular trip!*

Fee: \$325 members / \$425 non-members

Group size: 14 maximum with 2 leaders

Leader: Steve Engel



Merlin © Jim Cruce

Portland Audubon's

School of Birding 2012

There is still space in the 2012 year of the School of Birding. Class size is limited to 16 participants so register soon. The schedule at right includes class and field trip (in bold) dates.

Fee per quarter is \$495 and 20 hours of volunteering at Portland Audubon.

For more information or to register, contact Dan van den Broek at 971-222-6105 or dvandenbroek@audubonportland.org.

Winter 2012

January 4, 7, 11, 18, **21**

February 8, **11**, 22, 29

March **11**

Overnight field trip

January 14-15: TBA

Spring 2012

March 14, **17**, 21, 28, **31**

April 4, 7

May **12**, 16, 23

Overnight **May 19-20: TBA**

Summer 2012

July 18, **21**, 25, **28** • August 1, 4, 8, 15, **18**, 22

Overnight **August 25-26: TBA**

Winter Waterfowl

February 23 (Thu), 7pm-9pm: Class in Heron Hall

February 25 (Sat), 9am-4pm: Field Trip

In this class, we will learn to identify our local waterfowl by shape, plumage, habits, and habitats. Then on Saturday we will practice our new skills in the field. Join local guide and author **John Rakestraw** and enjoy the spectacle of massive flocks of wintering waterfowl. **Transportation for field trip provided by Audubon.**

Class & Field Trip Fee: \$65 members / \$80 non-members

Field Trip limited to 12 participants

Class-Only Fee: \$10 members / \$15 non-members

Chickadees, Nuthatches, Wrens, and Kinglets with Harry Nehls

March 20 (Tue), 7pm-9pm in Heron Hall

Two kinds of chickadees, two kinds of nuthatches, and two kinds of kinglets live in the Portland area.

Do you know where to look? When the best time of year is to find them? How would you tell them apart by sight, sound, behavior, habitat? Let the all-knowing **Harry Nehls** enlighten you in the first of his 2012 series of presentations.

Fee: \$10 members / \$15 non-members

Pre-registration required — free to active volunteers!

Nature Journaling with Jude Siegel: The Beauty of Winter in the Woods

March 24 & 31 (Sat), 10am-4pm in Heron Hall

Winter holds much beauty, a different sort of activity, and a subtle kind of energy. Join **Jude Siegel** as she invites you to relax and expand your perceptions of the natural world and then record them. You will learn to notice and appreciate your surroundings in new ways through simple exercises. On short walks you will find what charms you, make some notes and sketches, then develop them with simple drawings, watercolors, pen work, plant prints, and other techniques which will be taught. No art experience is required! Beginners and beyond are welcome. Jude's students appreciate her encouraging atmosphere and gentle approach that allow each individual's style to emerge. Jude will offer a spring season class in May.

Fee: \$75 members / \$95 non-members (plus materials)

Class Size: Limited to 16 participants

For instructor bio, materials list, and more details on Jude's classes, see www.audubonportland.org/trips-classes-camps/adult/nat-history-classes.

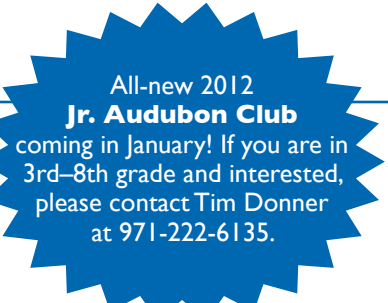

All-new 2012 **Jr. Audubon Club** coming in January! If you are in 3rd-8th grade and interested, please contact Tim Donner at 971-222-6135.

Spring Break Camp 2012 at the Audubon Society of Portland

Registration for Spring and Summer Camps begins January 10 at 8:00am.

To register, go to www.audubonportland.org for online registration or to download a registration form.

Call 971-222-6120 to save a place if you are mailing your form. Spring Break Camps run 8:45am-4:15pm unless otherwise noted.

MONDAY, MARCH 26	TUESDAY, MARCH 27	WEDNESDAY, MARCH 28	THURSDAY, MARCH 29	FRIDAY, MARCH 30
<p>Hop To It! 2nd-4th grade Springtime is frog time. Come with us as we check out the egg masses in Portland Audubon's pond and figure out which amphibians laid them. We'll also be on the lookout for that other amphibian, the salamander, as we search Balch Creek for salamanders and the insects that they love to eat. Get ready to hop to it! Fee: \$60 mem/ \$70 non-member</p> <p>Jammin' Salmon 4th-8th grade Embark on an adventure into the misty green forests of the Northwest to search for one of the forest's most important seasonal residents, the salmon! Hike along a local river and learn about the exciting and dangerous life cycle of these amazing fish. Investigate the local forests for signs of Ospreys, Bald Eagles, and other animals that search for the salmon too. Get ready to follow the fish! Fee: \$65 mem/ \$75 non-member</p>	<p>Wild Art Adventure 1st-3rd grade Create wildly wonderful clay and mixed media sculptures, graphite and colored pencil drawings, and watercolor paintings based on your observations of some of the amazing birds, mammals, and reptiles you'll discover in the Audubon Wildlife Sanctuary. Learn some exciting techniques to use as you work in a variety of art media. Fee: \$60 mem/ \$70 non-member</p> <p>Natural Navigation: Map, Compass, and Beyond 4th-8th grade Come spend the day at Portland's scenic Mt. Tabor Park to learn how to use a map and compass. We'll discover the hidden art of field navigation as we learn how to interpret a topographic map and how to use a compass. Learn how to read contour lines, understand map scale, and how to orient a map to the surrounding landscape. Combined with compass skills, we will learn some tips and tricks on using your observation skills, awareness, and internal compass to help find your way. With treasure map in hand, your team will be led to hidden treasures and clues on Portland's extinct volcano. The search is on! Fee: \$65 mem/ \$75 non-member</p>	<p>Forest Mask-arade 1st-2nd grade Come dressed in your own camouflage as we investigate how animals hide themselves in the forest. We'll learn new skills as we search our Sanctuary for hidden homes of forest creatures. Make and take home your very own forest mask. Fee: \$60 mem/ \$70 non-member</p> <p>Escape to Bird Island 3th-5th grade Escape to the birdiest island around: Sauvie Island. Spring brings a great mix of new birds like swallows and swifts, and wintering ones like the beautiful Sandhill Crane. Search for the nests of Bald Eagles and have a picnic with the birds as we explore all that Bird Island has to offer. Fee: \$65 mem/ \$75 non-member</p>	<p>Forest Detectives 1st-2nd grade Spend the day hiking and exploring some of Forest Park's many exciting trails. We'll learn about the plants and animals that live right here in Portland's backyard. March is a great time to find new wildflowers, drumming woodpeckers, and slimy Banana Slugs. Fee: \$60 mem/ \$70 non-member</p> <p>Junior Wildlife Vet 101 2nd-4th grade Join other animal lovers for a day devoted to learning about the care of injured and orphaned wildlife. We'll go behind the scenes of Audubon's Wildlife Care Center with wildlife rehabilitators and find out what this exciting job is all about. Fee: \$60 mem/ \$70 non-member</p>	<p>Ambush! 1st-2nd grade To ambush, to lie in wait, to surprise or to be in a concealed position. This will be our goal as participants divide into clans and use the Audubon Sanctuary to focus on the art of disappearing. We'll sneak through the woods trying to stay undetected by other clans, as maps that lead to bounty guide our way. Come with us for a sneaky adventure into the art of camouflage. Fee: \$60 mem/ \$70 non-member</p> <p>Junior Wildlife Vet 102 3rd-5th grade Join other animal lovers for a day devoted to learning about the care of injured and orphaned wildlife. We'll go behind the scenes of Audubon's Wildlife Care Center with wildlife rehabilitators and find out what this exciting job is all about. Fee: \$60 mem/ \$70 non-member</p>
WEDNESDAY, MARCH 28 - THURSDAY, MARCH 29				
<p>Whales Never Say Die 5th-8th grade Start: Wed, March 28, 8:30am • End: Thur, March 29, 5:00pm Trip Leaders: Tim Donner and Andrea Constance</p> <p>Have you heard about the lost treasure of One-Eyed Willie? Are you willing to travel along Oregon's coast, spying whales and searching for clues left in sand, in sea caves, and along sea stacks? If so, join Audubon educators for this unique and exciting mash-up of science and adventure! We will depart for the oldest city in Oregon and filming location for the popular movie <i>The Goonies</i>. Once in Astoria, we will stop by Mikey's house to see who can do the best Truffle Shuffle, and you'll create your own treasure map, marking spots of interest as well as fortune. From Astoria we will drive along the coast, stopping at beaches and viewpoints until we reach our resting spot: a warm bunkhouse that is a short walk from the ocean's edge. The next day we will practice our treasure-finding skills and scan the ocean for sprays of water which are telltale signs of Gray Whales as they migrate northward to the Bering Sea. This is sure to be a trip at the coast that will go down in history! Fee: \$115 mem/ \$135 non-member</p>				



www.facebook.com/audubonkidspdx

Keeping kids in touch with nature!

Sanctuaries News

The Spirit of Season

by Tom Costello, Sanctuaries Director

It is mid-December and as I sit down to write this article it is impossible to avoid the words "Season's Greetings" for more than a few hours: cards arriving in the mail, advertisements in the newspaper, billboards everywhere. I'm not trying to work the Scrooge angle here: I am all for spreading cheer, giving gifts, expressing gratitude, whether it be now or anytime during the year. But it is very curious for me to notice that there is very little attention paid to the season itself amongst all of the holiday messaging, save for occasional drawing of a smiling snowman wishing me well for the season on one of those cards that comes in the mail. So with no intention of spoiling anybody's holiday cheers, I do invite you to step outside and reconnect with the spirit of Winter for a few moments.

First and foremost for anyone involved in natural area restoration in our region, Winter is planting season. Trees and shrubs are dormant at this time of year and less prone to the shock of planting or transplanting. The cool, damp weather also reduces the risk of shock for the plant. That rain that we all love also softens the soils significantly, making it easier for our shovels to dig that hole for planting, as well as allowing more freedom of movement for our plants establishing root structure. Winter planting also gives our new trees and shrubs some time to establish new root growth before the stresses of summer heat and dryness test its hardiness.

This is also the time of year when we can get our best English Ivy pulling done. With all of the native perennials doing their version of going south for the Winter, we are free to comb the hillsides pulling Ivy without too much concern for how many of our lovely wildflowers we will tromp. It always amazes me how much we can churn up the ground during one of our Ivy work parties, yet the following Spring the native perennials bounce back from their dormant roots, good as new.

And if you want to get out and do some Ivy pulling this Winter, **please join us Saturday, January 28, 9am-1pm, for a monumental Ivy-pulling effort spearheaded by a local Boy Scout and Audubon member.** This is one two remaining heavy Ivy infestations in our Sanctuaries, and we would love as much help as possible this day to see how much of it we can get through.



Great Horned Owl. Photo: NoahGM



Rick Meyers hurries away before his ivy-pull pile can take revenge. © Tom Costello

Another of my favorite seasonal attractions in Winter is the return of owl calls through the night in the Sanctuaries and surrounding areas. Great Horned and Barred Owls both become suddenly prolific, usually by the end of January, as they begin their annual nesting rituals. The calls are wonderful in and of themselves, but I never cease to be warmed by the reminder that nesting season is upon us again and Spring will soon be returning.

Winter is a good season for raptors in general. I have fond memories of my days in Olympia taking hikes along the upper reaches of the local rivers to see Bald Eagles feeding on spawned-out salmon carcasses. Hawks are also common sights throughout Winter in open areas and river bottoms. Early February marks Audubon's annual Raptor Road Trip on Sauvie Island, a great opportunity to see many of these local birds.

My final favorite thing about Winter is the arrival of Spring! According to the Chinese solar calendar, Spring begins in early February, usually February 4th. And the Chinese lunar calendar welcomes both Spring and the new year on the new moon closest to the return of the solar spring. The Celtic calendar also marks the new year in early February. While the local temperature may make a Spring celebration in early February seem a little silly, at this point in the year the days have been getting longer for approximately a month and a half, and the plants are beginning to take their cues from the returning sun. Indian Plum and Red Alder have both typically budded out by February, and by early March our beloved trilliums have returned to our forested hillsides. Winter gradually yields to Spring, and new growth starts to spring out of the warming soil.

Nature Store Highlights

by Sally Loomis, Book Buyer

There are some great new book titles available in the Nature Store to curl up with during the dark winter months, and a new gardening title to get you in the mood for spring.

The National Geographic Field Guide to the Birds of North America (National Geographic, \$27.95) is newly available in a 6th edition, with updated range maps and 990 species descriptions, including revised taxonomic nomenclature and hundreds of full-color illustrations. This would make a fine addition to your field guide collection.

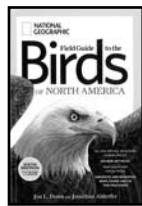

I highly recommend two recent books on conservation topics that are both great page-turners, featuring impassioned, thorough research on controversial subjects. Oregon environmental journalist Steven Hawley's **Recovering a Lost River: Removing Dams, Rewilding Salmon, Revitalizing Communities** (Beacon Press, \$26.95) describes the ongoing complex conflicts over dams on the Snake River, pitting the future of salmon between science and politics, Nature and Big Money. Hawley makes a compelling argument for dam removal. Vermont writer Joe Roman tackles the ESA with **Listed: Dispatches from America's Endangered Species Act** (Harvard University Press, \$27.95). Combining a fascinating range of issues, from tracking Florida panthers or (unsuccessfully) Ivory-billed Woodpeckers, to musings about the range of species in his young daughter's stuffed animal collection, Roman vividly captures how essential the ESA is for many species' survival, including our own.

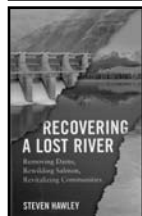

Dog Days, Raven Nights (Yale University Press, \$28.00) is a new work from corvid expert John Marzluff, whose previous title **In the Company of Crows and Ravens** has long been a popular title here in the Nature Store. Co-written with his wife, Colleen Marzluff, it recounts their Maine raven research in the late 1980s, assisted by a team of sled dogs that provide their own set of animal adventures. Evon Zerbetz contributes lovely linocut illustrations.



Corvallis landscaper Beth O'Donnell Young gives us **The Naturescaping Workbook: a Step-by-Step Guide for Bringing Nature to Your Backyard** (Timber Press, \$24.95). Participants in our Backyard Habitat Certification Program will especially enjoy getting her guidance planning an easy-care yard in harmony with the natural world. Lots of photographs and worksheets make this a wonderful reference and handbook.



The passing of Dave Marshall and his significance to the Audubon community has been noted elsewhere in the *Warbler*. The Nature Store would like to recognize his literary contributions to the birding life of Oregon, both in his magnum opus **Birds of Oregon: A General Reference** (Oregon State University Press, \$45.00) along with co-editors Matthew Hunter and Alan Contreras, or the more personal vision in his self-published **Memoirs of a Wildlife Biologist** (\$16.95). Both are available in the Nature Store, although supplies of the latter are limited.

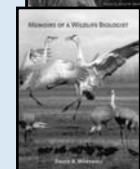

Audubon Society of Portland gratefully acknowledges these thoughtful gifts:

In Memory

- | | |
|---|---|
| Lee Alexander
Merle Alexander | Betsy Marlowe
Bonnie Martin & Gregg,
Sierra, Adam, Verona,
Debbie, Sherrie |
| Marjorie Sue Abramovitz
(Sanctuaries Fund)
Marshall Goldberg | Ray Martinelli
Brenda McGowan |
| Joan & Jim Anderson
Pamela & Terry Aldrich
Tammi Miller | David Menken
Mike Glayzer &
Janice Stewart |
| Olivia (Lib) Carpenter
The FX Team | Neil Hugh Molloy
Anneliese Sitterly |
| Elizabeth Cassard
Linda Crouse &
Christopher Cassard | Georgia Mae Pietz
Britton Pietz |
| Frederick Richard Clarke
Robert & Jill Jarrett | Coley B. Ranew Jr.
Derek Ranew |
| Alice Rose Hallberg
Beverly Hallberg &
Floyd Skloot | James DeLoss Robertson
Harriet Anderson
James Bradach
Dave & Dawn-Starr
Eshbaugh
Rian & Dezsea Zenner |
| Baby Helena
Northeast Planned
Parenthood Health Center | Linda L. Robinson
Sandra Hattan
Karen Johnson |
| Shirley Labinowicz
Edward Labinowicz | Barbara Tinker
Lisa Malcy |
| Mancha
Morgan Dean | Bernice Wozniak
Joann Wozniak |
| David B. Marshall | |
| Harriet Anderson
George &
Frances Alderson
Susan Bexton
Jim & Beth Buxman
Charlotte & David Corkran
Dave Eshbaugh
Peggy Goldie
Mark Greenfield &
Jane Hartline
Sharon Harmon &
Gary Kish | Peter Kendall
Malheur Wildlife Associates
Eleanor McClung
Bill & Nancy Meyer
Terry Moore
Deanna &
Wilfried Mueller-Crispin
Claire Puchy
Linda Rasmussen
Robert & Karen Schmidt |

In Honor

- | | |
|---|---|
| Harriet Anderson
Dean Anderson &
Carol-Anne, Sam, Tom,
Mary Catherine, Rebecca,
Joseph | Karen & Stephen Roberti
Patricia Sims |
| Charlie Armstrong
Grandma & Grandad
Donner | Stuart & Shannon Rosenfeld
Charles Rosenfeld |
| Linda Cella
Toni Cella-Green | William W. Rosenfeld
Charles Rosenfeld |
| Barney Cohen
Randy Zasloff &
Frederick Cohen | William & Sherry Rosenfeld Jr. & Family
Charles Rosenfeld |
| Grandma Cita Mott
Jen & Dave Woronets | Virginia Ross
Mary Baetkey
Robert D. Erwin
Deanna Sawtelle |
| Dawn Jansen & Alan Kiphut
David Jansen | Deanna Sawtelle
Ginnie Ross |
| The Labbe Family
Charles Rosenfeld | Joey Silberstein
Helena Silberstein |
| Laramie
Angela Agosta | Tedd Schmitt & Paula Pender
Mary Ellen Schmitt |
| Morgan
Heather Stein | Bev & Paul Woodsong
Teresa Herlinger |
| Marianne Nelson
Robert Thinnis & Kay Hilt | Jim Wozniak
Michael Kotel |
| George Rasmussen
Bridget O'Rourke &
Jeff, Molly, Brenna | |

You can honor a special person with a gift to Audubon Society of Portland. Your gift will help fund a future of inspiring people to love and protect nature. You can make an Honor or Memorial gift online at www.audubonportland.org or by calling 971-222-6130. A songbird card acknowledging your thoughtful gift will be sent to the honoree or family.

Volunteer of the Month: Carol Evans

by Nancy Mattson,
Nature Store Manager

Portland Audubon had a lucky year in 2007 when **Carol Evans** moved to Portland from Olympia, WA. She arrived with a mission: find the local Audubon chapter, become a member, and volunteer at a store in a wildlife sanctuary. As Carol says “I knew what I loved to do and Portland Audubon gave me the opportunity to do even more of it!”

Living in Olympia, Carol was a member of the Black Hills Audubon Society and a volunteer at the Nisqually National Wildlife Refuge store. So, much to our delight, Carol arrived “fully trained” and a perfect match! We can’t really take credit for Carol’s move to Oregon. That honor goes to her daughters, Portland residents Kari and Christy, and young grandsons Bayley and Sam, the perfect lure to relocate.

A well-traveled Hoosier, Carol left Indiana for college in Ohio then on to Boston University for graduate work as a physical therapist. It was a career she pursued in Massachusetts and Vermont. Husband Stan’s work took them cross country to San Francisco and back again, offering exciting opportunities on the West Coast. One was experiencing the San Francisco’s 1989 Loma Prieta earthquake as a resident of the Marina District, a damage epicenter.



Nearly as exciting were her years as a volunteer with the California Academy of Sciences. Carol’s role as docent in their educational and outreach programs gave her a wealth of experience. She worked with children of all ages, but found the high school level the most challenging. The Aquatic Invertebrate Program proved to be her favorite, an interest that carried over to the Nisqually estuary.

With Carol now retired from her physical therapy career, Portland Audubon is the lucky recipient of her generous volunteer hours. In addition to a store shift, she works as receptionist in our Administrative Offices. We benefit not only from Carol’s knowledge and love of the natural world, but also her always upbeat, helpful, and friendly demeanor. It’s no surprise that Carol recruits more new members than any other Nature Store staff member. Who wouldn’t want to join an organization that can attract such a fun volunteer?

While we are briefly without Carol’s assistance as she recovers from recent surgery for what she terms “Old Lady Back,” all of us are looking forward to Carol bringing back her own special brand of sunshine to Audubon. **Thanks, Carol**, for all the great work you’ve done in the past — and we can’t wait till you’re back doing the work you “love to do”!

Periodic Movements of Snowy Owls

On November 16 Carole Hallett reported that a **Snowy Owl** was found dead at the Portland Airport. That same day several were seen along the Washington Coast. Soon after, reports arrived indicating that the owls were increasing rapidly in southern British Columbia and were moving into Washington. Several more soon began arriving in Oregon. It appears that the winter of 2011–2012 would be an invasion year for Snowy Owls along the West Coast.



Snowy Owl. Photo: Yoky

It has long been thought that Snowy Owls staged occasional southward invasions caused by the collapse of the lemming populations in the Arctic. Studies in recent years have found this not to be true, though the main cause is still a mystery.

Lemming populations in the Arctic are widespread but the colonies are often widely separated. When conditions are excellent a colony will increase greatly and the owls move in to take advantage of the available food source to raise their young. In poor years the lemmings scatter, forcing the owls to move to other more successful colonies. Areas where the owls were common for several years suddenly are deserted and, conversely, numbers increase where owls were not regularly seen for years.

Following nesting the owls scatter and become less dependant on lemmings, but will take other small- to medium-sized birds and mammals. There is a regular yearly southward movement of many Snowy Owls to winter in southern Canada and the northern prairies of the United States.

In certain years even greater numbers of Snowys move southward, staging conspicuous invasions south of their regular winter ranges. These movements are not usually general, only occurring along the East Coast but not the West, or just into the prairie states. Occasionally the invasion occurs all across the country.

Contrary to former thinking, these invasive birds generally arrive healthy and well fed. They do well in the southern areas and often remain into May when the temperatures have warmed considerably. These birds suffer quite a bit of mortality by being hit by cars, trains, and airplanes, and by overhead wires and all the other human-made objects not found in the Arctic. Most, though, return to the Arctic in good condition.

Most Snowy Owls that occur in Oregon are immature birds; some are very young, not long out of the nest. Adult males move a bit south of the breeding range and set up territories, but when the females arrive they take over and force the males farther south. Immature birds must move even farther south to escape competition from the adult birds.

Snowy Owls are often found sitting on the ground in a large open field, but they do occur in cities and on open coastal beaches and in grasslands. They can forage for food both day and night. There is little competition from other birds, but coyotes and foxes are occasional problems. These owls will allow a fairly close approach by humans. Even so, it is best to give them space and not harass them.

Sightings

Conspicuous migrations continued to mid-November with stragglers noted into December. Numerous sightings of unexpected birds have been the highlight of this fall’s birding.

It appears that the spectacular concentrations along the Columbia River in the Portland area last year will be continued this winter. On November 30 Jack Williamson found a tight flock of 74 **Western Grebes** off Broughton Beach near the Portland Airport. Visitors to Broughton Beach also have seen one or two **Short-eared Owls** and many **Pipits**. On November 25 Tom McNamara observed two **Snow Buntings** on the beach there. Perhaps they were the two that were at Powell Butte Park in early November.

Birding at Smith & Bybee Wetlands in North Portland has been outstanding. On October 6 Jay Withgott saw a **Pacific Golden-Plover** and a **Snowy Egret** there. Christopher and Adrian Hinkle saw a **Sabine’s Gull** October 8. And on November 26 they spotted 15 **Arctic Terns** flying over the lakes. A **Long-tailed Duck** was there all fall.

On October 14 David Irons observed a **Surf Scoter** on Oswego Lake; Adrian Hinkle noted one at Westmoreland Park October 21 and one on a Mt. Tabor reservoir November 7. Stefan Schlick reported 20 scoters on Hagg Lake south of Forest Grove November 5. Jay Withgott observed an immature **Heermann’s Gull** October 21 at the Koll Center Wetlands in Beaverton. Craig Tumer saw a male **Red-breasted Merganser** there November 7, and Grant Canterbury found another at the mouth of the Clackamas River October 20.

Brambling.
Photo: Martin
Mecnarowski



The annual **Sandhill Crane** count in the Sauvie Island–Ridgefield NWR area October 9 found 4,174 going to evening roosts there. Up to 910 have remained into late November. On November 9 Scott Carpenter saw an **Ibis** fly from Ridgefield NWR over the river to Sauvie Island. On November 26 David Irons spotted a **Cattle Egret** fly past Coon Point on Sauvie Island.

Other interesting sightings: On October 8 a stunned **Poorwill** was found in front of the Clackamas Backyard Bird Shop. It strongly flew away later that day. A **Flammulated Owl** was at Bonneville Dam October 13 and another was in southwest Portland October 25. Steve Nord observed a **Brown Pelican** November 28 at the Fernhill Wetlands. David Irons spotted an **Emperor Goose** in a goose flock near Lafayette November 23.

The star of this fall lineup was the immature male **Vermilion Flycatcher** Caleb Gordon and Julie Willmott found October 24 at Ridgefield NWR. It remained for many to see. On November 25 Lona Pierce picked out a bright **Brambling** near the Sewage Ponds in Scappoose Bottoms. It also remained for photos.



Volunteer Luanne Bye leading a sanctuary tour. © Portland Audubon

Volunteering at Audubon is Fun and Rewarding!

by Deanna Sawtelle, Volunteer Coordinator

“Inspiring people to love and protect nature.” That’s Audubon’s mission and it’s what our volunteers do every day! The Audubon Society of Portland is one of the Northwest’s leading conservation organizations, offering a wide range of natural history and environmental activities to members, the community, and especially volunteers. **Whatever your interests or talents, there is a volunteer position for you.** These include many regularly scheduled volunteer opportunities, as well as special projects and event positions:

- Help restore habitat in our wildlife sanctuary.
- Be a conservation activist!

- Care for and feed injured wildlife at the Wildlife Care Center. (There is usually a wait list for this volunteer opportunity.)
- Help visitors find the perfect gift, bird guide, or pair of binoculars by being a clerk at the Nature Store.
- Lead school groups through a fascinating exploration of our nature sanctuary.
- Be a voice for Audubon by volunteering as a receptionist or an Audubon Docent.
- Help make Audubon’s special events successful, like the Wild Arts Festival, the Native Plant Sale, International Culture Awareness Day, “Night Flight” (Audubon’s Halloween event), and Swift Watch.

New Volunteer Orientation: Sat, February 11, 1pm–3:30pm, OR Wed, February 15, 6pm–8:30pm. Individuals wanting to volunteer in a capacity beyond special events must also attend **General Volunteer Training: Tues, February 21, 9am–4:30pm, OR Sat, February 25, 9am–4:30pm.**

If you would like to donate some of your time and energy to the Audubon Society of Portland, please contact Deanna Sawtelle at **volunteercoordinator@audubonportland.org** or **503-292-6855 ext.108.**

Wild Arts Festival Wrap

by Mary Solares, Wild Arts Festival Chair

The 31st year of the Wild Arts Festival was its most successful. The Festival netted the highest amount ever — close to **\$60,000!** On a crisp and sunny weekend **4,300** people turned out to wander through the spacious 3-story atrium of the Montgomery Park building. The atmosphere was electric. Greeting Festival goers was a sweeping view of swirling colors from paintings, photographs, jewelry, ceramics, sculptures, fabrics, and happy people soaking it in.



Wild Arts Festival Steering and Book Fair Committees: (front, left to right) Bob Gandolfi, Wink Gross, and (back, left to right) Toni Rubin, Molly Marks, Jenny Jones, Lynne Wintermute, Martha Gannett, Candy Plant, Mary Solares, Laurie Garretson, Leisl Stientjes, Mary Ratcliff © Meryl Redisch

The Wild Arts Festival is much more than an art and book fair. It is a place where you can see and be connected to the Audubon Society of Portland and to the love of nature that it inspires. Attendees might be looking at a beautiful metal sculpture of a raven one moment and then turn and look straight into the black eyes of Aristophanes, one of Audubon's renowned Education Birds. Throughout the show the "Ed Birds" drew eager children and adults around their handlers to ask questions and get close to these charismatic birds.

Sixty-nine artists arrayed their finest creations in colorful displays. The artists love the Festival not only for its connection to nature but for the support they get from our volunteers, who help them move their display stands and artwork. The Wild Arts Festival is often described as their favorite show of the year.

This year brought together 38 authors to sign books and talk with Festival goers. The caliber of authors this year was impressive. Sales were very strong and set a new record.

One of the most anticipated events of the Festival is a wild competition to purchase 6"x6" original artworks. People began lining up as soon as the doors opened and patiently waited until 11am when the buying frenzy began to purchase one of the 191 paintings.

The Silent Auction was packed with nature-themed items and adventure outings that were donated by Festival artists or Audubon members. When



Artwork © Dean Crouser

Be sure to mark your calendars for the 2012 Wild Arts Festival — always held the weekend before Thanksgiving.

We want to thank and acknowledge these key sponsors:

Bald Eagle – \$2,500
Backyard Bird Shop
Barran Liebman LLP
The Oregonian
TriMet

Kingfisher – \$1,000
Dave's Killer Bread

Swift – \$500
Art Media
Auctions Director
Elk Cove Vineyards
Portland Audubon Board of Directors

And the many "Forty Friends"

it closed on Sunday afternoon, amid a swirl of last-moment bidding, we closed with sales of \$14,500.

This year the marketing and advertising was stepped up. In addition to articles in local newspapers, publicity was provided through 20 TriMet bus 'tails,' 14,000 postcards, color ads in the *Oregonian*, radio and TV spots, Facebook, and Audubon being featured on Channel 12's "On the Go with Joe." It paid off with our attendance increasing to 4,300.

The whole Wild Arts Festival ran efficiently because of the energy and enthusiasm of its organizers and volunteers. On behalf of the Audubon Society of Portland, special thanks to the **Steering Committee**: Bob Gandolfi, Martha Gannett, Wink Gross, Jenny Jones, Molly Marks, Candy Plant, Mary Solares, Leisl Stientjes, and Lynne Wintermute. Additional thanks go to Sue Allen, Linda Craig, Anne Eakin, Laurie Garretson, Gay Greger, Barb Macomber, Elisa Malin, Rick Meyers, Joanne Nowak, Beth Parmenter, John Plant, Mary Ratcliff, Toni Rubin, Marilyn Scott, Marilyn Stinnett, Rusty Whitney, Bob Wilson, David Wynn, and the other 150 hardworking volunteers.

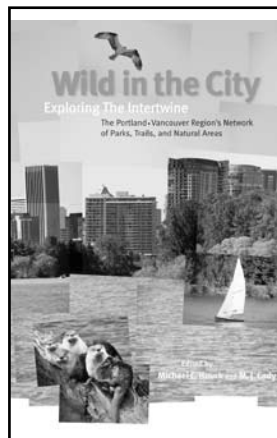

Welcome, New Members!

Portland Audubon is a force in conservation thanks to its strength in membership, standing together since 1902. We appreciate each and every one of our members and celebrate our membership by welcoming our new members monthly. Thank you for joining our vibrant and growing community!

- | | |
|-------------------------------|------------------------------|
| Adrian Amabisca | Martha Landowne |
| Angela Amundson | & Constance Ashbrook |
| Francesca Anderson | Alice Larsen |
| Apex Wellness Center | Marcia Lepley |
| Keiko Archer | Heidi Leugers |
| Deborah Bailey Hill | Marilyn Lindberg |
| Ken Barker | Susan Little |
| Judy Bartle | Donna Litvin |
| Nathan Bartlett | Marlin Lovelin |
| Coleen Belisle | Amy Mace-McLatchie |
| Alan Benkendorf | Dana & Michael Maginn |
| Jami & William Berry | Jeff Marks |
| Frank & Suzanne Biggs | Arnold Marsa |
| Jack & Barbara Blankenship | James McCall |
| Richard Botney | Antonio & Yolanda McKinney |
| Thomas & Barbara Brady | Carol Meckes |
| Ray Braghetta | Cary Meriwether |
| Stephan & Alice Brocoum | Linda Mieth |
| Richard Brown | Donna Migneault |
| Donna Brown | Jim Mockford |
| Larry Buchholz | Teresa Monroe |
| & Debra Timm | Holly Mueller |
| Wayne Buttice | Eliza Nelson |
| Maurine & Paul Canarsky | Maria Olaya |
| Victoria Carman | Rachel O'Neil |
| Marion Carrion | Judi Paisley |
| Douglas Chadwick | Kari Penca |
| Stuart Clark | Mary Beth Peterson |
| Penny Clouser | Ivan Phillipsen |
| Jason & Katherine Cobb | Zoe Piliakas |
| Jeremy Cohen | David & Kathryn Pollard |
| Roger Coit | Suzanne Pond |
| Ken & Bev Collins | Joy Poole & Herc Silverstein |
| Brian & Jennifer Cooper | Douglas and Cathy Prier |
| Joseph & Carolyn Corvino | Joseph Reeb |
| Rob & Deborah Cowling | & Catherine Thompson |
| Kenya Cruz | Andrew Rice |
| Laurel & Scott Demming | Mary Ritzmann |
| Robin & Scott Denburg | Christine Robie |
| Robert & Cristina Dieffenbach | Bas Roels |
| Mary Donley | Max Roels |
| Jeff Douglas | Miriam Rogers |
| Georgia Eckert | Kathy Rollins |
| Brad & Rebecca Elliott | Karen Romanelli |
| Sue Epping | Nathan Ryan |
| Arthur & Margianne Erickson | Mark Ryan |
| Sue Ericsson | Loretta Sampson |
| Cynthia Evans | Evan Saulino |
| Janice Ezell | Linda & Daniel Schick |
| Patricia Farris | Jean Schifferns |
| Nancy Fisher | & Steve Nussbaum |
| Dan Flood | Milivoje Sekulic |
| Paula Frechen | Nancy Sellers |
| David & Miriam Freund | Tim Sherburn |
| Michael Friton | Bob & Jeanne Shriver |
| Byron Frohn | Helena Silberstein |
| Cynthia Girres | Lisa Simeoni |
| Jean Gloppen | Barbara Snead |
| Carolyn Gough | Carl Snook |
| Linda Graham | Deborah & Paul Speer |
| Ramona Granath | Joe & Rita Stafford |
| Anne Graves | Anne & John Stalnaker |
| Amanda Greene | Steven Statler |
| Gaylene Grossen | & Susan Parkins |
| John & Pat Gruher | Lynn Steeves |
| Heather Guthrie & Gil Parker | Carl Stillmaker |
| Ann Hargraves | Cynthia Stockwell |
| Marilyn Hartzell | Joan Svoboda |
| Hayley Heider | Michael Tannenbaum |
| Sylvia & Tom Hendrickson | Gaye Thomas |
| Helen Hepp | Jeffrey Tiefer |
| Teri Hoecker | Michelle Trachsel |
| Mary Holderness | Mary Tran |
| Denise Holmes | Laura Triner |
| Amy Horlings | Roni Viles |
| John Horn | Ann Warren |
| Donna Horstman | Jeffrey & Ann Weeks |
| Scott & Ann Hovda | Ingrid Wehrle |
| Jerry & Traci Hovda | Donald & Carol Wiens |
| Astrid Howells | Nancy Willmes |
| Jennifer Jako | Claire Wilson |
| Dana Johnson | Sheryl Wing |
| Andrew Karl | Robin Wise |
| Julia Kassissieh | Henryk Wysocki |
| Donna Kauffman | James & Carolyn Young |
| Anne & Bret Knewtson | Raymond Yurkewycz |
| Tricia Knoll & Darrell Salk | |
| Virginia Knox | |
| Kruger's Farm Market | |
| Paola LaMorticella | |

If you would like to join us or have any questions about membership, please contact Pam at pmeyers@audubonportland.org or 503-292-6855.



© Rusty Whitney

Wish List & Thank Yous

Thank you to:

- Pat & Joe Campbell for Elk Cove Vineyards wine for the "Fly by Night" event
- Grand Central Bakery for treats at the Nature Store Holiday Open House
- Mark Greenfield for an HP Laserjet 3380 printer and new cartridge
- John & Judie Hammerstad for wine for the "Fly by Night" event
- Lynda Jordan for several boxes of bird books and magazines given in memory of her late husband, David Ross Jordan
- Don Kruger & Kruger's Farm Market for 30 pumpkins for the October 2011 Halloween event
- Alan Locklear & Marie Valleroy for four large jugs of bleach for the Wildlife Care Center
- Daniel Mendelsohn for 30 juvenile-adult rats for the Wildlife Care Center
- Nature Bake & Dave's Killer Bread for 10 loaves of Whole Cracked Wheat bread and 42 of Good Seed Halos bread for the Wild Arts Festival
- Mark Owens for a large box of bird guides and books
- Edie Page for six small antique bird prints
- Candy & John Plant for a scale and two fans for two incubators for the Wildlife Care Center
- Elizabeth Powell for 18 Salt Marsh Pottery "Wave" tiles
- Nanci Tangeman for an HP laptop computer and a flat screen monitor
- Darolyn Wylie for an HP Pavillion desktop computer and flat screen monitor

Our Wish List:

For Education:

- Laptop computer
- Powerpoint Projector
- Flat-Screen Monitor

For Membership Development:

- Flat-Screen Monitor

For Sanctuary:

- Loppers • Hand saws
- Work gloves

For Wildlife Care Center:

- Science Diet Kitten Growth • Bleach
- Dawn Dishwashing Detergent
- Camper/Trailer
- Untreated Wood: 2x4, 4x4, 4x8

If you can donate these items, please first contact Audubon Society of Portland at 503-292-6855 ext. 102, Mon-Fri, to arrange a time for delivery/pick-up.

Important Bird Areas

by Mary Coolidge, Assistant Conservation Director

Oregon's IBA Program Picks up 3 Global Designations: Hart Mountain National Antelope Refuge, Marbled Murrelet Central Coast IBA, and Oregon Canyon and Trout Creek Mountains IBA



Meryl Redisch receives the "big key" from Russ Humbertson, Jr. © Tim Gunther

You Did It — and We Got It! Portland Audubon Receives Toyota Sienna from Toyota's 100 Cars for Good Program

by Ann Takamoto, Development Director

You'll soon be seeing our Education Birds "flying" around Portland on the sides of our brand new Toyota Sienna! Thanks to your Facebook votes, Portland Audubon will have its first "official" vehicle and another kind of *brand ambassador* serving our mission in the community.

Our new Sienna will provide transportation for injured and orphaned birds and wildlife to and from our Wildlife Care Center; for our eight non-releasable Education Birds that act as ambassadors for us at public events and in classrooms; and as a support vehicle for our classes, camps, and trips. We are thrilled to be getting it "wrapped" with Audubon Society of Portland imagery and messaging — a rolling billboard for our work!

Russ Humbertson, Jr., General Manager of Beaverton Toyota, officially handed the "big key" to Meryl Redisch, Audubon Executive Director, on November 17 at a gala event in Beaverton Toyota's new service department. Beaverton Toyota surprised us with a generous donation of \$2,500 which will be matched with Toyota Corporate — so, not only did we come away with a new van, we also came away with \$5,000, which will help cover the costs to "wrap the van" and assist with additional expenses like gas and insurance.

Special thanks to Margie Humbertson for arranging all of the details for a smooth transfer and to Liz Healy-Kay for handling our marketing efforts! We are pleased to welcome Beaverton Toyota to our list of Business Members and thank them for their wonderful support. And thanks to all of you, members, for helping us get out the vote and win this great new vehicle!



View from Cape Perpetua © Tammi Miller



Trout Creek Canyon in southeastern Oregon. Photo: BLM



Hart Mountain overlooking the Warner Valley © Marilyn Stinnett

Oregon's magnificent landscape hosts the fifth largest diversity of birds in the United States. Nearly 500 bird species depend on and are critical to the ecosystem health of our deserts, wetlands, ocean, river valleys, forests, and grasslands across the state. We owe them a lot: these birds pollinate plants, disperse seeds, control pests, connect us to place, capture our hearts and our imaginations, and provide metaphors for our lives.

Today in Oregon, a network of 97 Important Bird Areas (IBAs) distributed across the state helps to knit these places together and focus our conservation efforts on the most valuable sites. Together our IBA lands provide an astounding 3.4 million acres of critical breeding, wintering and migrating habitat for birds. This land is in multiple ownerships — federal, state, county and city government, private, and nonprofit — and it may or may not already enjoy protections.

Last month, we got word that the three Oregon IBAs which we nominated for global status were accepted by the U.S. IBA Technical Committee! As the U.S. partner of BirdLife International's Global IBA program, National Audubon Society coordinates the review of all proposals to elevate state-level IBAs. Our new Globally significant IBAs are Hart Mountain National Antelope Refuge, Oregon Canyon and Trout Creek Mountains, and Marbled Murrelet Central

Coast IBAs. That means that these IBAs are ranked among the highest priority sites in the U.S. for conservation action. Today there are over 2,500 state-level IBAs in the United States, and 449 Global IBAs. IBAs that receive a global designation have been evaluated in a broader context, which helps to facilitate the necessary focusing of limited conservation resources. Prioritization not only helps direct decision-making about where to work, but can also help to leverage funding and carry the message that these places bear regional and global significance in the preservation of imperiled bird populations.

Each of the sites qualified for Global status because they host a Species of Global Conservation Concern. **Hart Mountain National Antelope Refuge** in south-central Oregon encompasses one of the most extensive sage steppe habitats in Oregon. 239 documented bird species have been documented on the refuge, including Short-eared Owl, Northern Harrier, Rough-legged Hawk, Black-chinned Hummingbird, Common Nighthawk, Common Poorwill, Horned Lark, Vesper Sparrow, Brewer's Sparrow, Savannah Sparrow, Lark Sparrow, Chipping Sparrow, Cassin's Finch, Sage Thrasher, Ash-throated Flycatcher, Gray Flycatcher, Townsend's Solitaire, Western Meadowlark, Lazuli Bunting, Black-throated Gray Warbler, and Western Wood-Pewee. The refuge earned its Global designation because it hosts significant number of active **Greater Sage Grouse** leks (a federally Warranted but Precluded ESA-candidate species).

Oregon Canyon and Trout Creek Mountains in far southeastern Oregon straddle Harney and Malheur Counties, and take in aspen woodlands, mountain mahogany woodlands, savannah, diverse shrublands, and wet meadows. This is a rare location in southeastern Oregon for breeding Northern Goshawk, Black-throated Gray Warbler, Pine Siskin, Mountain Chickadee, Red Crossbill, Bushtit, Hermit Thrush, and MacGillivray's Warbler. The global designation is bestowed because of a significant number of active **Greater Sage Grouse** leks (a federally Warranted but Precluded ESA-candidate species).

The 80,000-acre **Marbled Murrelet Central Coast IBA** contains critical Murrelet habitat and hosts perhaps the highest **Marbled Murrelet** concentration in the state. Murrelets require old-growth trees with large, mossy limbs on which to lay eggs and good overhead cover to shield them from severe weather and nest predators. This IBA contains the largest intact stand of coastal temperate rainforest in the lower 48 states. The highest concentration of nearshore murrelets is found between Newport and Florence, the nearshore waters of which have now been included in the terrestrial portion of the MAMU IBA, which extends roughly from Cape Perpetua to Heceta Head.

These represent just the first of several Global nominations we intend to bring before the National IBA Technical Committee. For now, we are thrilled to at last have Oregon represented on the Global IBA map! For more information, please visit our IBA webpage, which is open during renovation: audubonportland.org/local-birding/iba.

Members Receive a Discount at the Nature Store!

Audubon Society of Portland's Nature Store is the headquarters for naturalists in the Portland-Vancouver metro area. We feature nature books, hiking & field guides, binoculars & spotting scopes, bird feeders & seed, plus gifts & toys for adults & children, all with a nature theme. **Portland Audubon members receive a 10% discount off regular prices.**

We always start the New Year with a **heartfelt thank you to all our members who shopped at the Nature Store in 2011!** Nearly 70% of our sales are made to Audubon members, who see the value of spending their shopping dollars at their favorite nonprofit.

"Where all the Profits are for The Birds" is our motto. We are fully owned and managed by Portland Audubon. **100% of the income we generate goes to support Portland Audubon:** our Wildlife Care Center, wildlife sanctuaries, conservation activities, and educational programs.

© Portland Audubon

And thanks to our crew of 40 friendly volunteers, who keep us well-staffed and open 7 days a week. And thank you, too, to the vendors who keep our store stocked with useful, beautiful, affordable items. We constantly search for the "Best of the Northwest" from local vendors and craftspeople. Keeping our buying dollars circulating within our community and offering products that are representative of our unique region are top priorities.

We look forward to seeing all our members in 2012! Stop by anytime to say "hello" and give us input on the best way to serve our members. We're here for you!



PORTLAND AUDUBON'S NATURE STORE

5151 NW Cornell Road • Portland, OR 97210
503-292-9453 • store@audubonportland.org

Open 10am–6pm Monday through Saturday
10am–5pm Sunday

Birdathon 2012

by Gary Slone, Birdathon Coordinator

This year, in an effort to expand Birdathon participation, the Birdathon Planning Committee is seeking additional Team & Trip Leaders. Why not consider forming your own Birdathon team?



Some birding expertise is helpful, but it's not at all necessary. All it takes is a desire to bird watch and help the Audubon Society of Portland raise Birdathon funds.

Here's how:

- Your own Birdathon team can simply be you and a group of friends just getting together for a morning of bird watching.
- Your own Birdathon team can be you and your family enjoying a special day of birding at your own backyard birdfeeders.
- Your own Birdathon team can be you introducing a group of co-workers to your favorite birding spot.
- If you're an experienced field trip leader, why not lead your own team to your favorite birding locations?

Just think creatively!

Please contact me directly at gary.audubon@gmail.com, and I'll help you organize all the details.

Great Backyard Bird Count

February 17-20, 2012

www.birdsource.org/gbbc

You can contribute to science while having fun watching birds by taking part in the **Great Backyard Bird Count!** The Cornell Lab of Ornithology is asking birders all around the country to grab their binoculars and their checklists and count as many birds as they can **between February 17 and 20** (4 days). Not only does this give you another excuse to watch birds, you can make an important contribution (for free) to the birding world in the name of science.

How to take part in the Great Backyard Bird Count

Step 1: Between February 17 and 20, plan to count birds for **at least 15 minutes a day** for 1, 2, 3, or all 4 days. You can count for as little as 15 minutes on a single day — or count all day long for all 4 days. It's entirely up to you!

Step 2: Count and tally the greatest number of individual birds of each species you see. Let's say you see a flock of 20 Juncos in the morning and then later that day you see a flock of 15 Juncos — you would just tally 20 Juncos. Don't combine all the individual birds for the day, **just the greatest number of each species at**

any one time. You simply do this for every bird species that you see during your counting time.

Step 3: After you're finished counting for the day, go to **gbbc.birdsource.org/gbbcApps/input** to report your findings.

Follow these 3 easy steps for every site you count at. You can count at a single site or you can go to as many of your favorite birding spots as you like. Backyards, neighborhood parks, wildlife refuges, coastal sanctuaries... anywhere you want to count! **You can turn in as many checklists as you like.**

If you have any questions about how the Great Backyard Bird Count works or how to participate, please visit birdsource.org/gbbc and explore the website. You can watch the instructional video, find GBBC activities for kids, enter the photo contest, download a regional species checklist, see results from years past, and much more.



Varied Thrush © Steve Berliner

Calendar at a Glance

For the most up-to-date information, visit audubonportland.org.

JANUARY

1	Sun	6:30am	Hood River Christmas Bird Count (p.2)
1	Sun	—	New Year's Day: Nature Store closed
2	Mon	—	Admin & Nature Store closed
3	Tue	7:30pm	Birders' Night in Heron Hall
4	Wed	tba	School of Birding term begins (p.7)
7	Sat	7:30am-5pm	Audubon Outing (p.3)
10	Tues	8am	Spring & Summer Camp registration begins
10	Tue	7pm	Nature Night: Caspian Terns of East Sand Island (p.3)
11	Wed	9am-11am	Audubon Outing (p.3)
14	Sat	7am-5pm	Audubon Outing (p.3)
16	Mon	—	M.L.King Jr Day: Admin closed
19	Thu	8am-10am	Audubon Outing (p.3)
19	Thu	7pm	Board Meeting
24	Tue	9am-4pm	Audubon Outing (p.3)
28	Sat	8am-11am	Audubon Outing (p.3)
28	Sat	9am-1pm	Sanctuary Work Party (p.8)

FEBRUARY

1	Wed	7pm-9pm	Raptor Road Trip Rev Up! (p.7)
4	Sat	9am-2pm	Raptor Road Trip (p.1)
7	Tue	7:30pm	Birders' Night in Heron Hall
10	Fri	tba	Skagit Flats trip begins (p.7)
11	Sat	7am-5pm	Audubon Outing (p.3)
11	Sat	1pm-3:30pm	New Volunteer Orientation (p.9)
12	Sun	8am-11am	Audubon Outing (p.3)
12	Sun	Noon-4pm	Wildlife Care Center Open House (p.1)
14	Tue	7pm	Nature Night: Oil and Water (p.3)
15	Wed	6pm-8:30pm	New Volunteer Orientation (p.9)
16	Thu	7pm	Board Meeting
17-20	—	—	Great Backyard Bird Count (p.12)
18	Sat	9am-Noon	Audubon Outing (p.3)
21	Tue	9am-4:30pm	General Volunteer Training (p.9)
22	Wed	6:30pm-8pm	East Portland Events (p.4)
23	Thu	8am-4:30pm	Audubon Outing (p.3)
23	Thu	7pm-9pm	Winter Waterfowl class (p.7)
24	Fri	8am-6pm	Urban Ecology Symposium at PSU (p.2)
25	Sat	8am-11am	Audubon Outing (p.3)
25	Sat	9am-Noon	Bluebird Monitor Workshop at Champoeg (p.2)
25	Sat	9am-11am	East Portland Event (p.5)
25	Sat	9am-3pm	Winter Waterfowl field trip (p.7)
25	Sat	9am-4:30pm	General Volunteer Training (p.9)

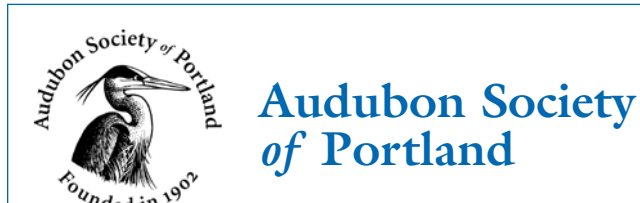

Audubon Society of Portland

Inspiring people to love and protect nature since 1902

Audubon Society of Portland promotes the enjoyment, understanding, and protection of native birds and other wildlife and their habitats. We focus on our local community and the Pacific Northwest.

ADMINISTRATION OFFICES

5151 NW Cornell Rd • Portland, OR 97210
503-292-6855 • Fax: 503-292-1021
9am to 5pm, Mon. - Fri.

SANCTUARIES

Dawn to dusk every day

NATURE STORE

503-292-9453

10am to 6pm, Mon. - Sat.
10am to 5pm on Sunday

WILDLIFE

CARE CENTER

503-292-0304

9am to 5pm every day

INTERPRETIVE CENTER & LIBRARY

Same hours as store

RARE BIRD ALERT

503-292-6855 • www.audubonportland.org

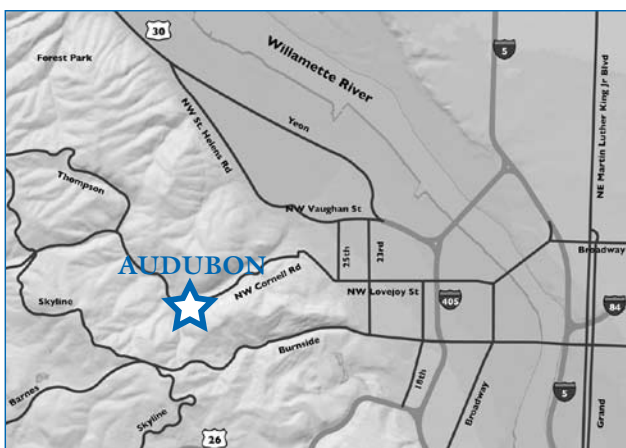

The Audubon Society of Portland is a member of Earth Share of Oregon. For more information, contact Earth Share of Oregon at 503-223-9015 or on the web at www.earthshare-oregon.org.



Board Officers

President	Jim Rapp
Vice President	Kristina Gifford
Secretary	Wink Gross
Treasurer	Candy Plant
Past President	Pat Campbell

Board Members

Tony DeFalco	Bob Liddell	Dan Rohlf
Katy Ehrlich	David Mandell	Ron Spencer
John Hammerstad	Noelwah Netusil	Julie Wilson
Barb Hill	Karen O'Connor Kruse	
Koto Kishida		

Former Board Member Emeritus - Dave Marshall (1926-2011)

Committee Chairs

Board Affairs	Kristina Gifford
Conservation	Lynn Herring
Education	Karen O'Connor Kruse
Executive	Jim Rapp
Finance	Candy Plant
Membership & Development	Katy Ehrlich
Sanctuaries	Ann Littlewood
Volunteer Council	Jill Nelson-DeBord

Staff

Executive Director	Meryl Redisch
IT Manager/Office Manager	Tammi Miller
Development Director	Ann Takamoto
Bookkeeper	Jill Hartzell
Birdathon Coordinator	Gary Slone
Membership Development Coordinator	Pam Meyers
Membership Development Assistant	Jane Christensen
Education Director	Steve Robertson
Adult Education Programs Manager	Steve Engel
Camp Director/Onsite Programs Specialist	Ian Abraham
Master Birder/Adult Trip Coordinator	Dan van den Broek
Environmental Educator	Tim Donner
Environmental Educator	Andrea Constance
Urban Naturalist	Mike Houck
Conservation Director	Bob Sallinger
Assistant Conservation Director	Mary Coolidge
Conservation Program Assistant	Nikkie West
Urban Conservationist	Jim Labbe
Ten Mile Sanctuary Manager	Paul Engelmeyer
Volunteer Coordinator	Deanna Sawtelle
Wildlife Care Center Operations Manager	Debbie Daniels
Wildlife Care Center Veterinarian	Deb Sheaffer
Nature Store Manager	Nancy Mattson
Nature Store Assistant	Marilyn O'Grady
Nature Store Clerk	Sally Loomis
Sanctuaries Director	Tom Costello
Sanctuaries Assistant	Greg Kurtz
Sanctuaries Maintenance Technician	Rick Meyers
Backyard Habitat Certification Technician	Robin Jensen
East Portland Community Coordinator	Bich Trinh

BUSINESS MEMBERS

Through their business practices and financial contributions, the following business members help Audubon Society of Portland fulfill its mission. If you would like to become a business member, please contact our Development Department at 971-222-6117.

Business Benefactor

NW Natural

Business Guarantors

Backyard Bird Shop
Portland General Electric

Business Partners

Barran Liebman, LLP
Beaverton Toyota
Columbia Sportswear
Forest Park Federal Credit Union
NatureBake & Dave's Killer Bread

Business Supporters

Enterprise Rent-A-Car
Leupold & Stevens, Inc.
Portland Audubon Nature Store

Business Friends

Bob's Red Mill
Elk Cove Vineyards
Jackson Welch Mediation/ Arbitration PLLC
Kruger's Farm Market
NePo Suet Company
Vernier Software & Technology



BEAVERTON TOYOTA



2465 N.W. Thurman, Portland, Oregon 97210
(503) 228-2106 / www.forestparkfcu.coop