



Black-throated Gray Warbler

MAY/JUNE 2011
Volume 75 Numbers 5&6

Warbler

In this issue...

Sign up for Summer Camps!
See page 7 and enclosed brochure

Richard Louv to speak at Zoo on May 11
See page 8

Birdathon begins May 1
See page 3 and enclosed envelope



Marianne Nelson (right) assists a customer © Carol Gross



Miner's-Lettuce (*Claytonia perfoliata*) © Marilyn Stinnett



Summer Camp fun! © Portland Audubon

Experience Summer Camps: The Portland Audubon Way

by Ian Abraham, Camp Director

The Audubon Society of Portland's Summer Camp programs help participants remember where they have come from by rebuilding their relationship with the natural world and renewing their confidence through outdoor skills and lessons. Our highly trained and effective staff looks to the future as we honor each camper's journey to reconnect with nature and to enjoy all that relationship offers. We strive to include truly awesome elements in each of our camps to make them unique and meaningful, infusing the Audubon Way.

Our camps are science-based and completely experiential, where problem-solving and thought-provoking challenges are presented daily. Our holistic approach allows each student to express themselves through different mediums such as crafts, poetry, skits, and music. Each program has a foundation of concept-based learning that incorporates hands-on activities throughout. We recognize that children have different learning styles and we address these by developing the camps with activities in which the students are doing, seeing, touching, smelling, hearing — and even, at times, tasting! We follow through on our camper's ideas by often letting them take the lead during hikes, activities, and lessons. This student-centered approach allows for the organic nature of the informal outdoor setting to build on the camper's individual passions and interests in the natural world, ensuring an unforgettable week of engaging adventure for each and every child.

What other organization has a camp that blends the art of survival and the scientific method like our *Fantastic Four* program? Where else, within the span of four weeks, can a 13-year-old raft down the Clackamas River with *Paddles and Boots*, search the Salish Sea on the bow of a boat for Orca whales during our *San Juan Island Adventure*, take a week off (whew!), and finally experience a night hike on the Hummocks Trail in the blast zone of Mt. St. Helens on *Fire and Ice*? Finally, if they are up to the challenge, this same camper could spend a week in the Wallowa Mountains with *Reptiles and Raptors* in search of the elusive Great Basin Fence Lizard and the ever-majestic Northern Goshawk.

Continued on page 10

15th Annual Native Plant Sale!

May 14–15, 10am–4pm

by Tom Costello, Sanctuaries Director

On Saturday, May 14th and Sunday, May 15th, the Audubon Society of Portland will host its 15th annual Native Plant Sale. Over 100 species of native trees, shrubs, herbaceous perennials, bulbs, grasses, and vines will be available for sale from 10 a.m. to 4 p.m. on both days.

As always we strive to make our plant sale as user friendly and accessible as possible by providing a cadre of native plant experts to help you select the plants that will best suit you and your property. Long-time volunteer and Sanctuaries Committee member Gregg Everhart will once again provide her assiduously prepared "shopping lists" which provide a wealth of information on all of the plants available: typical size, growing conditions, habitat value, and even the color of the flower and fruit type. You can use the shopping list to find out what will grow in that moist, shady back corner of your yard, or which plants will help you attract butterflies and hummingbirds. More comprehensive information on individual plants will be posted above plants themselves, including photographs of the plant in bloom.

In addition, the members of Audubon's Sanctuaries Committee have graciously agreed to plan and host an ongoing series of mini-workshops throughout the plant sale on the following topics:

- Why Native Plants Benefit Habitat
- How to Design a Native Plant Area
- Planting and Caring for Native Plants

Each mini-workshop will last 10–20 minutes and there will be the opportunity to ask questions of the presenters. In addition to the presenters, a team of "plant talkers" will be on hand to help answer your questions about native plants and more. In addition to all the great information on native plants, you can 'dig up' the big picture on naturescaping, rain gardens, invasive plant removal, and more. Turn your own yard into a wildlife sanctuary!

For those unsure of where to start, we have compiled a quick & simple guide to help you assess your yard or property and help you put together a planting plan. This guide (see page 8 Sanctuaries article) will help you make a brief assessment of your property. Make a sketch and take some notes, and bring them with you to the plant sale.

continued on back cover



Robbie Goldie keeps the plants watered © Carol Gross

25th Annual Great Blue Heron Week, June 1st–5th

Exploring Ross Island and Oaks Bottom Wildlife Refuge

Each year since the Portland City Council adopted the Great Blue Heron as its official city bird in 1986, the region has celebrated efforts to ensure the heron remains an icon for integrating the built and natural environments. Unlike past years when Portland Audubon and numerous other nonprofit organizations and agencies hosted events and field trips throughout the Portland-Vancouver region, this year we are focusing on Ross Island and Oaks Bottom Wildlife Refuge.

See www.audubonportland.org for event details — including the Ross Island Regatta on Sunday, June 5.



Kayakers in Ross Island Lagoon © Mike Houck

Birds & Bridges online auction — See page 5



Audubon Society of Portland
5151 NW Cornell Road
Portland, Oregon 97210

Inside this issue

Page 2 From the Director
 Nature Nights
Page 3 Audubon Outings
Page 4 & 5 Conservation
 Wildlife Care Center
Page 6 & 7 Trips & Tours & Classes
Page 8 Sanctuaries
Page 9 Volunteers & Field Notes
Page 10 New Members
Page 11 IBA of the Month
Page 12 Map/Hours/Sponsors

View this Warbler and past issues at www.audubonportland.org/about/newsletter.

From the Executive Director



Meryl Redisch

The Ultimate Multitasking

As a society, can we use technology to connect to the natural world and still get a “pure” nature-based experience? Can Portland Audubon encourage people to get outdoors while also encouraging them to capture that outdoor experience on their smart phone and share it through Facebook? Are these efforts mutually exclusive or can they be complementary and even beneficial to the environmental movement?

Portland Audubon is exploring these and other related questions and simultaneously taking advantage of new and emerging social media applications and technologies to grow our base, extend our reach, and get tangible conservation results. There may be no perfect answers or perhaps it's too soon to tell, but with 10% of national web visits and 25% of web viewers using Facebook, Audubon really needs to utilize these tools better to share our mission and promote our values to diverse audiences. We have also learned that greater numbers of people rely on their Facebook friends for their primary source of information. Regardless of whether one believes this is a good thing or not, the statistics are revealing and are prompting organizations like Audubon to take new approaches to doing business.

It may be serendipitous that, just as we are delving deeper into technology to market our mission, Richard Louv, author of the popular book *Last Child in the Woods*, is presenting his new publication, *The Nature Principle*, which he describes as an antidote to Nature Deficit Disorder. In *Last Child in the Woods*, Louv makes the case that direct exposure to nature is essential for healthy childhood development and for the physical and emotional health of children and adults. In this new book, he again draws upon research to show that reconnection to the natural world is fundamental to human health, well-being, spirit, and survival. He worries that young adults may constitute the first ‘denatured’ generation as a result of increased and ever present electronic media use. Early in this new book, Louv shares research from a University of California study about how young people’s brains can get quickly shaped by technological experiences. Louv goes on to posit a couple of views that can be seen either way: Will people who experience too much technology in the formative years have underdeveloped frontal lobes unable

to learn, remember, feel, and control impulses — or will people develop new, advanced skills that poise them for extraordinary experiences?*

A third possibility that Louv proposes is the “hybrid mind.” He explains how the hybrid mind will function: “The **ultimate multitasker** will be to live simultaneously in both the digital and physical world, using technology to maximize our powers to process intellectual data and natural environments to ignite all of our senses and accelerate our ability to learn and to feel. We can accept and celebrate our technological skills at the same time that we seek gifts of nature essential for the realization of our full intellectual and spiritual potential.”

This is the outcome that I believe in and the outcome that Portland Audubon is counting on. We already know that wonderful experiences in nature can be transformative for kids and adults. What we don't know, at least not yet, are the changes that can come when these same people share their wonderful stories through everyday technology. While we don't believe that a digital experience about nature should ever substitute for an actual experience, we hope that through the creative and appropriate use of technology, Audubon and our followers can motivate more people to get outdoors!

What you will see in the coming weeks is an enhanced website with rotating banners that feature stories about the birds in the Wildlife Care Center, volunteer activities in our sanctuaries, Raptor Cam, and the natural beauty that makes our region a remarkably amazing place. Let us know how we are doing, and thank you for your sustained support.

*Lianne George, “Dumbed Down: The Troubling Science of How Technology is Rewiring Kids’ Brains.” www.macleans.ca, Nov.7, 2008.

Author Richard Louv is Coming to Portland Wed, May 11 at 7:30pm — Free!

Oregon Zoo's Cascade Crest Meeting Room

See Nature Store Highlights on page 8 for event details.

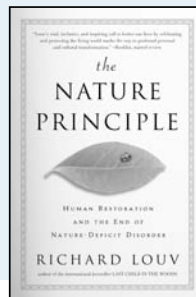

NATURE NIGHTS

Second Tuesday of the month from September to May. If you have a suggestion for a Nature Night presentation, contact Catherine at chalpin@audubonportland.org or 503-292-6855 ext. 129.

FREE and open to the public!



© Suzan Beraza

Screening of the film *Bag It*

**Tuesday, May 10
7pm Heron Hall**

Americans use 60,000 plastic bags every five minutes — single-use disposable bags that we mindlessly throw away. But where is “away”? Where do the bags and other plastics end up, and at what cost to our environment, marine life, and human health?

Bag It follows “everyman” Jeb Berrier as he navigates our plastic world. Jeb is an average American, not a radical environmentalist, who decides to take a closer look at our cultural love affair with plastics. Jeb's journey in this documentary film starts with simple questions: Are plastic bags really necessary? What are they made from? What happens to plastic bags after they are discarded? Jeb looks beyond plastic bags and discovers that virtually everything in modern society — from baby bottles to sports equipment, to dental sealants to personal care products — is made with plastic or contains potentially harmful chemical additives used in the plastic-making process.

This film remains especially timely in Oregon as the legislature continues its consideration of banning single-use plastic checkout bags. Please join us for this fun, educational, and thoughtful look at a pressing environmental issue and learn how you can be a part of the solution.

Feathers: The Evolution of a Natural Miracle

**Tuesday, June 14
7pm Heron Hall**

Normally our “Nature Night” takes the summer months off so Audubon members can enjoy the long evenings out in nature, but this year we received an offer too good to pass up, so we have a great program planned for June. Northwest author and biologist **Thor Hanson** comes to Portland Audubon's Heron Hall on June 14 at 7pm to talk about his new book *Feathers: The Evolution of a Natural Miracle* (Basic Books, \$26.99). From the unique engineering qualities of feathers that allow for flight, to their use in Vegas showgirl costumes, Hanson creates a highly readable wide-ranging natural history that explores all the facets of the feather with a graceful writing style and deeply delving research.



© Kathleen Ballard Photography

Thor Hanson is a conservation biologist, Switzer Environmental Fellow, and member of the Human Ecosystems Study Group. His first book, *The Impenetrable Forest: My Gorilla Years in Uganda*, won the 2008 USA Book News Award for nature writing. Hanson lives with his wife and son on Washington state's San Juan Island.

Peregrine Watch 2011: Come Watch Peregrine Falcons!

Peregrine Watch is an amazing opportunity to watch the fastest animal in the world hunting and nesting right in the middle of downtown Portland. Each weekend during the Spring of 2011, Audubon Society of Portland volunteers will be out along the Springwater Trail behind OMSI with spotting scopes, binoculars, and peregrine information to show you a pair of Peregrine Falcons which have made their home on the Marquam Bridge.

You can stay for as long as you want and come back week after week as these falcons move through their nesting cycle. This is a great location to watch peregrines — you can see right into the nest from the observation area!

WHEN? Every Saturday from **April 30** through **June 11** at **2pm–4pm**.

WHERE? The viewing location is on the Springwater Trail behind the Oregon Museum of Science and Industry (OMSI). Please follow OMSI parking instructions. Follow the Springwater Trail **southward** behind OMSI and look for the Peregrine Watch signs.

COST: Free — just show up!

WHAT TO BRING: Clothing appropriate for the weather, binoculars and scope if you have them — volunteers will also have viewing equipment on hand to use.

A Note on Peregrine Watching: Bring what you need to be comfortable for an hour or maybe more. Wild peregrines don't go by the clock, but the longer you stay the more you are likely to see! **Peregrine Watch will not occur in very rainy or really foggy weather.** Check audubonportland.org for updates.



Young Peregrine Falcon learning to fly at the Marquam Bridge © Bob Sallinger

And speaking of watching Peregrines, don't forget... Audubon-KGW Raptor Cam!

In mid-February 2011, KGW-TV Channel 8 and Portland Audubon launched the 5th season of Raptor Cam. Viewers who tune into KGW's website at www.kgw.com can follow the nesting cycle of a pair of Red-tailed Hawks that have nested on a downtown Portland fire escape since 2007. Thanks to a generous anonymous donation from a Raptor Cam fan, this year we've added a microphone to the system so viewers will be able to both see and hear what is going on in the nest.



Red-tailed Hawk in nest © Bob Sallinger

Audubon Outings — Wild in the City and Beyond

Bring binoculars and dress for the weather — beginners welcome!



= Birding trips starting later, going slower, with restrooms in sight



= Sign-up needed



= Fee involved

May 4 (Wed), 8am–Noon Ridgefield NWR, Washington

Join leader **Ron Escano** on a walk on the Kiwa Trail looking for rails and bitterns. The trail has been closed since October 1st so should be great birding. The trail is a flat 1.5-mile walk. Meet Ron (503-771-3454 for directions) at 8am at Ridgefield NWR's Kiwa Trailhead on the River 'S' Unit.

May 3 & 4 (Tue & Wed), 7am–4:30pm Magpies Birdathon

Please join **Denny Graham** and **Mike Skinner** for the 2011 Magpies Birdathon trips. Participants may attend one or both days (bring a lunch and water). Return time is estimated.

Tue, May 3: Meet at 7am at the Mt. Tabor Volcano Parking Lot. We will spend the early morning at Mt. Tabor focusing on songbirds, then proceed to Ridgefield NWR for the rest of the day. We will visit both units at Ridgefield to include a wide range of habitats for the day.

Wed, May 4: Meet at 7am at the Tualatin Hills Nature Park Interpretive Center, 15655 SW Milliken Way. We will spend the early morning there looking for songbirds, then proceed to Jackson Bottom and Tualatin River NWR to include a wide range of habitats for the day.

Please pre-register with Denny at 503-659-1245 home (503-351-8706 cell), or Mike at 503-590-3963 home (503-686-5126 cell).

May 16 (Mon), 8am–11am Steigerwald Lake NWR

Join leader **Ron Spencer** for a 2-mile hike at this refuge which offers a wide variety of habitats. Expect to see migrating birds as well as waterfowl and other marsh birds.

Directions: Take SR-14 east from I-205 for about 12 miles. Turn right just past the Columbia River Gorge sign just east of Washougal, WA. Meet at 8am at the refuge parking lot on the right side of SR-14. If questions, contact Ron at 503-656-5170 or rleydens@comcast.net.

May 19 (Thu), 8am–6pm+ White River Oaks and Rimrock

Interested in exploring the unique oak woodland and basalt

rimrock country of North Central Oregon? Chance to see Lewis's Woodpeckers, Ash-throated Flycatchers, Lazuli Buntings, Canyon Wrens, and Golden Eagles. We will spend most of our time on the White River Wildlife Management Area around Tygh Valley (south of The Dalles). Meet at the Outlet Mall parking lot in Troutdale at 8am and plan on an all-day adventure, getting back after 6pm. **Please pre-register** with **Ron Escano** at 503-771-3454.

May 23 (Mon) Ridgefield NWR, Carty & River 'S' Units

This walk has been canceled.

June 6 (Mon), 7am–3pm Conboy Lake NWR

Meet **Lou Fredd** at 7am at Lewis & Clark State Park (just upstream from I-84 exit off Sandy River bridge). We'll carpool to Conboy Lake NWR at the base of Mt Adams, about 1 hr. Extensive wet prairie, grassland, and dry woodland provides diverse bird life. Bring lunch and a scope if you have one, sunscreen recommended. For more information contact Louis at louisfredd@msn.com, 503-655-1856 (home), or 503-706-8173 (cell, trip day only).

June 7–10 (Tue–Fri), 8am–6pm Malheur NWR

Bird Malheur NWR with **Shawn Schmelzer** and **Mike Kaufman**. We will stay in the Malheur Field Station where you supply your own bedding (estimated cost \$250 per person). Prearranged carpool will depart Portland at 8am June 7th and will return June 10th about 6pm. **Please pre-register** by contacting shawnbirder@yahoo.com or 503-226-2523.

June 9 (Thu), 8:30am–11:30am Cooper Mountain Nature Park

Join leader **Sue Carr** for a view of the local songbirds in their best breeding plumage. For directions visit thprd.org/parks/coopermountain.cfm or call Sue at 503-649-3360.

June 16 (Thu), 8am–Noon Sandy River Delta

Join **Ron Spencer** for our annual hike at the Sandy River Delta. At this time of year, this area is home to a wide variety of species, many of which are nesting. This outing requires more hiking than most Magpie trips. **Directions:** From I-84 eastbound, take Exit 18, turn right at the bottom of the exit, loop around under the freeway, and proceed straight ahead to the parking lot and restrooms. For more information, contact Ron at rleydens@comcast.net or 503-656-5170.

June 20 (Mon), 8am–4:30pm Mt. Hood Lakes

Join the Magpies for a trip to three locations on the Oregon Cascades Birding Trail. We will visit Wildwood Recreation Area, Trillium Lake, and Little Crater Lake Meadows. Meet **Denny Graham** at the Olive Garden Restaurant on SE Sunnyside Rd across from Clackamas Town Center. We will leave the parking lot at 8am. Bring a lunch, sunscreen, insect repellent, and a scope if you have one. **Please pre-register** with Denny at 503-659-1245.

June 25 (Sat), 8am–11am Powell Butte Nature Park

Join leader **Ron Escano** for a walk exploring the unique habitats of Powell Butte. Our main objective is to see the beautiful Lazuli Bunting, as well as other species which summer there. **Directions:** Turn south on SE 162nd Ave off Powell Blvd and meet in the parking lot at top of butte.

June 26 (Sun), 8am–11am Wapato Greenway, Sauvie Island

Leaders **Gabriel Forcier** and **Robin Carpenter** will be your guides around this small lake on Sauvie Island looking and listening for songbirds and early waterfowl. Meet at 8am in the Wapato Greenway parking lot. **Directions:** To reach Sauvie Island, travel west from Portland on Hwy 30 about 15 miles to the bridge onto the island. Continue north on Sauvie Island Rd, past the intersection with Reeder Rd, past the boat ramp turnoff, to the marked parking lot on the left.

Why Not Share Birdathon 2011 with a Friend!

by Gary Slone, Birdathon Coordinator

Introduce a friend to Birdathon and share the joys of birding! Don't miss this chance to include your friends and fellow Audubon members in the 31st anniversary of Birdathon! It's a fun and easy way to build support for the Audubon Society of Portland — our own unique Audubon way to help protect native birds and their habitat. Get involved. Help make this year's event a soaring success!

Birdathon is open to everyone. **Birders of all ages and skill levels are welcome.** You can join a Birdathon team led by our top-notch staff and volunteers. You can create your very own Birdathon team. You can even participate by simply counting birds in your own backyard! Join us, count birds, and collect pledges. Registration has begun!

This year we're pleased to be featuring a new team called the Left Coast Larks, hosted by Left Coast Cellars in Rickreall, Oregon. Make a day of it... Enjoy winetasting, lunch, and great birding — all for a \$40 Birdathon pledge!



Birders in Bathtub
© Josh Cerra

Here's the complete list of exciting Birdathon trips offered this year. Visit our Birdathon website at audubonportland.dojiggy.com for the complete trip descriptions. Register there for the team of your choice, or support your favorite birder or team by making a pledge.

The Joy of Birding May 7 (Sat), 6am–10pm Paul Sullivan leads this all-day Birdathon favorite.

Lean Green Birding Machine May 7 (Sat), 7am–8pm

Join your Audubon board's past president **Pat Campbell** for a full day of birding and an evening of celebration!

Left Coast Larks May 7 (Sat), 10am–3pm

Wine tasting, lunch, and great birding at Left Coast Cellars!

The Bus Passerines May 13 (Fri), 7am–6pm

Steve Engel, Audubon Adult Education Manager, birds the Portland metro area by public transit and on foot.

Birdathon 2011 Prize Sponsors

Amenity Shoes
Annie Bloom's Books
Artists Repertory Theatre
Bijou Cafe
Birdwatcher's Digest

Cinema 21
Columbia Sportswear
Common Ground Distributors
Grand Central Baking Co.
Helen Knaupp

A-Grebe-able Bunch May 14 (Sat), 4:30am–11pm

A fantastic dawn-to-dusk birding adventure!

Feathers of Color May 14 (Sat), 6am–8pm

Birding the Hwy 26 corridor with board members **Tony DeFalco** and **Koto Kishida**.

The Twins' Twitchers May 14 (Sat), 7am–4pm

Learn from Portland's birding gurus, **Adrian** and **Christopher Hinkle**!

Marshall's Murrelets May 14 (Sat), Time TBA

Led by **Lynn Herring** and a celebrated cast of past & present Audubon board members.

Red-breasted Winesuckers May 21 (Sat), 8:30am–4:30pm

Great birding, winetasting — and designated drivers! (Wildlife Care Center volunteers only)

Gonzo Trips: 2+ days

The Roadrunners Overnight May 14–15 (Sat–Sun)

Bike Gallery and Audubon staffs bring you their 8th year of birding by bicycle!

Retailed Hawks June 7–9 (Tue–Thur)

Birding the Malheur National Wildlife Refuge with the great staff from the Backyard Bird Shops.

Imago Theatre
Kalmbach Publishing Co.
Lan Su Chinese Gardens
Leupold & Stevens
Manfrotto Inc.
Mirador Community Store
Nikon Inc.
NW Film Center

Patagonia Portland
Portland Center Stage
The Arrangement
Vortex Optics
Widmer Bros. Brewery
Yoga Shala
Zeiss Inc.

Conservation

Two Big Victories for Urban Conservation and Urban Communities

by Bob Sallinger, Conservation Director

In April two important, multi-year planning processes came to completion and were adopted by the Portland City Council with little to no opposition. The Citywide Tree Project and Airport Futures will play a major role in defining the ecological health and livability of our urban landscape over the next two decades. Portland Audubon played a major role in the three-year-long public process that developed these programs. We called on you, our members, many times during that period to weigh in to support strong natural resource protections, and your voices were heard.

Airport Futures

Airport Futures establishes a long-range development plan for Portland International Airport (PDX). The plan will define what happens at PDX over the next quarter century. In April the Portland City Council and Port Commission codified the results of this effort with the adoption of an updated PDX Master Plan and PDX Land Use Plan.

While the airport plays a primary role in our regional economic and transportation infrastructure, it also has profound impacts on our environment and surrounding neighborhoods. An Advisory Committee comprised of more than 30 environmental, neighborhood, business, transportation, and governmental interests struggled for more than three years to find solutions that addressed each of these concerns.



Government Island grassland that will be restored as part of Airport Futures
© Bob Sallinger

People do not often associate airports with wildlife, but the location of PDX — bordered on one side by the Columbia Slough and the other by the Columbia River, plus the fact that it retains some of the last grassland habitats in the area — actually makes PDX a magnet for wildlife populations. An independent panel of ecologists assembled for Airport Futures confirmed the high value of the airport for rapidly disappearing metro-area species such as Western Meadowlarks and Streaked Horned Larks as well as birds of prey.

Early in the Airport Futures Process the Advisory Committee established an important principle: the Port should not only mitigate for its impacts on natural resources but should actually help restore the landscape — in essence, Airport Futures should leave the landscape in better condition than it exists today. We are pleased to say that we believe that this high standard was achieved. The Port of Portland deserves credit for committing to achieve this high bar.

An innovative natural resource agreement provides that as PDX develops, 300 acres of degraded grassland habitat on nearby Government Island will be restored. In addition the Port will contribute \$50,000 per year for 25 years to restore habitat and plant trees in the neighborhoods that surround PDX. The Port will seek to go beyond regulatory requirements for air and water quality and will work with a standing advisory group to set annual objectives in these arenas. Careful analysis demonstrated that some of the most environmentally destructive PDX expansion projects such as a third runway would not be needed in the next 25 years and are not included in this plan. Finally, there are expanded regulatory protections for the Columbia Slough throughout the Airport District.

Getting to this point was not easy. Final adoption of the plan had to be postponed for nearly half a year while the Port worked through challenges with the Federal Aviation Administration. The FAA controls airport spending and does not recognize improving local neighborhoods that are directly impacted by airport operations as an appropriate use of airport funds. This is a fundamental institutional barrier to equity that contributes to the degraded state of neighborhoods that surround airports across the United States. In the end the FAA refused to relent, but the Port agreed to fund the neighborhood improvements through non-airport-related revenue streams if necessary. While this agreement addresses the immediate concerns of the Airport Futures process, we remain committed to pressuring the FAA to recognize mitigation for airport impacts on local neighborhoods as an appropriate use of airport funds, and we will work with Coalition for a Livable Future to pursue this issue.

Of course, these are just words on a page (many, many pages!). We have, however, a high degree of confidence in this agreement. It provides PDX with the high level of certainty and flexibility it will need to continue its nationally lauded service. The Port and City have already been assembling experts to begin preparing for the first 50 acres of restoration on Government Island. Audubon will remain actively engaged in all aspects of this project and will serve on the standing Advisory Committee that will help guide implementation.



A city in the forest © Mike Houck

Citywide Tree Project

Portlanders are passionate about their trees, and our amazing tree canopy is one of the things that sets Portland apart from other North American cities. Trees contribute to our air quality, sequester CO₂, provide habitat for migratory birds, help address urban stormwater impacts, reduce the urban heat island effect, and contribute to the livability of our neighborhoods. A growing body of literature demonstrates the important impact trees have on human mental and physical health, property values, and crime reduction. Portland has made a huge investment in recent years to plant new trees and has set an overall citywide tree canopy target of 33%. A study by Portland Parks places the annual environmental and aesthetic benefits of Portland trees at \$27 million — and the estimated replacement value of our urban tree canopy is nearly \$5 billion (Karpis et al 2007). However, our tree code was a mess!

The Citywide Tree Project began as truly a grassroots initiative. In 2005, neighbors in Southwest Portland developed a white paper identifying gaps, inconsistencies, and conflicts within the city's tree code. In 2007 neighborhood groups and Audubon successfully lobbied City Council to appropriate funds to do a top-to-bottom review of tree protections. For the past three years a committee comprised of conservation groups, neighborhood groups, arborists, and developers has been working through these issues. In April 2011, after a series of packed hearings, the Portland City Council adopted the majority of the committee's recommendations with support from conservation, development, and neighborhood interests.

The new tree code consolidates all tree-related regulations into a single code chapter and provides consistent, strong, simplified protections for trees in both development and non-development situations. It provides for increased educational outreach including a new tree manual. It also increases the city's enforcement capabilities including a 24-hour-7-day-a-week hotline to report illegal tree cutting. It recognizes that we need to protect and maintain trees just as we do other components of our urban infrastructure. It also recognizes that in order to reach the city's canopy target of 33% coverage, we must accelerate our tree-planting efforts, but the foundation of Portland's tree canopy strategy must be focused on preservation and stewardship of our existing canopy.

The city estimates that the new protections will increase establishment of at least 100 additional acres of future tree canopy per year over the existing code. Finally, the new code creates mechanisms to ensure that trees will be planted and protected in Portland's densest and least-treed neighborhoods.

At approximately \$150,000 of ongoing annual costs (after tree-related fees are deducted), the Tree Improvement Project represents a remarkably cost-effective program and will provide a tremendous return on investment. Between 1972 and 2002, Portland's urban canopy increased by a total of 1.2%. At this rate it would take another 169 years to add the additional 6.7% necessary to achieve Portland's canopy target of 33% coverage. This proposal sets Portland on a more ambitious trajectory, one that is necessary to maintain a sustainable and livable urban landscape.

Senate Bill 766: An Unprecedented Attack on Our Neighborhoods and Our Environment

by Bob Sallinger

We need your help to stop Oregon Senate Bill 766 — a bill we consider one of the most serious threats to urban conservation efforts and urban communities in years. The legislation was developed behind closed doors with industrial interests such as the Portland Business Alliance, Portland Working Waterfront Coalition, Port of Portland, and AFL-CIO at the table. The bill was originally described as an effort to prevent industrial lands from being converted to other uses and to speed up permitting for high-priority industrial projects. What emerged into full public view in late February, however, was something quite different.

SB 766 allows entire industrial landscapes to be permanently declared "regionally significant industrial areas" without the support or approval of the local

government. Once an area receives this permanent designation, the local jurisdiction would be required to abandon its existing permitting process and substitute a new process prescribed by the bill itself. Key features of the new permitting process include the following:

- Local jurisdiction would be severely restricted in its ability to enact new environmental regulations on lands designated at "regionally significant industrial areas."
- All industrial permit applications would have to be decided on a very short timeline, functionally preventing outside organizations from effectively reviewing and commenting on these applications.
- The local jurisdiction would be categorically prohibited from holding any public hearings for industrial development permits.
- Notice of permit applications would be limited to

only property owners within 100 feet of the applicant, jurisdictions providing services, and the local neighborhood association if the project fell within its boundaries. Adjacent neighborhoods, individuals, conservation groups, and other watchdog groups would no longer receive notice.

- Appeals would go directly to state courts rather than to the Land Use Board of Appeals, and the basis for contesting permits would also be severely restricted.
- SB 766 also sets up a state-level "Economic Recovery Review Council" that could also expedite permitting of projects of "statewide significance." The local jurisdiction would have to approve sending the project to the Review Council. Decision by this council could only be appealed on the basis of unconstitutionality or corruption in the permitting process.

It is no wonder that Mayor Sam Adams, in an *Oregonian* article dated March 19, 2011, referred to SB 766 as "Armageddon," a "catastrophe," "the biggest overreach

Continued on page 5

Lights Out Portland!

by Mary Coolidge, Assistant Conservation Director

You don't have to be an avid birdwatcher to be cheered by the ubiquitously singing robins that herald spring. And other familiar migrants are returning too: Orange-crowned Warblers, Western Tanagers, and Swainson's Thrushes are just a few of the many species that migrate remarkable distances, often moving under the veil of night. Just after sunset, many birds begin a nightly journey from their wintering grounds as far south as South America to their breeding grounds as far north as the Arctic tundra. Traveling at night allows them to avoid predators, save energy by flying when the atmosphere is less turbulent, use the moon and stars as guides, and forage by day, a necessity for replenishing the vital energy stores that fuel their incredible migrations.

But night flight also makes them susceptible to fatal light attraction as they pass over ever-expanding urban areas across the landscape. Researchers have calculated that 85% of annual mortality in songbirds occurs during migration. Birds' already perilous journeys are made even more deadly by night-lit structures, which confuse and attract them. More and more research suggests that hundreds of millions (and perhaps over a billion) birds die every year after hitting windows, both during the day and at night. Fortunately, there are solutions to both problems.

Portland Audubon has initiated a "Lights Out" campaign, joining 21 other U.S. cities that have instituted Lights Out programs. Lights Out participation is voluntary and



Photo © Mary Coolidge

seasonal. Buildings are asked to extinguish unnecessary overnight lighting from late August through mid-November (fall) and mid-March through early June (spring). Top priority is turning off rooftop architectural lighting. To comply, buildings can also extinguish interior lighting on upper floors, move maintenance and cleaning activities to daytime hours, turn off upwardly directed sign lighting, and make sure outdoor lights are properly shielded. Turning off unnecessary overnight lights and pulling shades are easy ways that we can contribute to the solution while also measurably saving both money and energy! Lights Out programs do not affect street lights or safety lighting, though we do advocate for proper shielding to reduce skewing the circadian rhythms that drive migration, breeding, and feeding cycles, and influence predator-prey relationships.

Lights Out Portland is funded by a \$10,000 Together Green Fellowship from National Audubon and Toyota. We continue to gather data on window strikes, and our 3rd full season of BirdSafe Portland surveys are under way, with 22 new and returning volunteers on the hunt for birds that have struck windows. We have turned up 26 native species of strike fatalities, with well over 70 species brought into our Wildlife Care Center after striking windows on homes and highrises.

Building owners and managers are encouraged to sign up for Lights Out on our website, and anyone can participate. For more information on Lights Out Portland and our BirdSafe initiatives, visit www.audubonportland.org/issues/metro/bsafe/lo.



Damascus residents will have the best chance of protecting the wildlife habitat and cool, clean waters of the Clackamas River by voting Yes on Measure 3-375 on May 17th. © Mike Houck

Damascus May 17 Election Alert: Vote Yes on Measure 3-375

by Jim Labbe, Urban Conservationist

On or before May 17, the Audubon Society of Portland urges our **Damascus members and neighbors to vote Yes on Measure 3-375**. Damascus has some of the most important and irreplaceable natural resources anywhere in the region, including the headwaters of Johnson Creek and the Clackamas River. Vote Yes on Measure 3-375 to protect these natural features and to keep the Comprehensive Plan as adopted by the Damascus City Council in December 2010.

Go to tinyurl.com/4xj2ffb for more information.

Continued from page 4

I have seen in all my years in city government," and "an environmental wolf in sheep's clothing." Unfortunately, SB 766 is reflective of a nationwide trend of using the recession as an excuse to gut environmental laws and reduce public oversight of industrial projects — a truly ironic outcome given that the recession itself was caused by a lack of regulatory oversight of the financial sector that then behaved recklessly and plunged our country into the worst economic crisis since the Great Depression.

A wave of opposition generated by Portland Audubon and others has turned a bill once considered "unstoppable" into one of the most controversial bills of Oregon's legislative session. Proponents of SB 766 have been scrambling to modify some of the most egregious elements of the bill, and the bill is now in its 14th round of amendments. Proponents argue that the current version (described above) is not as bad as earlier versions, and they are right. The original version of SB 766 was actually even more antagonistic toward public process and environmental

protections than the draft described above. However, the measuring stick by which any draft of SB 766 should be measured is not the abysmal first draft, but rather the existing rights and processes our communities enjoy today. Viewed from that perspective, SB 766 remains an appalling rollback of public process and an unprecedented restriction on the rights of local communities to regulate industrial lands.

Our industrial lands often overlap with some of our most important natural resource areas. This bill directly jeopardizes places like the Willamette and Columbia Rivers, the Columbia River Gorge, and our coastal bays and estuaries. It purposely seeks to cut local communities located near these industrial areas out of the decision-making process.

Audubon would support a bill that restricts rezoning of industrial land for other purposes such as commercial and residential development. We would also support legislation that seeks to coordinate local, state, and federal

BIRDS & BRIDGES
Online Auction

Auction Opens: Tuesday, April 19, 2011, 7pm
Auction Closes: Friday, May 6, 2011, 7pm

To celebrate the amazing recovery of the Peregrine Falcon, we are offering experiences that promise to excite, thrill and chill. Peruse amazing "once-in-a-lifetime" auction items and raise funds for Audubon's Wildlife Care Center and Peregrine Recovery work.

Glider Ride
Wildflower Walk
Vacation Homes

Tree Climbing
Owl Prowl
...and more!

Register and bid heartily at
paulubonauction.dojiggy.com



Now at the Nature Store — commemorative Birds & Bridges T-shirts in men's and women's sizes for \$20. Proceeds fund the Wildlife Care Center and Audubon's Peregrine Recovery Work.

Wildlife Care Center

Needed: Homes for Domestic Ducks and Geese!

by Deb Sheaffer, Wildlife Care Center Veterinarian

Do you have a private pond on your property or an appropriate area to house a duck or goose? Portland Audubon is looking for good permanent homes for a deluge of domestic ducks and geese that are brought to our Wildlife Care Center.

Each year Audubon is brought dozens of domestic ducks and geese that have been abandoned at local parks and natural areas. These ducks and geese have been bought at pet stores and feed stores, then set free when they became too messy, too noisy, or just no longer wanted. As a result many of our local parks such as Laurelhurst, Westmoreland, and Commonwealth Lake are literally overrun with domestic waterfowl. The crowding leads to all kinds of problems including disease, habitat and water quality decline, attracting predators, and aggression between the ducks themselves.

Throughout the spring and summer Audubon receives a steady stream of injured domestic ducks and geese and orphaned domestic ducklings and goslings — last year we saw well over 100! Rather than send these birds back to parks that are already overcrowded, we try to find them permanent homes with private landowners who have appropriate facilities to give them a healthier, happier life.



Please give this duck a better place to swim than our sink!
© Portland Audubon

Please contact us if you have a private pond or an appropriate area on your property for one of more of these birds. Contact Dr. Deb Sheaffer at dsheaffer@audubonportland.org.

permitting for industrial projects in a manner that is inclusive rather than exclusive. Both of these elements were included in the Portland River Plan that is currently being challenged by industry. We will never support legislation, however, that restricts the ability of local communities to protect their environment and cuts local communities out of the decision-making process. We will also never buy into the patently false notion that we need to sell out our inner city in order to protect farmland.

Public opposition has slowed Senate Bill 766 down and led to some modifications, but it is still on track for passage. Please help us stop SB 766 by contacting the governor's office and letting them know that SB 766 is bad for our environment and bad for our communities. Online: governor.oregon.gov/Gov/contact.shtml Governor's phone: 503-378-4582 (this is a message line)

Please also check Portland Audubon's website for regular updates as this bill moves through the legislative process.

Educational Trips

These trips are popular. We recommend that you book early. Trip deposit required to secure your place on the trip.

A portion of your fee is a tax-deductible donation to the Audubon Society of Portland. View more International and Domestic trips at www.audubonportland.org/trips-classes-camps/adult.

Jamaica!

January 19–29, 2012

Escape the cold dark days of winter and join Portland Audubon on this 10-day excursion into the heart of the Caribbean and onto the island of Jamaica.

Beaches of endless white sand... warm, turquoise-blue water... unforgettable sunsets and the hot tropical sun — these are not all that await you on this island paradise: Jamaica is also home to no less than **28 endemic species of birds**, making it a paradise for birders as well.

We begin our trek in **Montego Bay**, where we'll team up with the trip co-leader and president of BirdLife Jamaica, Ricardo Miller. We'll then travel to a nearby bird sanctuary that specializes in providing visitors with up-close views of some of the island's most interesting inhabitants. The **Red-billed Streamertails**, **Grassquits**, and a host of other species will come to the feeders, so close you'll be tempted to reach out and touch them. We'll then travel south where we'll spend our first night in the coastal town of **Negril**, famous for its seven-mile stretch of beach. You'll have time to stroll on the sandy shore and swim in the warm, gentle surf before we head out early the next morning on our circumnavigation of the island.



Red-billed Streamertail.
Photo: Dominic Sherony

After leaving Negril, we team up with Dr. Ann Hayes-Sutton, the author of *A Photographic Guide to the Birds of Jamaica*, and head toward her historic estate called Marshall's Pen, birding local hot spots like the Royal Palm Reserve and the Great Black Morass along the way. We'll spend two nights and three days in Ann's company, birding local areas in search of endemics like the **Jamaican Lizard Cuckoo**, the **Chestnut-bellied Cuckoo**, and **Jamaican Owl**, to name just a few. We then head to the **Blue Mountains** on the east side of the island,

but not before searching the Portland Ridge area for the **Bahama Mockingbird** and the **Jamaican Crow**. Once in the highlands of the mountains, we'll keep an eye out for montane endemics like the **Blue Mountain Vireo** and the **Crested Quail-Dove**.

From the Blue Mountains we head to the NE coast, where we'll spend the next three nights enjoying stunning views from our private cabins nestled in along the rocky shoreline. Our hotel has its own beautiful sandy cove for its guests, allowing us to swim and relax between outings. From here we are strategically located to bird the famous **Ecclesdown Road**, where we should be able to "clean up" on any of the endemics we may have missed, including the unique — and extremely cute — **Jamaican Tody**.



Jamaican Tody. Photo: Dominic Sherony

You'll be sure to have time to shop for souvenirs or swim in the Caribbean one final time while in **Ocho Rios**, the town where we'll stay our last night before heading back to Montego Bay to fly home. We've designed this trip to give you a chance to escape the wet winter, while adding a host of new birds to your repertoire. Twenty-eight is an impressive number of endemics for any island, and we can just about guarantee to get them all!

Fee: \$2,595 members / \$2,895 non-members

Deposit: \$1,250 required to secure your place

Group size: 14 participants + leaders

Leaders: Steve Robertson, Education Director, and local guides

Fee is based on double occupancy and includes all lodging, ground transportation, all meals *except some dinners*, all guide fees, park fees, planned group activities, etc. **Not included:** Airfare to & from Portland, some dinners, and tips for guides. *Remember, a portion of your fee is a tax-deductible donation to the Audubon Society of Portland.*

Birding Washington

Aug. 29 – Sept. 2, 2011

Late summer is a great time to visit the coast and mountains of Washington. Many species of gulls, terns, and shorebirds can be found along the coast feeding on the abundant food while they gather strength to continue their journey south. In the mountains small mixed-species hunting parties move through the forest, feeding on the late summer seeds and insects in preparation for their migration.

Our tour begins along the rich estuaries of Willapa Bay and Gray's Harbor and on the beaches of coastal Washington. During late August the southbound migration will be well under way, with flocks of shorebirds staging at traditional sites where we should encounter impressive numbers of **Marbled Godwit**, **Short-billed Dowitcher**, **Western** and **Least Sandpiper**, plus possible **Pectoral** and **Baird's Sandpiper**, to name a few. This time of year is also good for more unusual birds that may show up such as **Bar-tailed Godwit** and **Buff-breasted Sandpiper**. We'll keep an eye out for the occasional **Parasitic Jaeger** strafing the gulls to steal a morsel of food while we search for loons, ducks, and shorebirds migrating offshore. After a few days of enjoying the maritime climate we head east to the mountains. We'll take a ferry across Puget Sound and look for **Rhinoceros Auklet** and other alcids along the way.

Along the border of Canada lofty rugged peaks, cut by ancient glaciers, line the horizon — the North Cascades. Large carnivores such as **Grizzly Bears**, **Wolverines**, and **Wolves**, though rarely seen, still call these mountains and forests home. We'll spend extra time birding the subalpine slopes searching for **Northern Pygmy-Owl**, **Pine Grosbeak**, and **Boreal Chickadee**. There may still be some great wildflowers to see in the alpine meadows while we search for **Horned Lark**, **American Pipit**, and **Gray-crowned Rosy-Finch**. If you would like more information, call **Dan van den Broek** at 503-292-6855 ext.105.

Fee: \$795 members / \$895 non-members

Deposit: \$400 required to secure your place

Group size: 9–14 participants

Leader: Dan van den Broek

Fee is based on double occupancy and includes all lodging (four nights), all ground transportation and ferry ride, all meals *except dinners*, and the services of your expert leaders.

AUTUMN ON Steens Mountain

3 spaces remaining!

October 5–9, 2011

Steens Mountain is one of Oregon's most spectacular natural areas and is beautiful in the fall. Rising to almost 10,000 feet high in the southeast corner of the state, it presides over alkali desert, oceans of sagebrush, and the wildlife-rich marshlands of the Malheur basin. From our base in Frenchglen, we'll spend three full days exploring this diverse landscape by van and on foot as we venture around all sides and on top of the mountain itself. On past trips we've seen approximately 80 species of birds including **Townsend's Solitaire**, **Mountain Bluebird**, **American Pipit**, **Horned Lark**, **Northern Goshawk**, **Golden Eagle**, and **Prairie Falcon**. We search for and often spot **Bighorn Sheep** along the high peaks of the mountain, sometimes distant and sometimes near. **Coyotes** and **Mule Deer** are often sighted and you never know when a **Porcupine** is going to waddle into view. Conditions permitting, we will venture out to Borax Lake, home of the unique and endangered **Borax Lake Chub**, and we'll visit the Alvord Desert.

Fee: \$695 members / \$795 non-members

Deposit: \$400 required to secure your place

Group size: Limited to 14 participants

Leader: Steve Engel

Fee is based on double occupancy and includes all lodging (four nights at the Frenchglen Hotel), all ground transportation, all meals *except dinners*, and the services of your leaders.

Fall Birding on the Northern Oregon Coast

September 11–16, 2011

Join us for our annual Road Scholar program as we search for shorebirds, raptors, waterfowl, seabirds, and songbirds from Sand Lake to Seaside. We stay at the lovely and comfortable Twin Rocks Conference Center and spend our days exploring sites such as Oswald West State Park, the Necanicum and Nehalem River estuaries, Cape Meares, Lookout Point State Park, and Sand Lake (where we discovered and reported the Northern Wheatear in 2009!). All meals and ground transportation provided.

Fee: \$618 double occupancy

To register, contact Road Scholar at 1-800-454-5768 and inquire about Program #4894RJ.

Malheur Foray

May 18–22, 2011

Join us on a 5-day birding excursion to Malheur National Wildlife Refuge!

Fee: \$695 members / \$795 non-members

Two spaces left!



American Avocet © Greg Gillson

HOW TO REGISTER Choose one of 3 ways to register for Adult Classes:

1. Register and pay online: Visit class description at www.audubonportland.org/trips-classes-camps/adult and follow registration link.

OR: Contact Steve Engel via phone or email to be put on the roster. If class has limited enrollment, wait for confirmation and then...

2. Mail in your check: make payable to Audubon Society of Portland. Include with payment: class name, your name(s) and, if this is your first class with us, your full contact information.

3. Credit card payment: Call Steve Engel (971-222-6119) or our Nature Store (503-292-WILD) to pay over phone. We accept VISA, MasterCard, and Discover (3% fee charged).

Contact Steve Engel, Adult Education Manager, at sengel@audubonportland.org or 971-222-6119.



Western Tanager © Paul Buescher

Finches, Tanagers & Buntings

May 17 (Tue), 7pm–9pm in Heron Hall

Join local bird expert and author **Harry Nehls** to learn about colorful songsters like the Purple Finch, Western Tanager, and Lazuli Bunting. Harry will cover their behavior, how to recognize different species, and where to look for them. Harry is co-author of several regional birding books including *Birds of the Willamette Valley Region*.

Fee: \$10 members / \$15 non-members

Free to active volunteers.

Birding By Ear in June!

June 6 & 20 (Mondays), 7pm–9pm: CLASSES in Heron Hall

June 12, 19, 26 (Sundays), 7am–10am: FIELD TRIPS

Laura Whittemore offers her popular Birding By Ear class one more time in 2011! June is still a time of bird song, but there are lots of other sounds being made as well. Many birds are in nesting and family mode so the pattern of singing may be different, the song different, the reasons different! Plus we'll listen for all the contact calls, begging chick calls, etc. This class is sure to open your eyes even more to the many ways and reasons why birds vocalize.

Fee: \$75 members / \$85 non-members

Class size limited to 14 participants

Open Country Birds (Crows, Blackbirds)

July 19 (Tue), 7pm–9pm

This evening class is a great introduction to birds of open habitats and is appropriate for nature lovers and birders of all skill levels. Through lecture and slides, **Harry Nehls** — co-author of several regional birding books including *Birds of the Willamette Valley Region* and *Birds of Interior BC and the Rockies* — will cover Crows, Ravens, and Blackbirds. The corvid family is a fascinating group of birds, including the jays, ravens, and magpies. The Blackbird family is represented by a variety of species in Oregon. Discover the unique Tri-colored Blackbird, the Western Meadowlark (our State Bird), and many more!

Fee: \$10 members/
\$15 non-members

Free to active volunteers.



Western Meadowlark © BjornFredrickson.com

Portland Audubon's School of Birding

We are now accepting registrations for the 2011–2012 School of Birding. Limited space remains in Fall 2011, Winter 2012, Spring 2012, and Summer 2012 Quarters. You may now enroll in one or all four quarters.

Each quarter's curriculum consists of 6 classes of identification and natural history of Pacific Northwest birds, 4 local field trips (via carpool), and an **optional** 3-day, 2-night excursion to a seasonally appropriate birding hot spot (van transportation and hotel lodging included in fee).

Please note: This program is offered at a discounted rate as we expect participants to volunteer at Portland Audubon a minimum of **8 hours** for each quarter enrolled. There are a number of fun and exciting ways in which you may volunteer, and it is completely up to you how you choose to contribute your time.

This program fills quickly, so please sign up early if you are sincerely interested. We do our best to meet demand, but class will be limited to a maximum of 16 participants to ensure quality birding experiences and instruction in the field.

Fee per Quarter: \$495 (includes \$20 transportation fee for overnight option)
\$475 (if you choose **not** to participate in the overnight outing)

Group Size: Limited to 14–16 participants

Instructor: Dan van den Broek

For more information or to register, contact

Dan van den Broek at

dvandenbroek@audubonportland.org or 971-222-6105.

View these and additional adult classes at www.audubonportland.org/trips-classes-camps/adult.

Keeping kids in touch with nature!

Audubon Society of Portland's

Summer Camp 2011

Here are just three of our incredible camps:



The Olympic Peninsula Adventure

Grades: 6th–8th

June 26 – July 1 (Sun–Fri; overnight 5 nights)

Travel into a land of rugged coastlines and mysterious forests, and discover a world seemingly forgotten by time. You'll explore tidepools teeming with life and walk on beaches few feet have ever trodden upon. You'll go in search of the remains of an ancient village of Native Americans who lived off the Sea, and learn the techniques these brave people used to hunt the largest of all prey: the mighty whale. We'll even visit the lonely town of **Forks**, made famous in the *Twilight* movies, and check for any of those completely mythical, but still scary, vampires! We'll be camping in our own private site on the beach, and we'll experience several of the **Olympic National Park's** very finest hiking trails and beaches. Between our studies of Marine Biology, the massive trees of the old-growth forest, and the ways of the Makah tribe, we'll find plenty of time to play on the beach, dig in the sand, and sing around the campfire.

Depart/ Return: 10am Sunday/ 4:30pm Friday

Meeting location: Upper Macleay Park

Fee: \$395 members/ \$415 non-members

Trip Leader: Steve Robertson, Education Director

Fantastic Four

Grades: 6th–8th

July 25–29 (Mon–Fri; overnight 4 nights)

Can you blend two worlds, one that centers on the art of survival and the other that delves into the scientific method? Are you willing to answer the call of the wild to gather together the "Fantastic Four": **Shelter, Water, Fire, and Food**? Join us for a week spent in Audubon's **Joe Miller Wildlife Sanctuary** and **Marmot Cabin** near Mt. Hood, where primitive skills and modern scientific techniques are melded into one fantastic experience. Participants will work with various plants to make fire, while studying those plants' properties and understanding their place in the ecosystem. We will take each of these fantastic four survival needs and study them from modern and ancient viewpoints. This will include habitat surveying and journaling with debris hut construction, water quality testing with water-related scavenger hunts, and animal adaptations with archery and animal tracking. Will you accept this challenge? Can you blend the new and old, the ancient with the modern? If so, you'll become closer to nature than you may have thought possible.

Depart/ Return: 8:45am Monday/ 4:15pm Friday

Meeting location: Upper Macleay Park

Fee: \$345 members/ \$365 non-members

Fire & Ice: A Circumnavigation of Mt. St. Helens

Grades: 6th–9th

August 21–26 (Sun–Fri; overnight 5 nights)

Join experienced Naturalists from the Audubon Society of Portland on an incredible weeklong journey around Mt. St. Helens. You'll explore the mountain as few ever do, investigating many intriguing areas that lie off the beaten path. Learn the geology of this fascinating volcano inside and out as you traverse trails within the Blast Zone and negotiate the challenging upper route of the Ape Caves. Witness for yourself the aftermath of the catastrophic eruption of 1980 and see how the area's rapid regrowth is astounding scientists all over the world. You'll visit the legendary Spirit Lake and hike the trails of Lava Canyon, all the time experiencing geology in such a way that will forever allow you to read the stories that the rocks have to tell. Just bring your camping gear and get ready for a week of nonstop, action-packed adventure!

Registration for this camp is through Saturday Academy.

Go to www.saturdayacademy.org to register or call 503-200-5858 with questions.

Depart/ Return: 9am Sunday/ 4:30pm Friday

Meeting location: Upper Macleay Park

Fee: \$425 members/ \$425 non-members

See the Summer Camp insert in this issue of the *Warbler* — and go to audubonportland.org/trips-classes-camps/camps/summer for more information.

Nature Store Highlights

by Sally Loomis, Book Buyer

Author Richard Louv Coming to Portland

Wed, May 11 at 7:30pm — Free!
Oregon Zoo's Cascade Crest Meeting Room

"The more high-tech we become, the more nature we need."
— Richard Louv

Audubon Society of Portland is excited to present author Richard Louv in an exclusive Portland appearance on **Wed, May 11 at 7:30pm**. This free event will be held in conjunction with the Oregon Zoo and be located at the Zoo's Cascade Crest meeting room.

A long-time journalist and nature writer, Louv came to prominence in 2005 with the publication of *Last Child in the Woods: Saving Our Children from Nature-Deficit Disorder* (Algonquin Books, \$14.95), a book that directed widespread popular attention at our children's increasing loss of contact with the natural world. Coining the term "nature-deficit disorder" to describe the problem, he kick-started a growing movement to emphasize environmental education, including the legislative efforts of "No Child Left Inside."

His new book, *The Nature Principle: Human Restoration and the End of Nature-Deficit Disorder* (Algonquin Books, \$24.95) focuses on adults and the healing effects of nature on frazzled modern lives. It is a call to action to combat the dehumanizing aspects of modern life by getting us back in touch with the natural and physical world. Louv backs this up with copious research from medicine, psychology, education, and other fields. Intermingled are compelling anecdotes and interviews from people across the country, including Portland Audubon's own Mike Houck. The book weaves together



Richard Louv

Join us in welcoming Richard Louv back to Portland, for what should be a provocative and inspirational discussion. Admission to this free public event is on a first-come basis. We're expecting a big turnout, so be sure to get there early! If you'd like to reserve a book ahead of time, please call the Nature Store at 503-292-9453. We'll have lots of books on hand for him to sign after his presentation.

"In The Nature Principle, Rich Louv has given us once again exactly the book we most need, for now and for all time."

— author Robert Michael Pyle

many conservation and education concerns our organization shares with Louv, such as the role of urban wildlife, developing our backyards as wildlife habitat, and learning to expand our sensory awareness by spending time outdoors.

"Some of the barriers separating people from the rest of nature are self-imposed, others created by media or the commercial world. That will continue, but we can resist; we can tune down the decibels, turn down the lights, and turn on the senses."

— Richard Louv

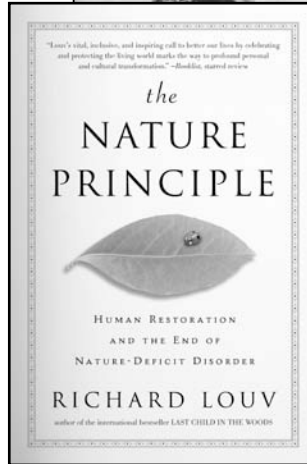
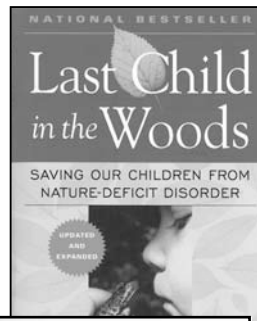

Nature Store Note

Cornell Lab of Ornithology has announced big price reductions in their CD sets of bird songs from around North and South America, so we're slashing prices on our CLO stock during May and June. Please look for some great deals here in the Nature Store!

Audubon Society of Portland gratefully acknowledges these thoughtful gifts:

In Memory

- | | |
|--|---|
| Joyce Becker
Doris Cleary | Jeff McKey
Anita McKey |
| Eleanor P. Cox
Tom & Christine Russell | Patrick Murphy
Welch Allyn
Eric Meslow of Timbercon
Gerry Snell |
| Patrick V. Davis
Pamela Eros | Jack Poff
Shirley Barron |
| Barbara Gullette
Judith Stevens | Catherine Shaar
Cindy & Dan Kuhn |
| Lisa Gullette
Joan Duckering | Demaris Sherwood
Rachel Kyriss |
| Ann Jamison
Steve Driscoll
Mary Grams
Marleen Yann | Bob Yearout
The Dover Family |
| Kay Lally
Brenda Brady
Karen Tatone | |

In Honor

- | | |
|--|-------------------------------------|
| Troy Clark
Harry & Claudia Bray
Michael Hall & Margaret Valenti
Nancy Porter
Judy Steinberger
Elinor & Roger Zener | Wren Monroe
Heh Shin Kwak |
|--|-------------------------------------|

You can honor a special person with a gift to Audubon Society of Portland. Your gift will help fund a future of inspiring people to love and protect nature. You can make an Honor or Memorial gift online at www.audubonportland.org or by calling 971-222-6129. A songbird card acknowledging your thoughtful gift will be sent to the honoree or family.

Sanctuaries News

Assessing Your Property and Planning for Native Plantings

by Tom Costello, Sanctuaries Director

Boasting over 100 species of native trees, shrubs, ground covers, grasses, and wildflowers, our **Annual Native Plant Sale on May 14th–15th, 10am–4pm** (see page 1) offers an impressive selection of plants. For those without a lot of experience in naturoscaping, however, the selection can be a bit overwhelming. To help make the plant sale as user friendly as possible, we have put together this quick & simple guide to assessing your property; follow the instructions below to make a quick sketch of your property and make notes of the relevant conditions that would affect what plants will grow best on your property. Bring your sketch to our Native Plant Sale, and our volunteer plant experts will help you make informed plant selections based on the specifics of your property. To show you how foolproof it is, this fool created his own sketch in about 15 minutes.

When assessing and planning for native plants, the old saying really is true: A picture is worth a thousand words. Making a quick sketch of your property and including any significant structures, trees, and planned usage areas (such as your vegetable garden, kids' play areas, doggy-doo space), will provide almost all of the information necessary to assess your property and decide what plants will best suit your needs. Indicating which area is north, what areas get soggy when it rains, slope, and a few other useful bits will round out the picture and make selecting your plants a snap.

And remember, when sketching your property, a quick sketch is fine; this does not need to be an engineer's drawing. Some of the coolest yards I've seen have been planned out on a coffee shop napkin.

Start by sketching the outline of your property.

As the do-it-yourselfer you can simply pace out the dimensions of your property, assuming the average person walks 2½–3 feet with each step. Take a look at this quick, simple sketch I did of my friends' house; it took 10 minutes, and I only used a ruler to get started with the property outline. Everything else is hand drawn.

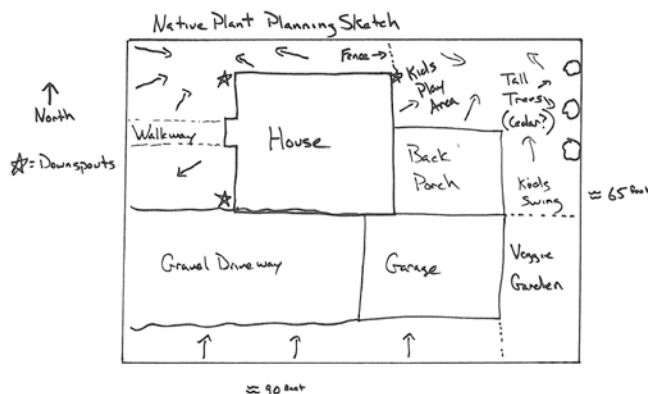

- Sketch in any structures such as your house, garage, shed, workshop. Indicate your driveway, walkway, sidewalks, etc.
- Sketch in existing trees and shrubs.
- Sketch in any existing or planned usage areas (veggie garden, kid area, dog area, etc.).
- Indicate any downspouts from gutters and whether the downspouts drain to your yard or to the sewer.
- Indicate any high or low areas, especially depressions that collect water or get soggy in the winter. You can also show arrows to indicate any areas on a slope. Use arrows pointing downhill — this will show the direction water will fall when it rains.
- Indicate any known utilities, such as septic fields or buried oil tanks, which might affect your planting plan.

For the more tech-minded person, the following two websites provide maps — and a whole lot more information on your property:

- portlandmaps.com
 - oregonmetro.gov/index.cfm/go/by.web/id=1055
- Enter your address into either website and you'll see options to bring up a map of your property. Note that the top of the screen on both websites indicates north; you'll want to indicate north on your sketch, as this helps show where the sunny and shady spots are most prominent.

That's it, pretty simple. You can make a few copies of your sketch so you can try out different ideas when planning for a native plant area. And remember to bring your sketch to our Native Plant Sale on May 14 and 15 so our plant experts can help you figure out what plants are best for you.

Wish List & Thank You's

Thank you to:

- Patricia Ball for a 2.81-qt bottle of Dawn detergent, two 182-oz bottles of Clorox, and three pairs of welding gloves for the Wildlife Care Center
- Jim Cruce for a photo book with 205 4x6 prints, an 8x10 meadowlark print, a 4x6 meadowlark print, and a wildlife DVD
- Ann Littlewood for ten 1-gallon pots of *Fritillaria affinis*
- Alan Locklear for a Samsung Syncmaster 712n 17" LCD monitor
- NePo Suet Company for a hand truck to use in the Nature Store
- Doug Robberson for a Bogen Tripod, Bogen Head, and a Bogen carry strap
- Ginnie Ross for astroturf, heating pads and refreshments for training workshop
- Jean Schoonover for a 6x9 outdoor mat and a rotating surge tap outlet
- Rosemary Shiolas for a pair of Minolta 8x40 binoculars
- Paula Squire for 24 bottles of bleach for the Wildlife Care Center
- John Weglarz for six field guides and travel guides

Our Wish List:

- | | |
|---|--|
| For Education:
Laptop computer
Powerpoint Projector
Flat Screen Monitor | For Sanctuary:
Loppers
Hand saws
Work gloves |
|---|--|

For Wildlife Care Center:

- Science Diet Kitten Growth • Bleach
Dawn Dishwashing Detergent • Camper/Trailer
Untreated Wood: 2x4, 4x4, 4x8

If you can donate these items, please first contact Audubon Society of Portland at 503-292-6855 ext. 102, Mon-Fri, to arrange a time for delivery/pick-up.

Winter Sparrows Abound on Sauvie Island

While checking out the sparrow flocks in the hedges along Rentenaar Road on Sauvie Island February 12, David Leal found a **Harris's Sparrow**. Other birders wishing to see the bird soon spent hours checking the flocks, even spreading birdseed in the area.

By early April ten species of sparrows were attracted to the seed. **Song Sparrows**, **Golden-crowned Sparrows**, and **Oregon Juncos** were the most common species seen. In addition there were two **Fox Sparrows**, two **White-throated Sparrows**, six **White-crowned Sparrows**, two **Lincoln's Sparrows**, two **Spotted Towhees**, and a **Chipping Sparrow**.

The two **Fox Sparrows** were one of the gray-type subspecies. Both Puget Sound and Gambel's White-crowned Sparrow subspecies were noted. **Swamp Sparrows** and **Savannah Sparrows** are known to be in the area but were not attracted to the seed.

The hedges radiating from Rentenaar Road have long been known to be a major wintering area for many species. When driving down the road good numbers of **House Finches**,

Sightings

On February 8 Steve Halpern reported an immature **Golden Eagle** along Rentenaar Road. It remained into April. On March 31 an adult **Golden Eagle** joined the immature. Lars Norgren saw another immature **Golden Eagle** March 23 at the Hillsboro Airport. Lars also reported a **Goshawk** at Banks that day.

On February 27 three **Cinnamon Teal** and three **Blue-winged Teal** were together on a small slough in Scappoose Bottoms. Andy Frank reported 20 **Canvasbacks** on Sauvie Island February 4 and Steve Nord saw 30 at Fernhill Wetlands February 11. These may be the same birds, as there is a regular interchange between Sauvie Island and the Fernhill area.

The spectacular waterfowl gathering on the Columbia River extended into the spring. On March 7 Grant Canterbury spotted a male **Tufted Duck** among a scaup flock near the I-205 Bridge and David Mandell saw two **White-winged Scoters** March 19 near the Portland Airport.

Up to three **White Pelicans** were seen in the Portland area throughout the spring. The two **Acorn Woodpeckers** at Delta Park also remained. On March 12 Don Wardwell reported two **House Wrens** at Ridgefield NWR. It is thought that they may have wintered in the area. On March 6 Andy Frank saw a **Long-eared Owl** on Sauvie Island.

Kevin Smith reported a male **Costa's Hummingbird** visiting his Aloha feeders February 25. It remained through March. The Troutdale Airport **Wrentit** was reported through the winter. On February 10 Brad Vrilakas spotted it in the Sandy River Delta Park across from the airport. So it is now using both sides of the river.

Migrant **Turkey Vultures** arrived in the Portland area in early February. On February 7 Don Coggsell saw the first on Sauvie Island. On March 4 David Leal saw three **Western Bluebirds** on Sauvie Island. Art Clausing saw six at Powell Butte Park March 7. On April 4 Adrian and Christopher Hinkle found six **Mountain Bluebirds** at Powell Butte. On March 17 Randy Stafford saw a male **Mountain Bluebird** in Scappoose Bottoms. David Mandell spotted one at the Troutdale Airport March 20. John Fitchen saw a **Say's Phoebe** at the Troutdale Airport March 19. Randy Stafford noted one in Scappoose Bottoms March 12.

Migrant **Sandhill Cranes** were reported over the Willamette Valley March 13. The main movement passed February 19 with many sighting over midtown Portland. The **Rufous Hummingbird** migration reached the Portland area by March 11, about a week behind schedule. David Leal reported the first **Osprey** near the Portland Airport March 20. Most arrived March 23. On March 27 Grant Canterbury observed a group of five flying about the mouth of the Clackamas River.

Ravens are getting closer and closer. Not only are they nesting in Forest Park and are regular on Sauvie Island, Craig Tumer saw two February 21 in SW Portland, Linda Leavens saw one March 28 in Oaks Bottom, and one was flying over the Gunderson Steel Mills along NW Front Avenue March 31.

Red-winged Blackbirds, and often **Cowbirds** are regularly seen along with the sparrows. During migratory periods other more unexpected species are occasionally reported.

The best period to check the hedges is from October to May. Unfortunately the entire area is closed during this period and all birding is restricted to right along the Rentenaar Roadway, so most of the outlying area is not well birded.

This winter's **Harris's Sparrow** is not the first be found along Rentenaar Road. On December 27, 1999 one was seen at the end of the hedges at the East Side Checking Station. Seed was again scattered near the hedges and nine

species of sparrows were recorded by March. **Song and Golden-crowned Sparrows** and **Juncos** were again the most common species attracted to the grain. In addition were one **Clay-colored Sparrow**, a **Lincoln's Sparrow**, a **White-throated**, four **White-crowned Sparrows**, and four **Spotted Towhees**.

Although the thousands of **Canada** and **Cackling Geese**, **Snow Geese**, **Sandhill Cranes**, and a good variety of other showy waterfowl are the main attraction to birders visiting the island, other less spectacular species can be found. Check the roadside hedges and along the sloughs and waterways. One never knows where an unexpected species might appear.

Mamie Campbell Award Winners!

by Deanna Sawtelle, Volunteer Coordinator

Mamie Campbell was an important figure in Audubon's early years. A long-time and active volunteer herself, Mamie was instrumental in establishing the Junior Audubon Club in Portland. An ardent conservationist, Mamie helped distribute environmental brochures to area schools in the early 1900s. She was also a tireless leader of the Lucy Club, which organized Portland Audubon Society social and special events and was named after Lucy Audubon (wife of John James Audubon).

The Mamie Campbell Award is the highest honor given to Audubon volunteers, and it recognizes the dedication and service each recipient has tirelessly given. This year, Audubon staff presented this prestigious award to eight deserving volunteers at the Annual Volunteer Banquet.

Jean Baecher Brown quickly became a volunteer who braved the elements every month to help with sanctuary work parties and now mentors new volunteers at each Together Green Day. Jean's tireless enthusiasm and can-do attitude are contagious. As a Sanctuary Committee member, Jean provides the perspective of an active Audubon volunteer and has offered to lead our outreach for the Native Plant Sale. Proving Jean loves Audubon's sanctuary, she shares it with school children as a Sanctuary Tour volunteer. She impresses everyone with her knowledge of Pacific Northwest natural history and her ability to convey that knowledge to Audubon's youngest visitors. Jean is also a member of the Volunteer Council, helping lead our Volunteer Program to new heights.

Pat Crane is a Sanctuary Tour volunteer extraordinaire and consistently demonstrates her passion for sanctuary tours and children. Pat is always positive and flexible and has become a true asset to our Education Department. She's been a tremendous help leading school groups to the Oregon Coast as well. It seems Pat can lead a group of kids through the wet, rainy woods with the greatest of ease and smile the whole way! In addition to Sanctuary Tours, Pat does bird surveys for Conservation, is a member of our Speakers' Bureau and Volunteer Council, and helps with numerous special events like Swift Watch and our "Night Flight" Halloween Event.

Molly Marks has donated over 1,000 hours since she started volunteering in 2007. You'll find Molly in the Nature Store every Tuesday, and the rest of the time she's organizing the Wild Arts Festival Book Fair. When first approached about serving on the WAF committee, Molly said, "Sure, I'll be on the committee, but I don't want to be that involved." Three years later and she's already got a couple years as Book Fair Chairperson under her belt. She spends countless hours lining up authors, coordinating book purchases, and organizing logistics to make the annual event a success. Molly has also become involved with Audubon's Backyard Certification Program with a Gold Certified backyard of her own.

Katy Ehrlich believes in the power of marketing. Since arriving at Audubon several years ago, Katy has challenged us to better promote our good work and has helped us take advantage of opportunities to do just that. Katy serves on Audubon's Board and, as chair of the Development Committee, is leading a new visioning process. Katy is very hands-on while she's at Audubon. She helps the Wildlife Care Center staff rehab many of the nearly 3,000 native injured animals that come in every year, and works with Julio, our Great Horned Owl, and Finnegan, our Peregrine Falcon, in her "spare time" as one of our Education Bird handlers.



Back row (left to right): Gary Gross, Carol Goldberg, Jean Baecher Brown, Wink Gross.
Front row (left to right): Katy Ehrlich, Molly Marks, Jackie Sparks. Not pictured: Pat Crane © Deanna Sawtelle

Carol Goldberg brings her expertise of microbiology to the Wildlife Care Center during her weekly shift. She's affectionately called the "Fecal Queen" because she loves finding parasites and bugs in the fecal material. Carol has enthusiastically trained many Wildlife Care Center volunteers to run lab work and has proven herself to be a great teacher. When asked to help on a committee, we're pleased to say that Carol rarely says "no." She's not only on the Volunteer Council, she's also on the "Night Flight" Halloween Event committee and is helping to plan our newest volunteer event — International Vulture Appreciation Day in September.

Gary Gross started volunteering at Audubon in 2007 with his wife, Carol, and has already donated over 1,100 hours of service. As one of our Education Bird handlers, Gary works with Hazel, our Northern Spotted Owl, and Jack Sparrowhawk, one of our American Kestrels, at both on- and off-grounds events and displays. Gary is a skilled birder and is the "go-to-guy" during his weekly Wildlife Care Center shift to identify the "little brown bird" that just came in for care. You'll find Gary at many of our special events as well, including the Wild Arts Festival, Native Plant Sale, and Swift Watch; and he's on not one, but TWO Birdathon teams! In his spare time, Gary is a glider pilot and has donated a glider ride to the Wildlife Care Center's online auction.

When **Jackie Sparks** retired, she joined a walking group that often led her right past the Audubon Society of Portland. Let's just say that one day in 2007 Jackie hung a left and found herself volunteering. Since then she has become one of our favorite Nature Store volunteers, always greeting visitors with a smile, helping them with merchandise, and answering their questions. Jackie also served as a member of Audubon's Volunteer Council. She says she's "inspired by the passion and dedication of our volunteers" and served on the Council as yet another way to give back to the organization. She did that in between her Wildlife Care Center shift and her Education Bird handling of Hazel, our Northern Spotted Owl, and Jack and Lillie, our two American Kestrels.

Since becoming a Board Member several years ago, **Wink Gross** has worn several hats. He is currently serving his third term as secretary. Wink has served as the primary lead for Audubon's annual Christmas Bird Count by organizing the regional leaders and contributing content to our December newsletter. For the second year in a row, Wink is the behind-the-scenes "face" of the Wild Arts Festival's Facebook page. With all of these contributions throughout the year, Wink still manages to lead morning Bird Song Walks at Pittock Mansion, serves as one of the Wild Turkey Gonzo van drivers and leaders for Birdathon, and does bird surveys on Sauvie Island.

Experience Summer Camps: *The Portland Audubon Way*

Continued from cover

Even if just for one week, parents have the opportunity to give their child one of the most exceptional summer experiences of their life. These unique programs allow parents to build a summer schedule for their child that is safe, educational and, above all, ridiculously fun!

Our camps teach skills and foster awareness that enhance the personal character and growth of each individual participant while allowing them to be part of a community that cares very specifically for the natural world. Each program's theme offers a framework for our professional educators to provide unique and truly powerful opportunities for campers to develop empathy and pattern recognition combined with detailed observation (*Animal Tracking: July 18–22*), become stewards of the land (*Wild in the City: July 5–8*), and develop a sense of place (see any camp!). We have always recognized that within a week's program we have the fantastic opportunity to create a culture of care for each other and the land through teamwork and big belly laughs.

Follow Audubon Summer Camp news, images, videos, and more on facebook.com/audubonkidspdx.

Finally, our community-based Summer Camps, **Explorador** and **Audubon Nature Team (ANT)**, provide opportunities for residents that typically have limited access to environmental education. Explorador is a partnership with **Bienestar**, **Hacienda**, and (new this year) **Rose C.D.C.**, three nonprofit agencies that provide affordable housing and other services to eligible residents. We are thankful for the dedication of our community partners; with their help we offer these camps free of charge. We also are grateful for the funding provided by the **Collins Foundation**, **Clean Water Services**, **PacifiCorp**, and **The North Face**.

When I first started working as an Environmental Educator for the Audubon Society of Portland's Summer Camps, I found myself marveling at the massive array of the program's diversity and depth. With ten years under my belt and a job shift from full-time educator, I am proud to have this opportunity to take the lead as the Summer Camp Director. It is an absolute honor, with this new perspective, to interface in a new way with our

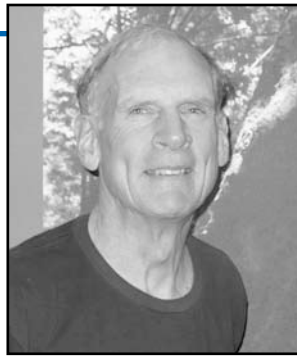

© Ian Abraham

Volunteer of the Month: Jeff Graham

by Ian Abraham, Steve Robertson, and Mary Coolidge

A lifelong native of the Pacific Northwest, **Jeff Graham** has become one of Portland Audubon's most dedicated volunteers. Not only has Jeff been an integral part of our Sanctuary Tour Program, he has given time to many other Audubon Departments as well, taking advantage of our diverse number of volunteer opportunities. In his first year of volunteering, Jeff accrued over 126 volunteer hours participating in programs like Together Green, Swift Watch (as a docent and point count volunteer), and the Wild Arts Festival! In addition to Jeff's work on the Swift Watch team, he has also been an intrepid Chapman Roost Monitor for the past 4 seasons. That means he occasionally takes off his swift headband and sits down on the Chapman hill to help actually count the birds overnighing in the chimney. This job is not for the faint of heart. It means watching closely to estimate an ever-changing rate of entry, operating a stopwatch, and doing some brain-bending math at the end of the spectacle, long after the crowd has thinned. This important information is helping researchers determine range-wide Vaux's Swift population trends. Jeff has also recently adopted the massive Great Blue Heron Rookery at Smith & Bybee Wetlands, and is monitoring it both on foot and by kayak as part of Audubon's effort to track rookery fluctuations around the metropolitan region.

After retiring from 35 years of teaching middle school in Washington, Jeff has become a real asset to our Sanctuary Tour Program, and his enthusiasm for guiding students through our Wildlife Sanctuary is contagious. His dedication not only comes from his life experience as a teacher, but from the joy that he draws from "the kids' smiles and the energy that comes from building their connection with nature."

Jeff attributes his commitment to the Audubon Society of Portland to the "endless amount of learning opportunities and the diverse set of programs Audubon offers" — but the truth is that we could all learn from his commitment. The challenge for us in the Education Department will be in keeping Jeff and his talents all to ourselves and the Sanctuary Tour Program!

Thank you, Jeff, for all of the hours you have given Portland Audubon and for your enduring positive attitude and cheering smile!

Sharing is Good!

Join the Conversation in Audubon's Online Community

Portland Audubon's online community is growing: Over 2,700 "like" us on Facebook, 700 are following our Twitter feed, and 6,000 subscribe to our newsletter, the BirdWord. We share things important to birders, bird enthusiasts, nature lovers, and conservationists with immediacy.

"Like" us on **Facebook.com/PortlandAudubon**, and you'll get the latest conservation issues, trips, and events. You'll also hear about the latest patients admitted to our Wildlife Care Center and find out when our next public release will be — returning the healthy animal back to the wild. New this year: the KGW-Audubon Raptor Cam fan page at [Facebook.com/raptorcam](https://facebook.com/raptorcam).

"Follow" us on **Twitter.com/PortlandAudubon** to get our latest "tweets" (perfect for our Audubon, isn't it?) for shorter, succinct tidbits of information.

The optimum word here is "share." We like hearing from you and knowing what matters to you, what you care about, what you're thinking. We like seeing your photos and videos, and hearing your stories — it's all good!

Let's TWEET this Birdathon!

Birdathon is another great community. Over the years, it has grown to be one of the largest, most successful Birdathons in the nation. This year, we'd like to invite all Birdathoners with a smart phone and a connection to post and tweet their sightings and tips while they're out in the field. Let us know what you're seeing and where, and those of us at home or in the field can follow your lead. It's another tool in the quest to find that elusive species!

You can easily connect with Audubon virtually by clicking on the icons on the left side of our home page (audubonportland.org).

New Online Shopping Partners

Do you like the convenience of shopping online? How about a good deal? How about both? Portland Audubon is proud to announce two new partnerships to help raise funds to protect wildlife and wild places while you shop online.

CafeGive is an online shopping site that gives back. Shop at 300+ great stores and earn for Audubon Society of Portland — your purchase will protect wildlife and habitats! To participate, register at cafegive.com/?cause=audubon-society-portland and become an advocate for Portland Audubon by choosing us as your cause. Once you do, a percentage of every purchase you make through CafeGive is donated to Portland Audubon.



CauseOn offers daily email deals that you can sign up to receive.

CauseOn harnesses the power of group buying and social media to bring participants one huge discount deal every day from a carefully selected mix of dining establishments, spas, activities, adventures, and more. And, 20% of the sale goes to support our organization when choose Portland Audubon as your cause. It's easy, just sign up at causeon.com/Portland/?sc=90.



If you love to shop, if you love a great deal, and if you love birds, wildlife, and habitat, these are great ways to feed two birds with one seed!

Summer Camps as we continue to **inspire kids to love and protect nature** the Audubon Way.

Although I won't be able to spend as much time in the field teaching and leading these programs (except for the *San Juan Island Adventure*, High School version), I have the opportunity to support our phenomenal staff of Environmental Educators, College Interns, and High School Counselors as they work their tails off connecting our first grade through high school-aged Audubon campers to the natural world we call home. **Let's go play!**

To register, please go to audubonportland.org/trips-classes-camps/camps/summer — or call 971-222-6127. See the **Summer Camp insert** included with this *Warbler* for details and up-to-date camp openings.

Welcome, New Members!

Portland Audubon is a force in conservation thanks to its strength in membership, standing together since 1902. We appreciate each and every one of our members and celebrate our membership by welcoming our new members in each *Warbler* issue. Thank you for joining our vibrant and growing community!

- | | | |
|----------------------------------|-----------------------------------|--------------------------------|
| Jim & Margie Adams | David Geddes | Mutterspaugh |
| Lucinda Agre | Daniel Gibbs | Esme Wolf Nadeau |
| Brenda Aguirre | Julie Gienger | Troy Nelson |
| Diane & Carlos | Rachel Greben | Kat Nesbit |
| Alcibar | Jennifer Grover | Andrew & Janice Ness |
| Edna Alvarez | Yael Grundstein | Sylvia Nesson |
| Aaron Annis | Linda Guthrie | Nancy Nielsen |
| Stephen & Elizabeth Arch | Carrie Haddad | Mary Nolen & Brian Sullivan |
| Barbara Bagg | Joel & Candace Hale | Jeff & Donna Nordstrom |
| Lesley Balla | Stephen Hamann | Malena Ortiz |
| Dan & Carolyn Barker | Laurene Hampton | Doris Paisley |
| Karen & Anthony Barnack | James & Dawnde Hankel | Alvaro Pardo |
| Michele & Berkeley Barnett | Justin & Alysia Hart | Tim Parker |
| Kat Barnum | Kathryn Hart | Ingrid Pawlowski |
| Lester & Heather Baskin | Morgan Harvey | George Perry |
| Dana & Fil Batol | Jennifer & Robert Hendrickson | Virginia Plov |
| Hal Beeler | Ann & Bob Hessell | Maggie Post |
| John & Sita Belbute | Kristopher Hiderbrand | Kristin Potter |
| Belinda Beresford | Deb Hill | Michael Prince |
| Thyra Bessette | Sara Hoerber | Kristina Prosser |
| Skyra Beveridge | Alexis Hoffberger | Joe Recker |
| Barbara Biedrzycki & Reed Wagner | Tom & Cynthia Hofmann | Ray Redburn |
| Samuel & Adriane Blackman | Jeffrey Holman | Kayla, David & Lila Reich |
| Caroline Blanchard | Victoria Holzendorf | Lucille Rogers |
| Michael Bobst | Stasia Honnold | Mary Rosencrans |
| Lara Braithwaite | Amber Howard | Karen Rossi |
| Cynthia Brandt | Dana Howard | Craig Rowland & Marilet Zablan |
| Susan Brown | Steven Hunt | Maggie Rudy |
| Heather Bunner | Rosemary Huston | Alex Russel |
| Della & Fred Burckhardt | Cheryl Ikemiya & Alden Bagnall | Sydney Schick |
| Gaby Burkard | Tiffany & Craig Jackson | Annie Scriven |
| Michael Butcher & Joe Holm | Heather James & Josh Gibby | Nancy & Kevin Senn |
| Mark Byrne | Josh Gibby | Kenneth Sewell & Mary Alvarez |
| Kristin & Steven Calvert | Fran Johnson | Ava Siciliano |
| Kay Campbell | Mary Kallenberg & Robert Hartzler | Andrea Slatky |
| James Castle | Shari Katz | Steven & Jennifer Smith |
| Christina Catania & Barrett | Janice Kell | Neilan Snowden |
| Baumgart | Yonathan Kifle | Don Spencer |
| George Celia | Chris Kiilsgaard | Chris Stevenson |
| Brooke Chamberlain | Evelyn Kim | Gloria Stokes |
| Barbara Chappell | Amanda Klehr | Zach Strever |
| David Chin | Sabrina Korpela | Barry & Melissa Taylor |
| Sarah Cloud & Andrea Wolff | Teresa Kralj | Wendy Temko |
| Mary Jo Cook | Christie Kraushaar | Eric & Phyllis Thompson |
| April Coppini | Yoko Krueger | Chellie LaPointe |
| Gene Danenhower | Chellie LaPointe | The Legras-Armenti Family |
| Alexis Davis | Angie Lehnert | Angie Lehnert |
| Camilla Davis | Roger & Catherine Leverette | Betsy Lhuillier |
| Kathy Dawson | Marilyn Lindner | Isabel Lira |
| Julia DeArmond | Isabel Lira | Russell Littlefield |
| Austin DeLapp | Russell Littlefield | Mary Lugg |
| Alida Dettmann | Mary Lugg | Glenda Martin |
| Cassi Dewing | Glenda Martin | Kristin McClure |
| Katherine Dodson | Kristin McClure | Jennifer McDonald |
| Ella Douthit | Jennifer McDonald | Deb McFarlan |
| Robyn Draheim | Deb McFarlan | J. Fain McGough |
| Summer Elasady | J. Fain McGough | Anita McKey |
| Susan Evans | Anita McKey | James McKillop |
| Brandi Faries | James McKillop | Mary McMurray |
| Michael Brian Fennerty | Mary McMurray | Scott Milham |
| Christie & Sean Fletcher | Scott Milham | Janet Miller |
| Vajra Foreman | Janet Miller | Taleia Monty |
| David & Lynda Freeman | Taleia Monty | Tim Morrison |
| Ann Fulton | Tim Morrison | Sue Moynihan |
| | Sue Moynihan | Tom & Jennifer Muller |
| | Tom & Jennifer Muller | Melissa |

If you would like to join us or have any questions about membership, please contact Catherine at chalpin@audubonportland.org or 503-292-6855.

Important Bird Area of the Month

by Mary Coolidge, Assistant Conservation Director

Table Rocks

Two volcanic mesas in Southwestern Oregon, **Upper and Lower Table Rocks** are as rich in geologic and cultural history as they are in present-day species diversity. These rocks are reminders of Miocene-era lava that flowed down the meandering ancestral Rogue River canyon over 7 million years ago. The surrounding sandstone has since been eroded by the Rogue River, a steady workhorse that left these two basalt caps to stand 800 feet out of the valley below.

For 15,000 years, this area was occupied by the Takelma Indians, the Native peoples of the Upper Rogue River Valley. They referred to Table Rocks as Di'tani (Rock Above) and Titanakh (Little Indian Plums). It is easy to see why they relied on the natural abundance of this area, which today hosts over 70 species of animals and 340 species of plants, 200 of which contribute to the astonishing wildflower displays of April, May, and June. Concerned about development of these islands of biodiversity, the Nature Conservancy (TNC) began its conservation of Lower Table Rock in 1978 with a purchase of 1,881 acres. In 2008, they acquired an additional 1,710 acres. Today, a combined 4,800 acres on and around Upper and Lower Table Rocks are owned and managed by TNC and the Bureau of Land Management (BLM), which has designated much of its acreage here as Areas of Critical Environmental Concern.

Table Rocks is both an Important Bird Area (IBA) and a Conservation Opportunity Area highlighted in



Columnar basalt at Table Rocks. Photo: BLM



Blue-gray Gnatcatcher © Michael Liskay

Oregon Department of Fish and Wildlife's (ODFW) Conservation Strategy. This IBA supports a remarkable species diversity, 20 of which are imperiled: this includes 5 ODFW Conservation Strategy bird species (**Western Meadowlark, Streaked Horned Lark, Grasshopper Sparrow, Lewis's Woodpecker, and Blue-gray Gnatcatcher**), the vernal pool fairy shrimp, and 13 plant species including dwarf woolly meadowfoam, large-flowered woolly meadowfoam, and Gentner's fritillaria.

Four ecological regions occur on Table Rocks: **Oak Savanna**, characterized by open grassland spotted with oaks; **Chaparral**, dry shrubland characterized by Manzanita, buckbrush, and Gentner's fritillaria; **Mixed Woodlands** of Black oak, Douglas-fir, Pacific madrone, and incense cedar; and **Mounded Prairie** atop the mesas, which describes a mosaic of grasses, wildflowers, and vernal ponds.

TNC and BLM are working to control invasive species, evaluate fire cycles, and facilitate both recreational and cultural activities. Native species of birds, bats, plants, and butterflies are all closely monitored.

Ornithological Significance

Table Rocks IBA provides valuable habitat for three bird species at the northern extent of their range: **Oak Titmouse, Blue-gray Gnatcatcher, and California Towhee**. At a time when breeding bird data shows that our songbird species are in decline, it is important to preserve places on which migratory birds depend. Climate change and its potential impact on current habitat arrays makes protection of land at birds' current range limits especially critical.

In addition to the imperiled bird species listed above, birds of interest that have been found in the Table Rocks habitat mosaic include: **Acorn Woodpecker, Band-tailed Pigeon, Olive-sided Flycatcher, Oregon Vesper Sparrow, Peregrine Falcon, Pileated Woodpecker, Western Bluebird, Willow Flycatcher, and White-breasted Nuthatch. Turkey Vulture and Rock Wren** can also be expected.

If you go:

Table Rocks are open all year. Upper Table Rock is an easy 2.8 mile trip (720' elevation gain). Lower Table Rock is a moderate 5.4 mile hike (780' elevation gain).

From I-5 in Jackson County, SW Oregon, take the Central Point Exit (exit 33, just north of Medford) and drive east on Biddle Rd for 1 mile. Turn left on Table Rock Rd and continue for 5.2 miles to a curve. Turn right on Modoc Rd for 1.5 miles to the Upper Table Rock trailhead parking lot on the left, just opposite an electric substation.

To get to the Lower Table Rock trailhead from here, drive 1.5 miles back to Table Rock Rd, turn right (away from Medford) to milepost 10, and then turn left on Wheeler Rd in 0.8 mile.

Be mindful of poison oak, rattlesnakes, ticks, and steep cliffs. Dogs, horses, fires, and flower-picking are banned on Table Rocks.

Bird Song Walks 2011

7 a.m. Monday – Friday: **FREE!**

Portland Audubon is sponsoring another season of weekday-morning Bird Song Walks. From beginners to advanced birders, anyone who is fascinated by the sounds of birds should take advantage of these volunteer-guided walks to the metro area's prime spring migration hotspots.

For directions and further details, visit audubonportland.org/trips-classes-camps/adult/birdsong-walks or see page 3 of our March/April 2011 newsletter.

All walks begin at 7 a.m. No pre-registration is required, and you leave whenever you like. Take the bus if available — go to trimet.org or call 503-238-RIDE (7433) for route information. Also see *Wild in the City: A Guide to Portland's Natural Areas*, available at Portland Audubon's Nature Store, or visit the website listed for each locale.

MONDAYS May 2-9-16-23-30

Tryon Creek State Park

Leaders: Rick and Stephanie Wagner

Meet at the Nature Center. For more information about Tryon Creek State Park, visit tryonfriends.org.

TUESDAYS May 3-10-17-24-31

Cooper Mountain Nature Park

Leader: Bonnie Deneke

For more information, visit thprd.org/facilities/coopermountain.

WEDNESDAYS May 4-11-18-25

Mt. Tabor

Leader: Gerard Lillie

For more information on this and other Portland Parks, visit portlandonline.com/parks.

THURSDAYS May 5-12-19-26

The Nature Conservancy's Camassia Natural Area

Leader: Paul Sullivan

For more information on this and other Nature Conservancy preserves, visit nature.org/wherework/northamerica/states/oregon/preserves.

FRIDAYS May 6-13-20-27

Pittock Mansion

Leader: Wink Gross

For more information, visit pittockmansion.org.

Members Receive a Discount at the Nature Store!

Audubon Society of Portland's Nature Store is the headquarters for naturalists in the Portland-Vancouver metro area. We feature nature books, hiking & field guides, birding software, CDs, DVDs, binoculars and spotting scopes, bird feeders and seed, plus gifts & toys for adults & children, all with a nature theme. **Portland Audubon members receive a 10% discount off regular prices.**

Fly on over to the Audubon Nature Store to see our great selection of Mother's Day & Father's Day gifts for Nature Lovers!

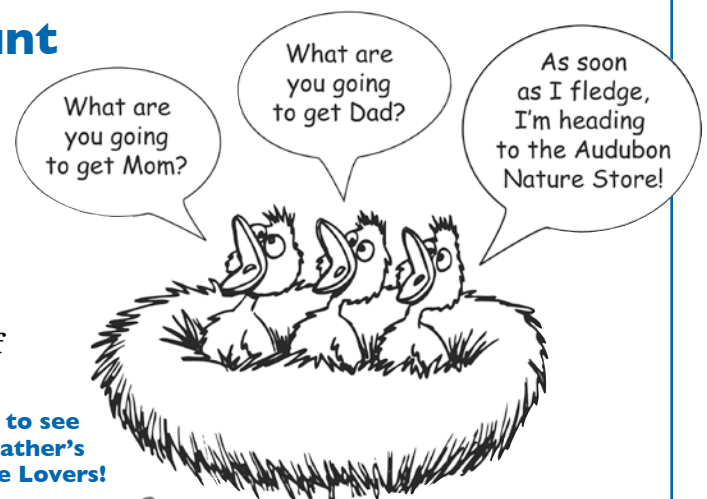

Free Sighting Scope & Digiscoping Workshop

Presented by Jim Danzenbaker and Joshua Lazenby of Kowa Sports Optics

Saturday, June 11 — 10am–Noon
Heron Hall at the Audubon Wildlife Sanctuary

So you have a digital camera and you have a spotting scope and now you want to begin digiscoping but don't know how to start? Or you're hoping to expand your knowledge before a major purchase? We'll discuss scope selection based on fixed vs. zoom eyepieces, high-density fluorite glass, focus features, lens size, and more. Then our workshop will move on to the basics of digiscoping with point-and-shoot cameras as well as SLRs. We'll talk about vignette reduction, Kowa camera adapters, and

camera settings. We'll spend about 45 minutes indoors and then, weather permitting, we'll move outside and start practicing what we've learned.

Interested in registering for this free special event?

If so, please send an email to Nancy at nmattson@audubonportland.org. That will allow us to email you some additional information just prior to the workshop. Or call the Nature Store at 503-292-9453 to register.



Kowa TSN-883

PORTLAND AUDUBON'S NATURE STORE

5151 NW Cornell Road • Portland, OR 97210
503-292-9453 • store@audubonportland.org

Open 10am–6pm Monday through Saturday
10am–5pm Sunday

15th Annual Native Plant Sale! continued from front cover

Our team of plant talkers can help you use your answers to these questions to select the plants that will be best for your individual situation.

If you want to learn more and come up with a more comprehensive plan, the Portland Audubon Nature Store stocks a wonderful collection of books on native plants, wildlife, and naturoscaping. Some standout selections include Russell Link's *Landscaping for Wildlife in the Pacific Northwest*, a great introductory text for those new to naturoscaping. *The Encyclopedia of Northwest Native Plants for Gardens and Landscapes* by Kathleen Robson, Alice Richter, and Marianne Filbert provides comprehensive information on the flora of our region. For those who really want to explore the complex ecological systems that native plant communities support, I recommend Douglas Talley's *Bringing Nature Home: How You Can Sustain Wildlife with Native Plants*.

Native plants are the cornerstone of a sustainable landscape — they are adapted to grow in our soils and

climate, require less care than exotic ornamentals, and allow for natural ecological function in the landscaped environment. And of course native and migratory birds and other wildlife rely on native plants and the habitat that they provide. A key strategy in the struggle to maintain and restore healthy wildlife populations in the Portland metro area is the restoration of native plant communities on private residential land. Each plant makes a difference.

Additionally, your purchases at our 15th Annual Native Plant Sale directly benefit the Audubon Society of Portland's wildlife sanctuaries and our trail and habitat restoration efforts. Anyone who has taken a walk on our trails in the past few months may have noticed that many of our trails are in need of repair. We have made some progress but need significantly more gravel and wood to make the needed repairs. Our fundraising efforts this year are being directed to our trail projects to help ensure that the trails remain passable and enjoyable to all of the school groups and visitors who visit our sanctuaries. Your plant purchase will contribute to this effort.

Festival of the Birds

Saturday, May 7th, 9am–3pm
Sellwood Park in SE Portland — Free!

Join Audubon Society of Portland, U.S. Fish and Wildlife Service, and the City of Portland for a celebration of migratory birds.

Oaks Bottom and other natural areas in Portland are important to migrating birds for nesting, wintering, resting, and re-fueling. Come learn about and celebrate our local birds at Oaks Bottom, the City of Portland's first designated Migratory Bird Park.

This is a free festival for the whole family to celebrate International Migratory Bird Day. No registration is required except for the Early Bird walk.

Early Bird Walk at 7:30am — registration required at 503-823-2525 or www.portlandparks.org (class #345264).

Free Guided Bird Walks, 9am–2pm, led by local naturalists.

Children's Activities! Storytelling and live music by local storytellers and musicians.



Four of Audubon's Education Birds at Festival of the Birds © Bob Sallinger

Education Birds from Portland Audubon's Wildlife Care Center.

Interactive Displays: Find out about our amazing local birdlife and what is happening locally to protect and enhance our bird populations.

For more information go to www.portlandparks.org.

**SAVE
THE
DATE**

**November 19–20, 2011
(Sat–Sun)
Montgomery Park**

Wild Arts Festival Planning in Full Swing!

It may seem like Fall is a long way off, but preparations for the 2011 Wild Art Festival are well under way. This year, Wild Arts will again take place the weekend before Thanksgiving — Saturday and Sunday, November 19 and 20 — and it will return to Montgomery Park.



© Susan Bexton

Artists' applications are all in, and jurying for the **Art Fair** will be completed by May 25. Meanwhile, invitations to the **Book Fair** are going out, and Festival organizers are expecting another fabulous lineup of both artists and authors.

The **6x6 Wild Art Project** will be a feature again this year. Our goal is to have 200 affordable 6-by-6-inch canvases — by famous, almost famous, and soon-to-be-famous artists — available at the Festival. If you would like to hang your own work in the 6x6 show, canvases will be available beginning in September.

Finally, our Wild Arts Festival **Silent Auction** team is ready and willing to accept donations for the 2011 auction. For information on donating, or for answers to other questions about the Festival, check wildartsfestival.org. And while you're online, why not become a fan on the Wild Arts Festival Facebook page.

Most important, mark the 2011 Wild Arts Festival dates — November 19 and 20 — on your calendar... you don't want to miss it!

The Audubon Society of Portland is a member of Earth Share of Oregon. For more information, contact Earth Share of Oregon at 503-223-9015 or on the web at www.earthshare-oregon.org.



Audubon Society of Portland

Inspiring people to love and protect nature since 1902

Audubon Society of Portland promotes the enjoyment, understanding, and protection of native birds and other wildlife and their habitats. We focus on our local community and the Pacific Northwest.

ADMINISTRATION OFFICES

5151 NW Cornell Rd • Portland, OR 97210
503-292-6855 • Fax: 503-292-1021
9am to 5pm, Mon. - Fri.

SANCTUARIES

Dawn to dusk every day

NATURE STORE

503-292-9453
10am to 6pm, Mon. - Sat. • 10am to 5pm on Sunday

INTERPRETIVE CENTER & LIBRARY

Same hours as store

WILDLIFE CARE CENTER

503-292-0304
9am to 5pm every day

RARE BIRD ALERT

503-292-6855 • www.audubonportland.org

Board Officers

President..... Josh Cerra
Vice President John Fitchen
Secretary Wink Gross
Treasurer Candy Plant
Past President Pat Campbell

Board Members

Tony DeFalco	Koto Kishida	Dan Rohlf
Katy Ehrlich	Bob Liddell	Lee Savinar
Kristina Gifford	David Mandell	Ron Spencer
John Hammerstad	Noelwah Netusil	Julie Wilson
Barb Hill	Karen O'Connor Kruse	

Board Member Emeritus - Dave Marshall

Committee Chairs

Board Affairs Josh Cerra
Conservation Lynn Herring
Education Karen O'Connor Kruse
Executive Pat Campbell
Finance Candy Plant
Membership & Development Katy Ehrlich
Sanctuaries Ann Littlewood
Volunteer Council Jill Nelson-DeBord

Staff

Executive Director Meryl Redisch
Office Manager Tammi Miller
Development Director Ann Takamoto
Bookkeeper Jill Hartzell
Birdathon Coordinator Gary Slone
Membership Development Coordinator Catherine Halpin
Membership Assistant Pam Meyers
Education Director Steve Robertson
Adult Education Manager Steve Engel
Camp Director/Onsite Programs Specialist Ian Abraham
Master Birder/Adult Trip Coordinator Dan van den Broek
Environmental Educator Tim Donner
Environmental Educator Andrea Constance
Urban Naturalist Mike Houck
Conservation Director Bob Sallinger
Assistant Conservation Director Mary Coolidge
Urban Conservationist Jim Labbe
Urban Wildlife Specialist Ariana Scipioni
Ten Mile Sanctuary Manager Paul Engelmeyer
Volunteer Coordinator Deanna Sawtelle
Wildlife Care Center Operations Manager Debbie Daniels
Wildlife Care Center Veterinarian Deb Sheaffer
Nature Store Manager Nancy Mattson
Nature Store Assistant Marilyn O'Grady
Nature Store Clerk Sally Loomis
Sanctuaries Director Tom Costello
Sanctuaries Assistant Greg Kurtz
Sanctuaries Maintenance Assistant Rick Meyers
Backyard Habitat Certification Technician Robin Jensen
East Portland Community Coordinator Bich Trinh

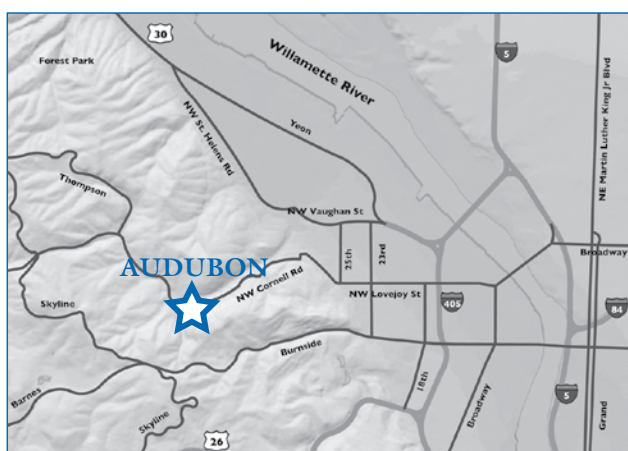

BUSINESS MEMBERS

Through their business practices and financial contributions, the following business members help Audubon Society of Portland fulfill its mission. If you would like to become a business member, please contact our Development Department at 971-222-6117.

Business Benefactor
NW Natural

Business Guarantors
Backyard Bird Shop
Portland General Electric

Business Partners
Barran Liebman, LLP
Columbia Sportswear
Forest Park Federal Credit Union
NatureBake & Dave's Killer Bread

Business Supporters
Enterprise Rent-A-Car
Leupold & Stevens, Inc.
Portland Audubon Nature Store

Business Friends
Bob's Red Mill
Bob Gandolfi Event Production
Elk Cove Vineyards
Jackson Welch Mediation/
Arbitration PLLC
Kennedy/Jenks Consultants, Inc.
Kruger's Farm Market
NePo Suet Company
Vernier Software & Technology



NW Natural

www.nwnatural.com



*Everything for the
Wild Bird Enthusiast*

Seven locations in
Portland and Vancouver
503-635-2044
www.backyardbirdshop.com

